



# INSTALLATION MANUAL

VENDING

## ***KoolVend* REFRIGERATED VENDING MACHINE**

Models:

KM-VMR-30-B, KM-VMR-30-BR, KM-VMR-40-B, KM-VMR-40-BR

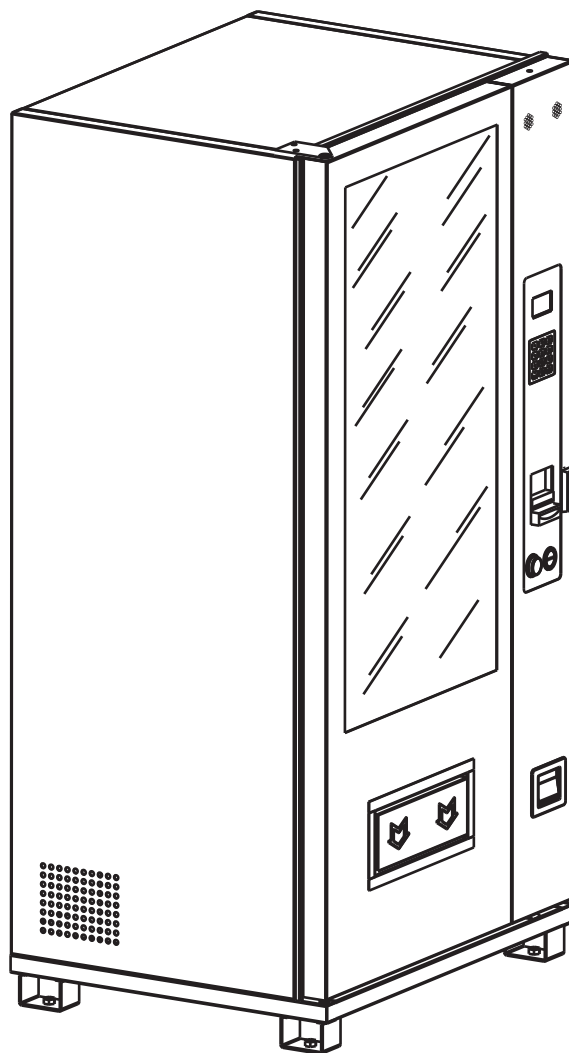

***Before using, please read the operating instructions carefully to ensure proper application and achieve satisfactory results.***

***For any service-related Issues, please contact  
us: Phone Number: 718-576-6342  
Email address: support@koolmore.com***

# ***Stay informed with the latest information for your KoolMore vending machine.***

Scan the QR code above to access the most recent user manual on our website, which is constantly being updated and improved.

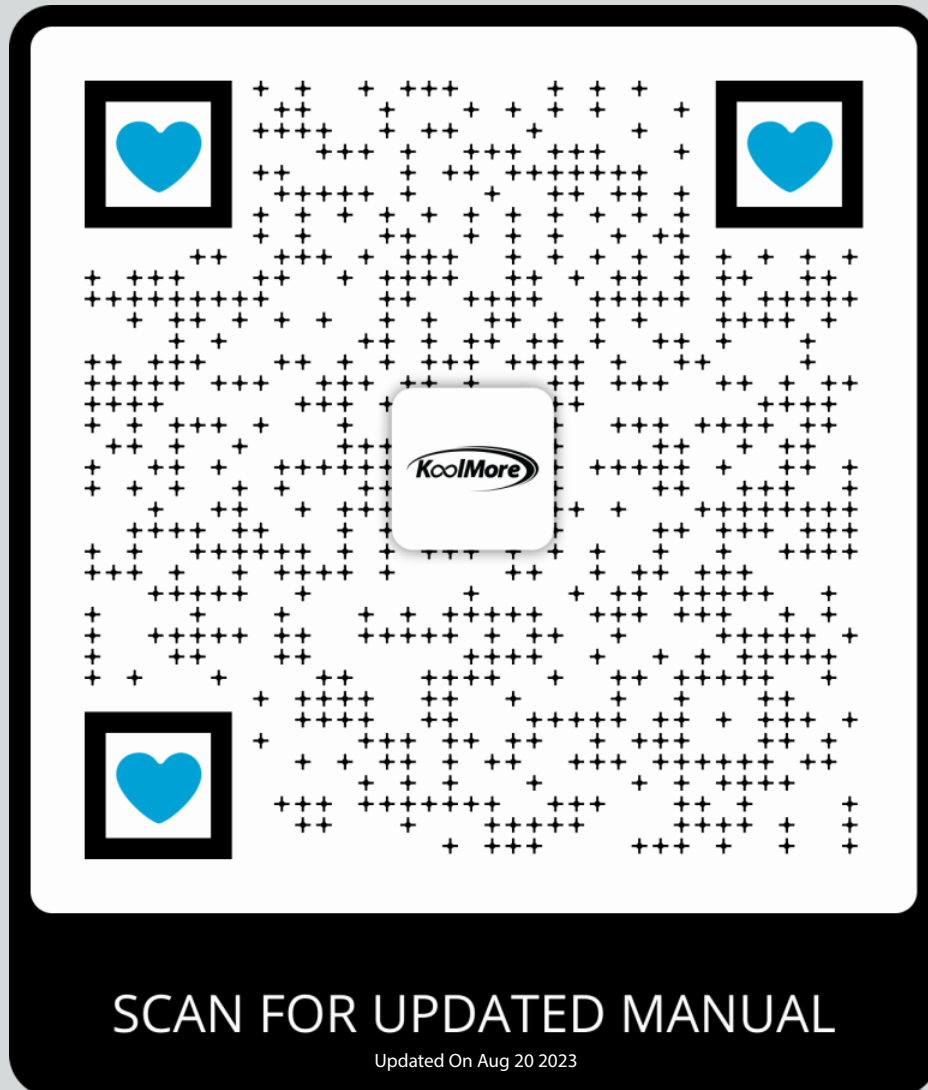

**If you need any assistance or have questions, our customer support team is here to help.**

# TABLE OF CONTENT

CONTENT	PAGE
NAYAX CREDIT CARD READER ONBOARDING	1
VENDING MACHINE APPEARANCE DISPLAY	2 - 3
VENDING MACHINE INTERNAL APPEARANCE DISPLAY	4
VENDING MACHINE SAFETY PRECAUTIONS	5
VENDING MACHINE COMPONENTS FUNCTIONS INTRODUCTION	6
MENU SETUP FLOWCHART: ITEM LOADING & CLEAR SLOT ERROR	7
MENU SETUP FLOWCHART: TOTAL SALES	8
MENU SETUP FLOWCHART: ITEM LOADING & CASH PREFILL	9
MENU SETUP FLOWCHART: EMPTY NOTE & SET PRICE	10
MENU SETUP FLOWCHART: SET PRICE & SET CAPACITY	11
MENU SETUP FLOWCHART: SET VMC DROP SENSOR	12
MENU SETUP FLOWCHART: SET SLOT DROP SENSOR	13
MENU SETUP FLOWCHART: DROP SENSOR SELF-CHECK	14
MENU SETUP FLOWCHART: SET SLOT MODE	15
MENU SETUP FLOWCHART: MERGE SLOT	16
MENU SETUP FLOWCHART: SPLIT SLOT	17
MENU SETUP FLOWCHART: SET SLOT LAYOUT	18
MENU SETUP FLOWCHART: SET TEMPERATURE MODE / TARGET	19
MENU SETUP FLOWCHART: SET DEFROST TIME/INTERVAL & SET GLASS HEAT	20
MENU SETUP FLOWCHART: SET LED LIGHT & SALES PER SLOT	21
MENU SETUP FLOWCHART: CHECK STATISTICS OF EACH PAY TYPE	22
MENU SETUP FLOWCHART: DELETE SALES DATA	23
MENU SETUP FLOWCHART: SET COIN CHANGE	24
MENU SETUP FLOWCHART: ENABLE COIN DENOMINATIONS	25
MENU SETUP FLOWCHART: SET BILL ESCROW ON/OFF	26
MENU SETUP FLOWCHART: SET COIN CHANGE	27
MENU SETUP FLOWCHART: EMPTY BILL RECYCLE	28
MENU SETUP FLOWCHART: SET IC CARD READER	29
MENU SETUP FLOWCHART: SET POS DEVICE	30
MENU SETUP FLOWCHART: SET MAX. CREDIT	31
MENU SETUP FLOWCHART: SET AUTO CHANGE DISPENSING	32
MENU SETUP FLOWCHART: SET COIN EXCHANGE WITHOUT SALE	33
MENU SETUP FLOWCHART: SET LOW CHANGE	34
MENU SETUP FLOWCHART: AUTO CLEAR BALANCE SET UPON TIMEOUT	35
MENU SETUP FLOWCHART: SET MULTIPLE VEND ON/OFF	36
MENU SETUP FLOWCHART: SET MULTIPLE VEND QTY LIMIT	37
MENU SETUP FLOWCHART: SET PICKUP CODE	38
MENU SETUP FLOWCHART: INQUIRY SERVER FREQUENCY	39
MENU SETUP FLOWCHART: NETWORK DIAGNOSE	40
MENU SETUP FLOWCHART: SET AUDIO GUIDANCE	41
MENU SETUP FLOWCHART: SET WIFI HOTSPOT	42
MENU SETUP FLOWCHART: RESET MODEM WIFI HOTSPOT PASSWORD	43
MENU SETUP FLOWCHART: SET DISPLAY LANGUAGE	44
MENU SETUP FLOWCHART: RESET ADMIN PASSWORD	45
MENU SETUP FLOWCHART: ABOUT THE MACHINE	46
TROUBLESHOOTING	47-48
CLEANING INSPECTION TIME AND CONTENT	49
REFRIGERATION SYSTEM CLEANING & D-TYPE REFRIGERATOR CLEANING	50
MERGED CARGO LANE OPERATION & ADJUSTMENT OF LAYER HEIGHT	51
ACCESSORIES INSTALLATION INSTRUCTIONS	52
WARRANTY	53

# NAYAX CREDIT CARD READER ONBOARDING



Your KoolVend vending machine comes equipped with a Nayax Credit Card Reader, providing a convenient way to accept card payments.

**To begin the registration and onboarding process with Nayax, follow these simple steps:**

- 1. Locate Your Serial Number (ID #):** You can find the serial number on the Nayax device screen. Alternatively, the serial number is also located on the back of the device.

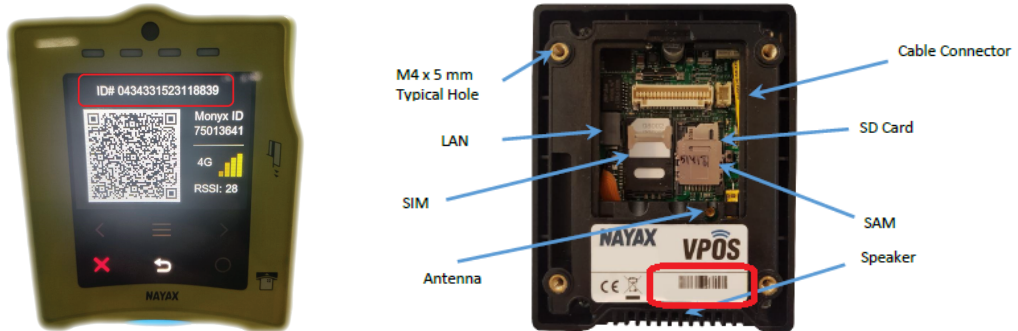

- 2. Access the Onboarding Form:** Scan the QR code below with your smartphone's camera or QR code reader app. This will take you directly to the "NAYAX ONBOARDING FORM" within the KoolMore website.

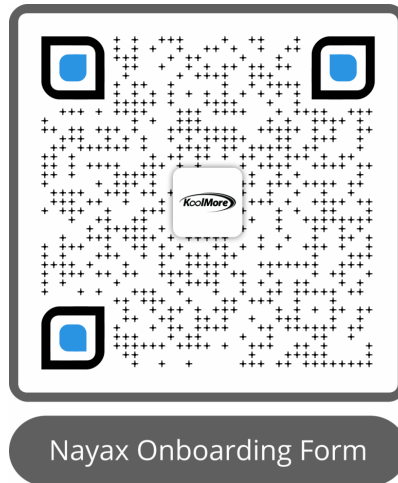

- 3. Complete and Submit the Form:** Fill in the required fields, including your company name, phone number, email address, and the serial number of the Nayax Credit Card Reader, then submit the form. The Nayax onboarding team will receive your information.
- 4. Wait for Contact:** A representative from Nayax will contact you to guide you through the setup process.
- 5. Start Accepting Card Payments:** With the credit card reader set up, you can begin accepting credit card payments through your KoolMore vending machine.

For assistance or further questions, please don't hesitate to reach out to our customer service team. We're here to ensure your vending machine experience is as seamless as possible.

# VENDING MACHINE APPEARANCE DISPLAY

## Refrigerated Machine External Display

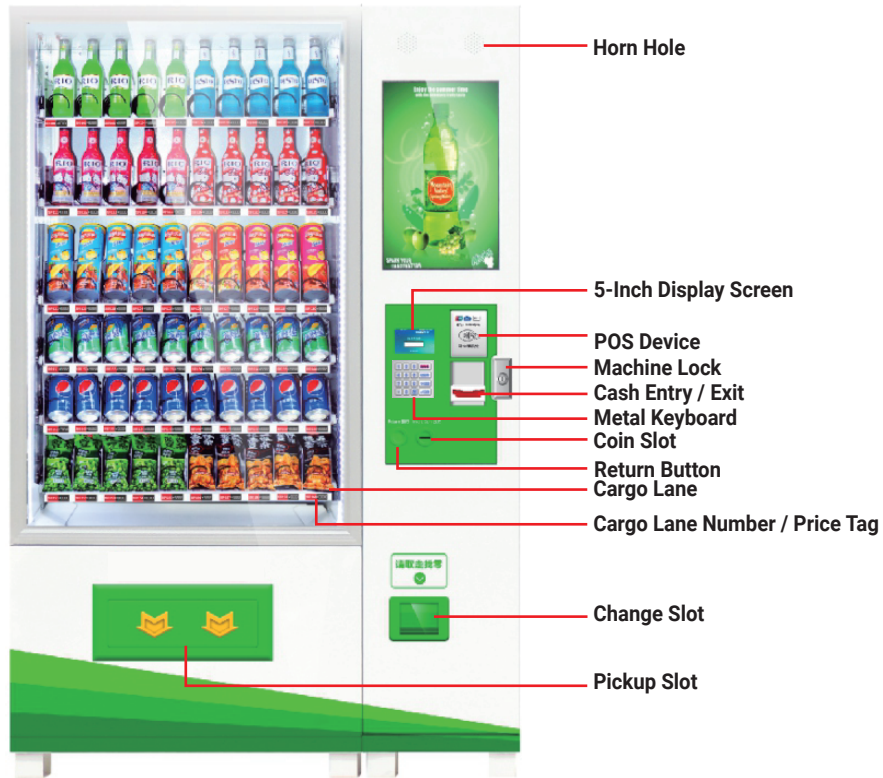

## Non-Refrigerated Machine External Display



The picture is for reference only. If the picture does not match the actual machine, please refer to the actual machine!

# VENDING MACHINE INTERNAL APPEARANCE DISPLAY

## Refrigerated Machine Internal Display

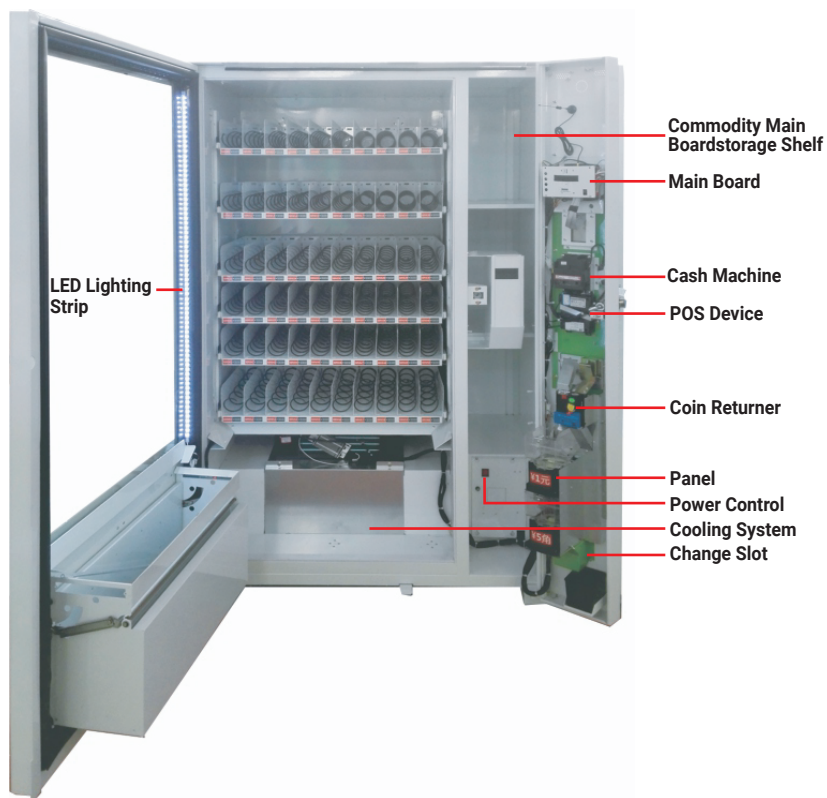

## Non-Refrigerated Machine Internal Display

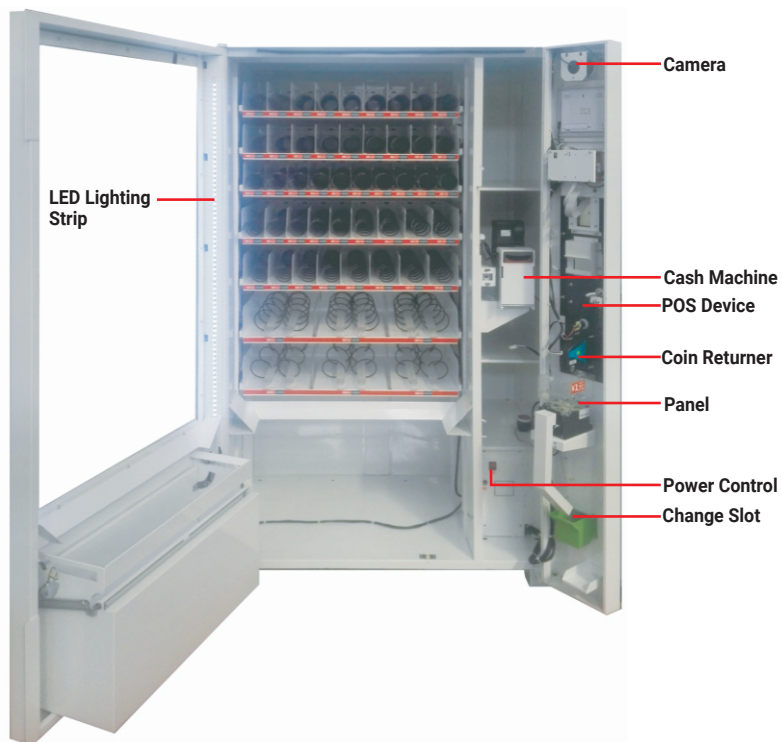

The picture is for reference only. If the picture does not match the actual machine, please refer to the actual machine!

# VENDING MACHINE USE PREPARATION AND PLACEMENT ENVIRONMENT

1. Upon receiving the machine, carefully inspect the packaging for any signs of damage. If any damage is found, please contact the logistics provider and our company directly for assistance.
2. Before using the machine, remove all packaging components such as wood boards, protective films, foam, and cable tie.
3. Choose an appropriate location for placing the machine, considering the following factors:
  - The placement area should be dry, well-ventilated, and away from sources of heat.
  - Ensure the machine is protected from rain or water splashes.
  - Avoid placing the machine in areas with low temperatures that may affect its operation.
  - Select a solid and stable ground surface for proper support.
  - Leave a clearance of at least 7.8 inch from the wall for ventilation.
4. After placing the machine, allow it to stand for a minimum of 30 minutes before powering it on. This ensures the machine's stability and proper operation. If cooling functionality is required, allow the machine to stand for 4-5 hours before turning on the cooling feature to prevent any adverse effects on the compressor. The machine has a normal power consumption of 60W, a maximum cooling power of 510W, and a maximum heating power of 760W. Cooling and heating functions are optional features.

**Note:** Adhering to the above guidelines for preparation and placement environment will help ensure the optimal performance and longevity of the vending machine.

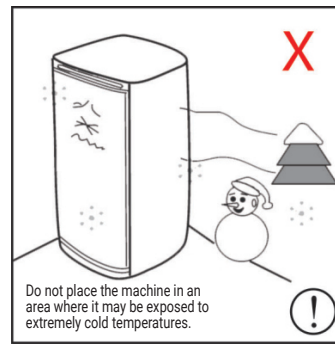
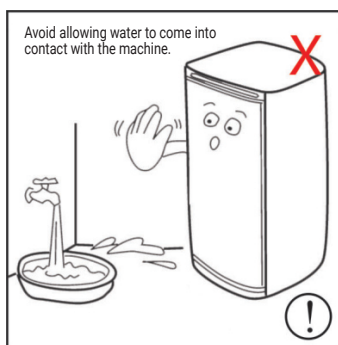
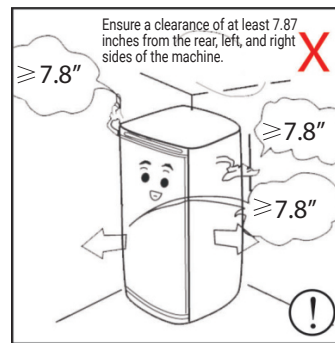
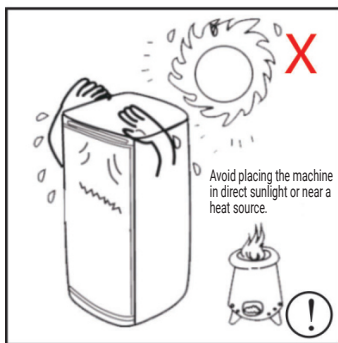
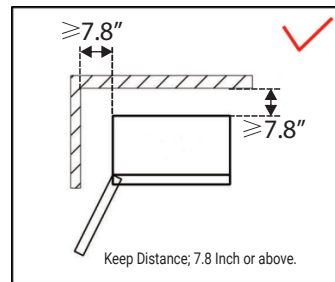
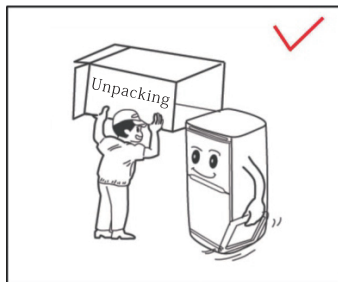

Must be grounded!



**WARNING**

The power supply of the vending machine must be grounded! An ungrounded machine must not be used, as it poses serious security risks. Ensure proper grounding before use!

# VENDING MACHINE SAFETY PRECAUTIONS

Use a reliable AC 220V/50Hz/10A power supply. Voltage fluctuations outside the range of 200-240V may cause machine failure.

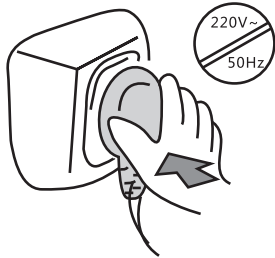

Utilize a reliable three-hole socket with grounding. Failure to do so could result in the risk of electric shock. After the machine is installed, ensure the plug is easily accessible.

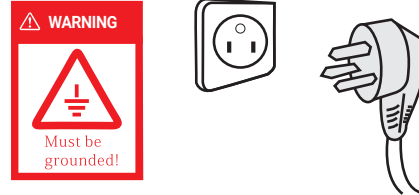

## Protect the power cord:

- A. Always hold the plug tightly (do not pull the power cord directly); pull out directly from the socket.
- B. Ensure the machine does not press on the power cord, and do not step on the power cord manually.
- C. Be careful not to crush or damage the power cord when moving the machine away from the wall.
- D. If the power cord is damaged or the plug is worn, discontinue use to avoid danger. Replacement must be done by professionals such as the manufacturer or maintenance department.

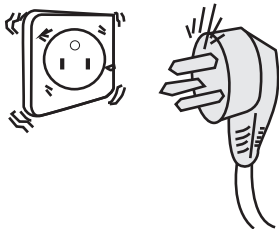

Unplug the power cord when cleaning, repairing, or replacing machine parts to prevent electric shock.

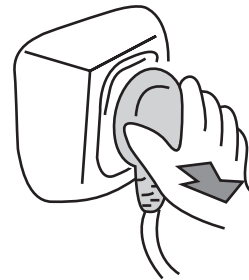

Dismantling or modifying the machine is strictly forbidden. Maintenance must be carried out by professionals.

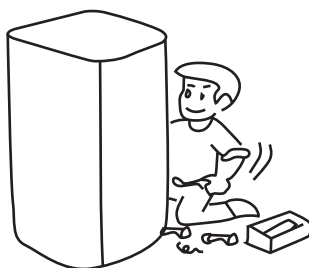

To retrieve items, push the door of the pickup slot with one hand while using the other to pick up the goods from the box. The pick-up door is heavy, so be cautious not to pinch your hands. Children should only use the machine with the assistance of an adult.

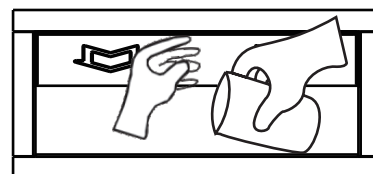



# VENDING MACHINE COMPONENTS FUNCTIONS INTRODUCTION

- Cargo lane: The tray is divided by a partition, and the passage for goods can be a spring or a crawler mechanism.
- Main board: A core component that controls the operation of the vending machine.
- Cash slot: Used for inserting cash when consumers want to purchase goods or for prefilling cash. Cash must be inserted individually and in a single tile for proper recognition.
- Coin slot: Used for inserting coins when consumers want to purchase goods or for prefilling coins. Coins must be inserted one by one.
- Cash machine: Receives, recognizes, stores, and dispenses cash. It can also have the optional function of prefilling change.
- Coin machine: Receives, recognizes, stores, and dispenses coins.
- Refrigeration and heating system: Optional system for cooling or heating goods.
- 5-inch display screen: Displays information to users.
- Metal keyboard: Used for product selection and menu operation input.
- Machine lock: Locks the machine door and container to prevent loss of goods.
- Coin return button: Used to return inserted coins or in case of a coin jam.
- Change slot: The window where users receive change or coins that were not recognized by the coin return mechanism.
- Pickup slot: The area where users retrieve purchased items.
- Power cord: Used to connect the vending machine to an external power supply. Ensure it is plugged into a reliable grounded socket.
- POS Device: Used for credit card transactions.
- Cargo lane number/price tag: Used to display cargo lane numbers and price information, making it easier for users to make purchases.

## Selection & Purchase Interface

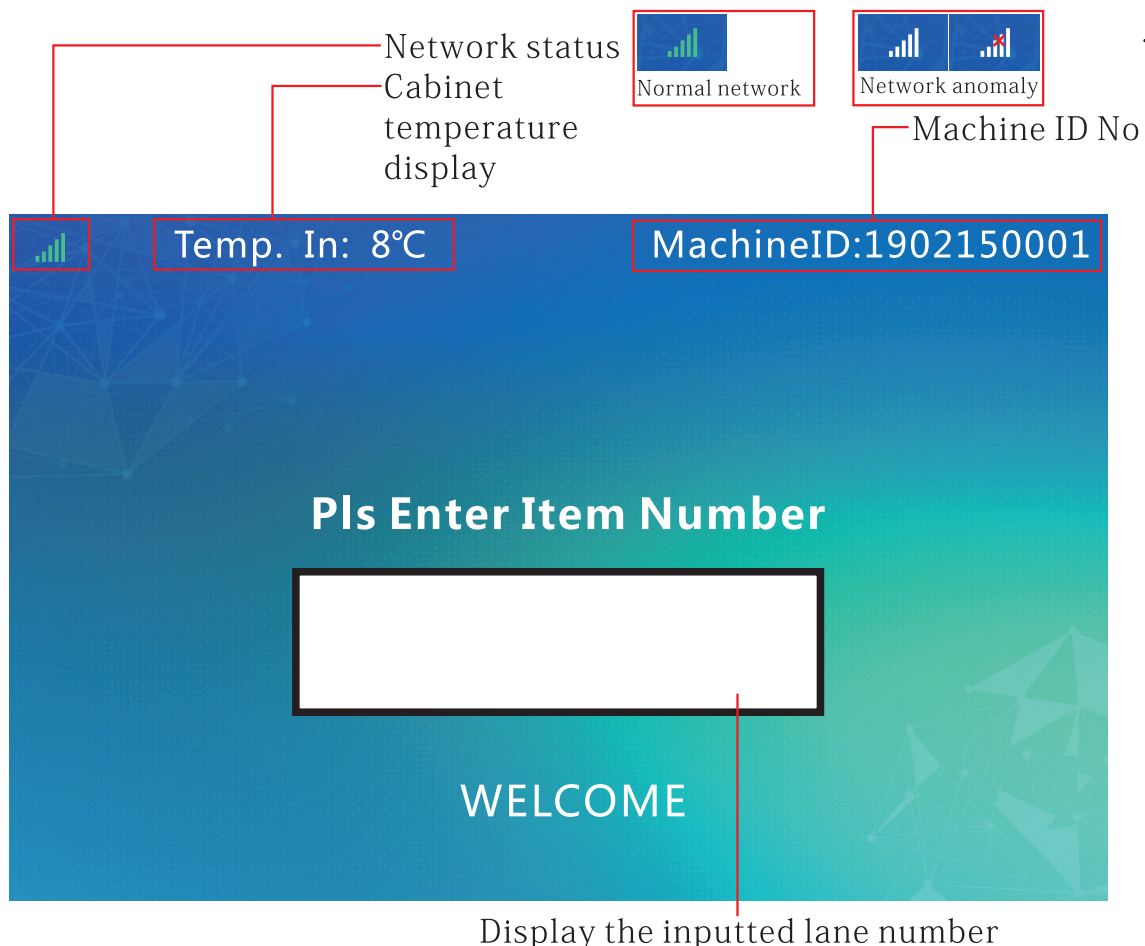

# MENU SETUP FLOWCHART: ITEM LOADING & CLEAR SLOT ERROR

## ITEM LOADING

## CLEAR SLOT ERROR

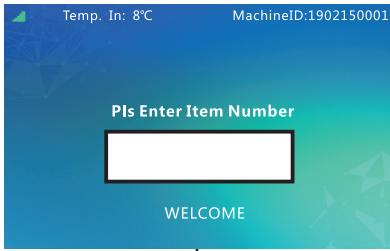

Open the machine door

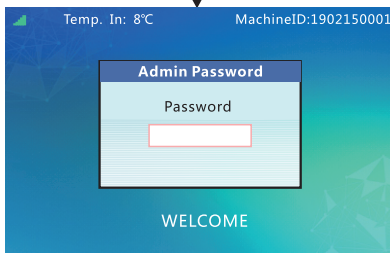

Enter the password using the digital keyboard. The initial password is "000000".

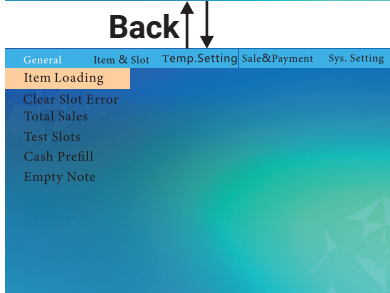

Ensure that the orange selection box is positioned on the "One-click Item Loading" option.

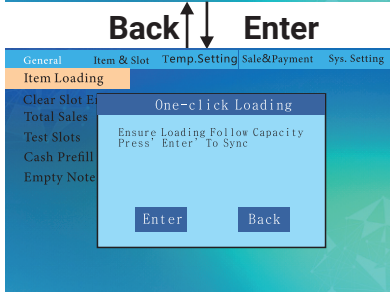

Fill all the cargo lanes with products according to the background settings. Press the "Enter" button to confirm. The existing quantity of all cargo lanes will be updated to match the cargo lane capacity.

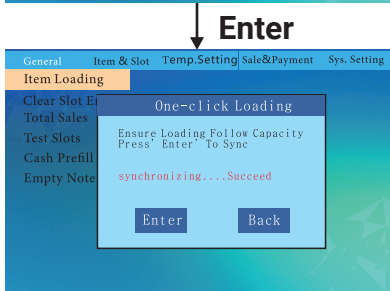

Once the machine has automatically synchronized, a prompt will appear indicating "Setup succeeded" and the current temperature will be displayed as "Temp. In: 8°C"

Close the machine door securely.



The vending machine should now enter the selection and purchase interface.

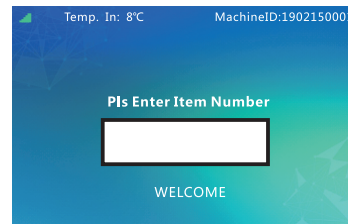

Open the machine door

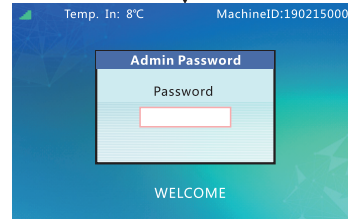

Enter the password using the digital keyboard. The initial password is "000000".

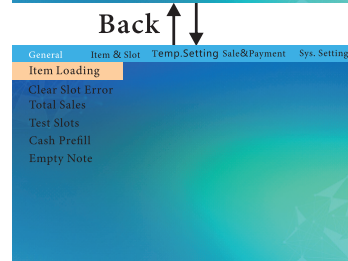

Ensure that the orange selection box is positioned on the "Clear Slot Error" option.

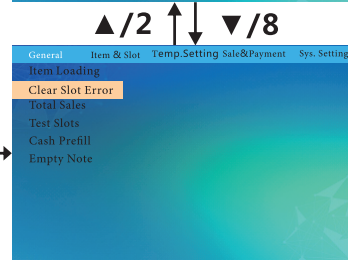

Once the cargo lane failure is cleared, the faulty cargo lane will rotate one full turn back to its initial position, resetting the error.

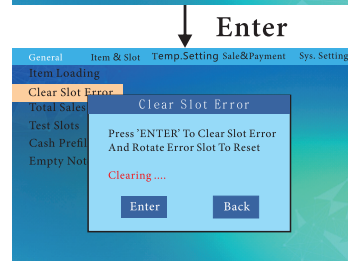
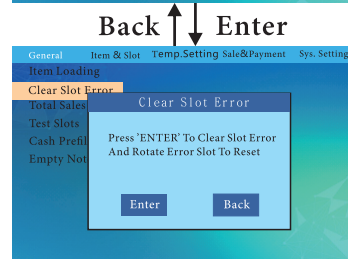

Once the cargo lane failure is cleared, the faulty cargo lane will rotate one full turn back to its initial position, resetting the error.

# MENU SETUP FLOWCHART: TOTAL SALES

## TOTAL SALES



Open the machine door

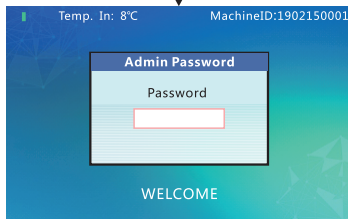

Enter the password using the digital keyboard. The initial password is "000000".

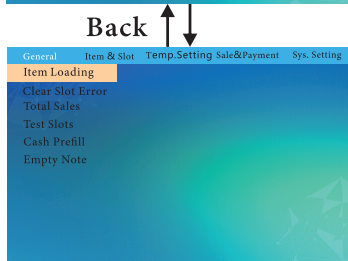

Back ↑ ↓

▲/2 ↑ ↓ ▼/8

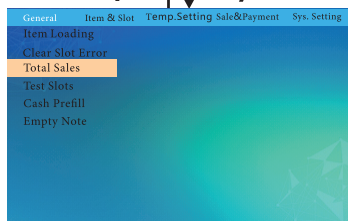

Select the "Total Sales" option

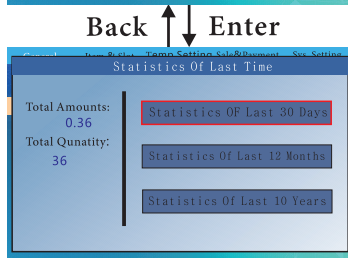

Back ↑ ↓ Enter

▲/2 ↑ ↓ ▼/8

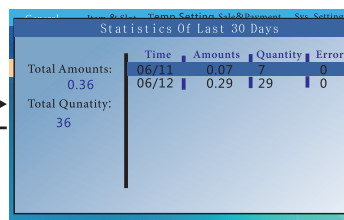

Select the sales report duration. (Press "2/8" to turn the page)

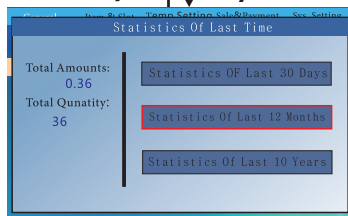

Enter →

← Back

▲/2 ↑ ↓ ▼/8

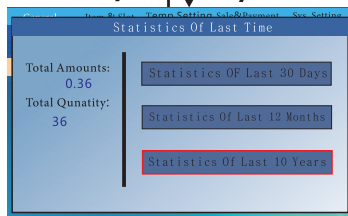
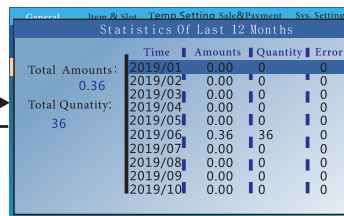

Enter →

← Back

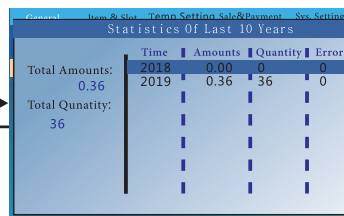

# MENU SETUP FLOWCHART: ITEM LOADING & CASH PREFILL

## TEST SLOTS



Open the machine door

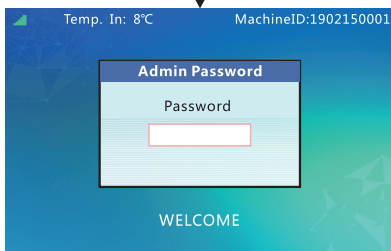

Enter the password using the digital keyboard. The initial password is "000000".

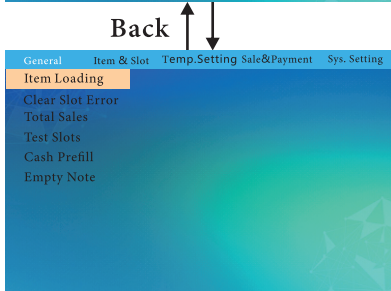

Back

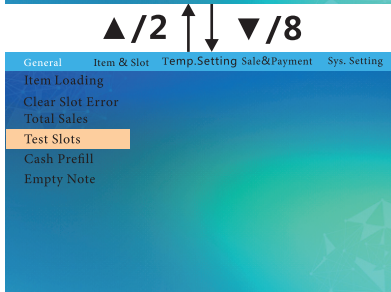

▲/2 ▼/8

Ensure that the orange selection box is positioned on the "Test Slots" option.

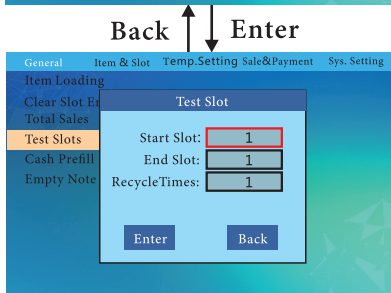

Back Enter

Input the starting cargo lane number and the ending cargo lane number for the test.

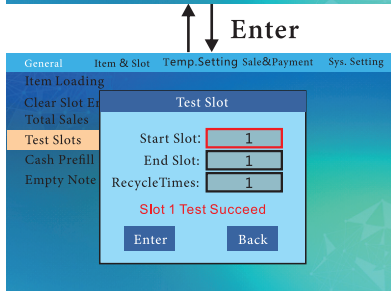

Enter

Set the number of cycle tests. (Note: Turn off the optical inspection before testing the cargo lane or manually block the optical inspection when the cargo lane rotates to ensure proper testing and spring reset.)

## CASH PREFILL

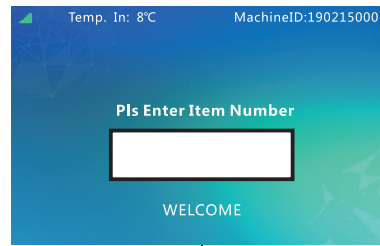

Open the machine door

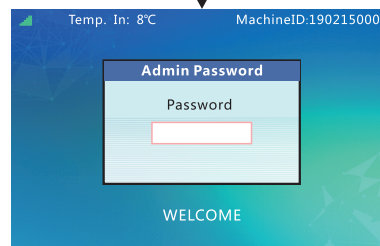

Enter the password using the digital keyboard. The initial password is "000000".

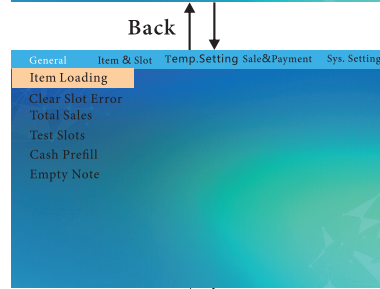

Back

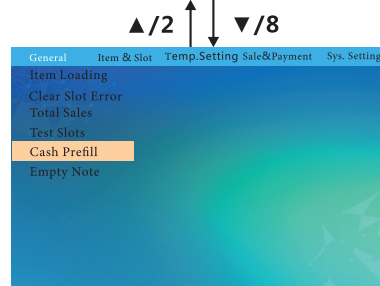

▲/2 ▼/8

Ensure that the orange selection box is positioned on the "Cash Prefill" option.

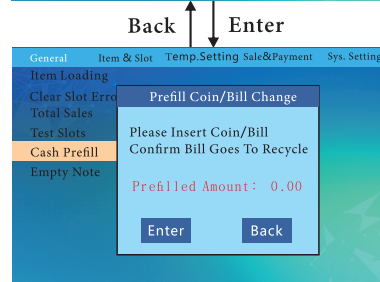

Back Enter

Check whether the change amount entered matches the current prefill amount displayed. Verify that there are no mistakes and press the "Enter" button to confirm.

# MENU SETUP FLOWCHART: EMPTY NOTE & SET PRICE

## EMPTY NOTE

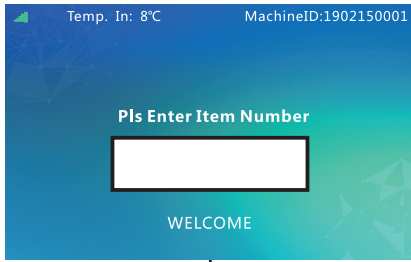

Open the machine door

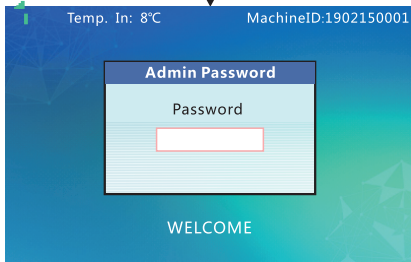

Enter the password using the digital keyboard. The initial password is "000000".

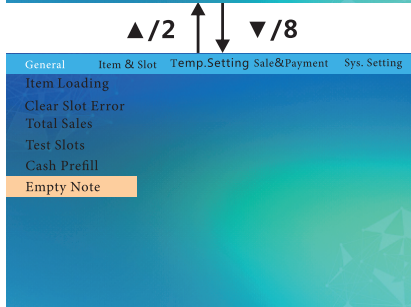
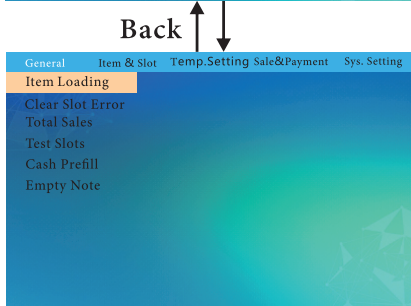

Ensure that the orange selection box is positioned on the "Empty Note" option.

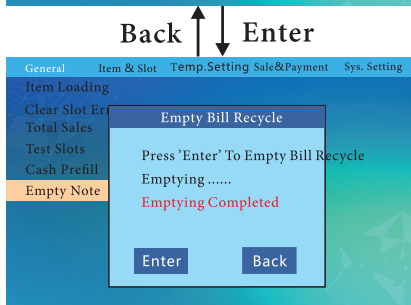
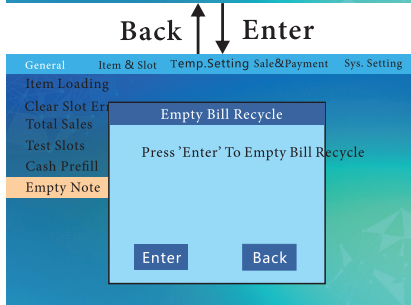

## SET PRICE

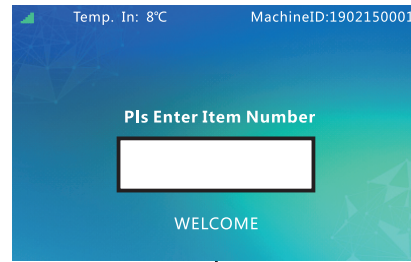

Open the machine door  
Enter the password using the digital keyboard. The initial password is "000000".

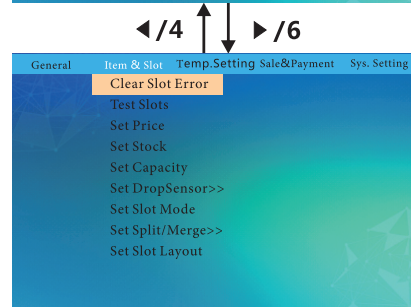
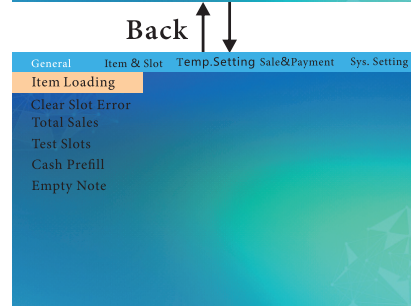
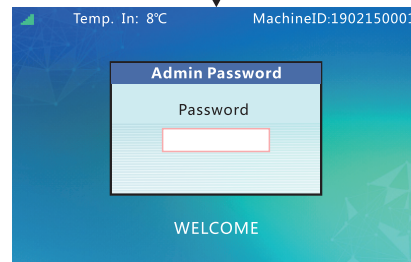

Back

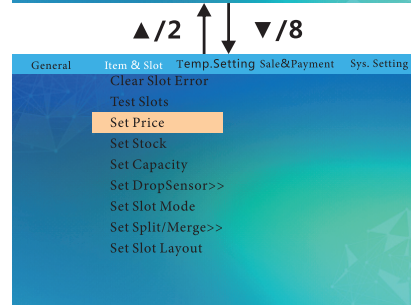

Input the initial cargo lane number and the ending cargo lane number that you want to set. Set the price for the selected cargo lane number. Press the "Enter" button to save the setting.

# MENU SETUP FLOWCHART: SET PRICE & SET CAPACITY

## SET PRICE

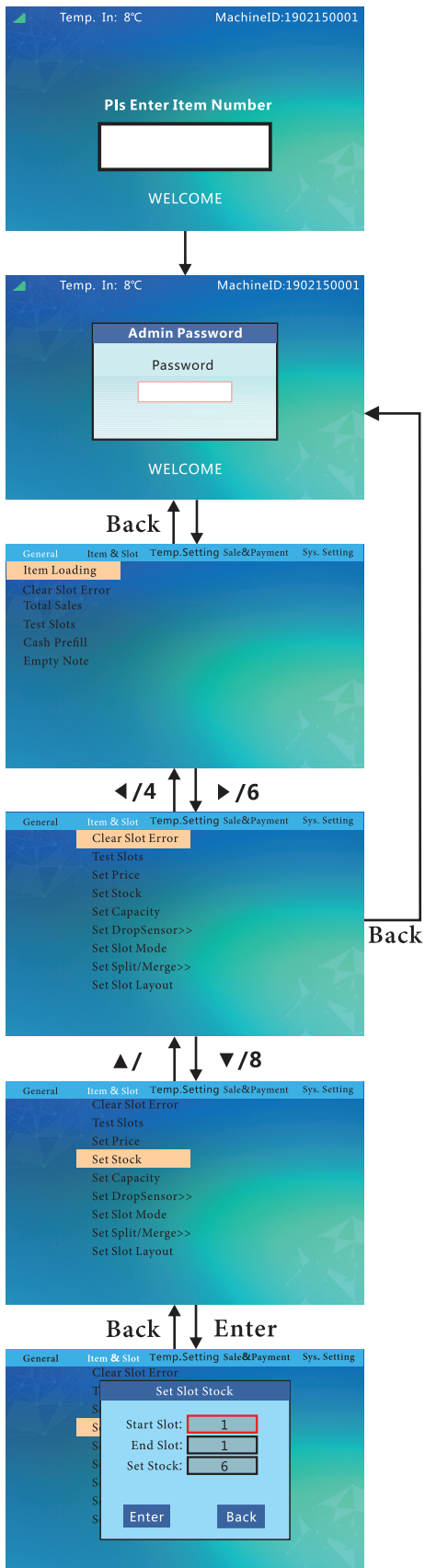

## SET CAPACITY

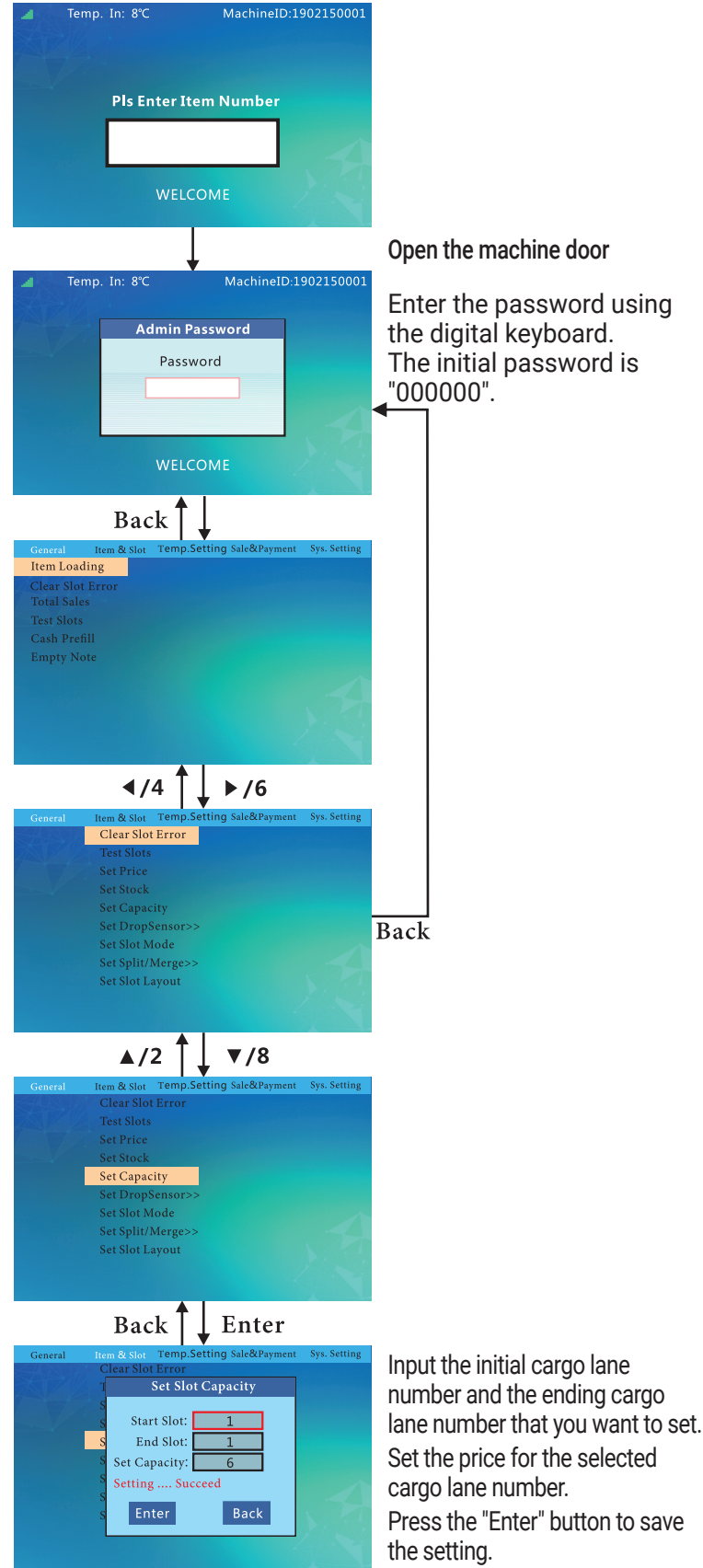

# MENU SETUP FLOWCHART: SET VMC DROP SENSOR

## SET VMC DROP SENSOR ON/OFF

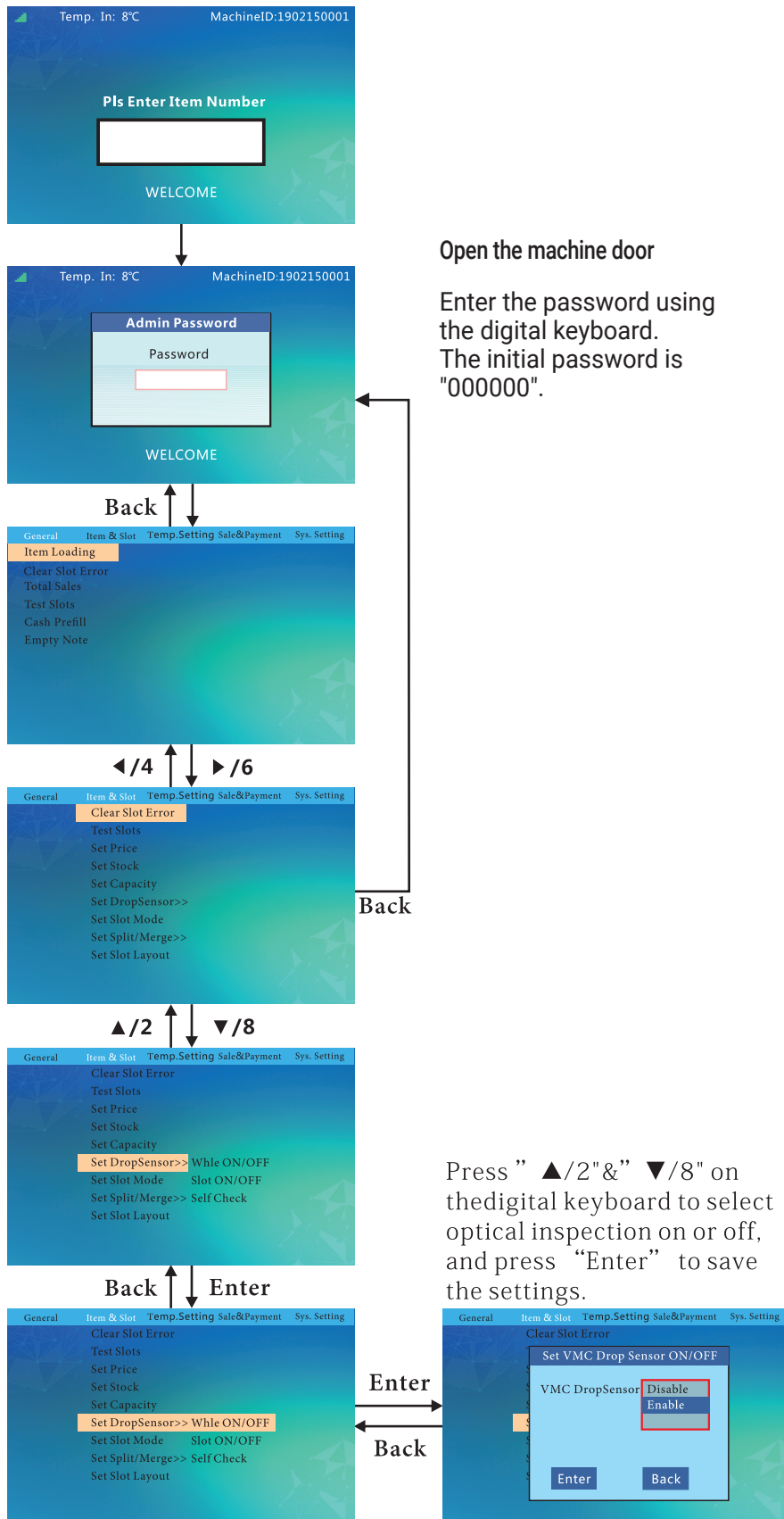

# MENU SETUP FLOWCHART: SET SLOT DROP SENSOR

## SET SLOT DROP SENSOR ON/OFF

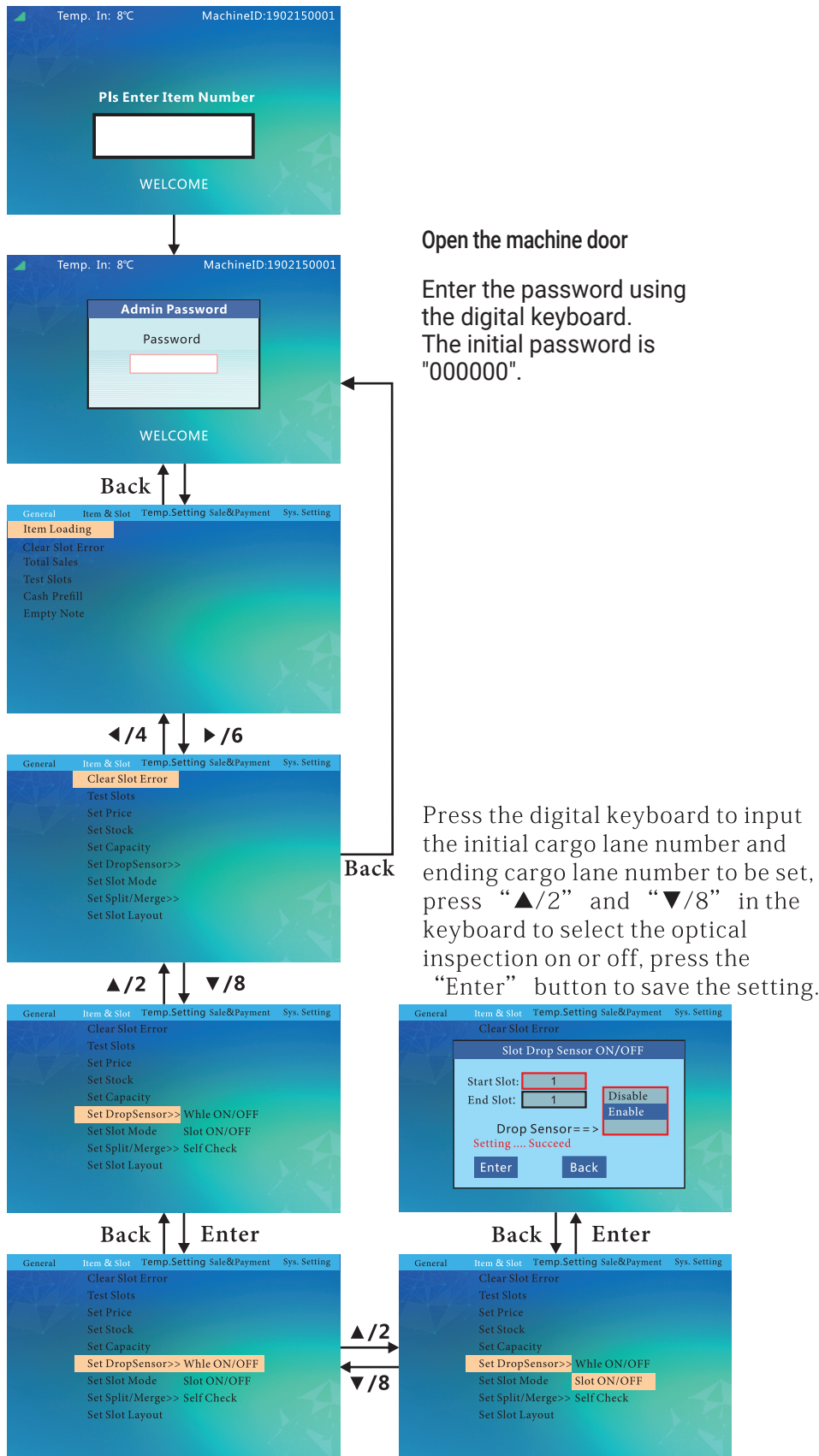

Open the machine door

Enter the password using the digital keyboard. The initial password is "000000".

Press the digital keyboard to input the initial cargo lane number and ending cargo lane number to be set, press "▲/2" and "▼/8" in the keyboard to select the optical inspection on or off, press the "Enter" button to save the setting.



# MENU SETUP FLOWCHART: DROP SENSOR SELF-CHECK

## DROP SENSOR SELF-CHECK

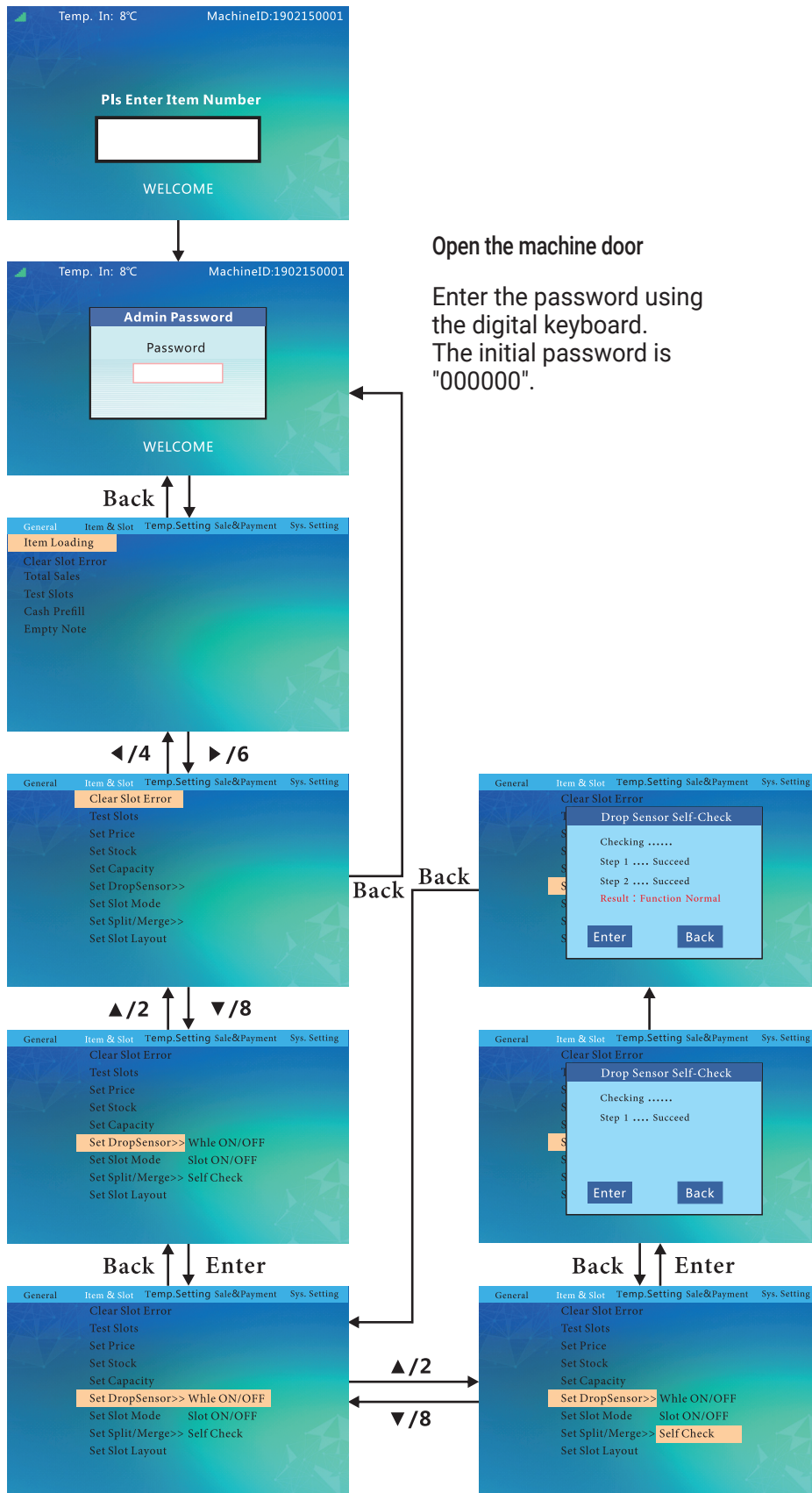

Open the machine door

Enter the password using the digital keyboard. The initial password is "000000".

# MENU SETUP FLOWCHART: SET SLOT MODE

## SET SLOT MODE

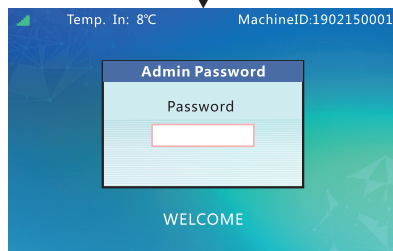
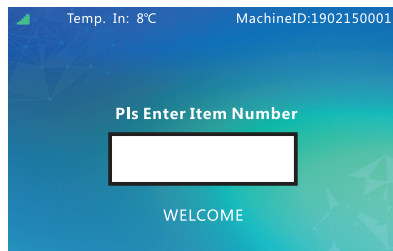

Open the machine door

Enter the password using the digital keyboard. The initial password is "000000".

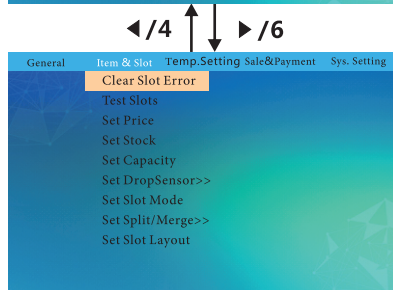
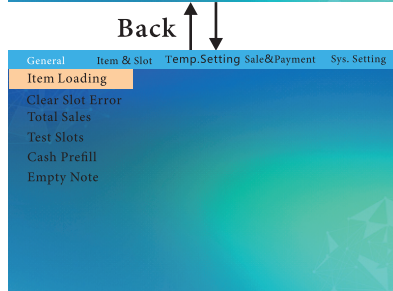

Back

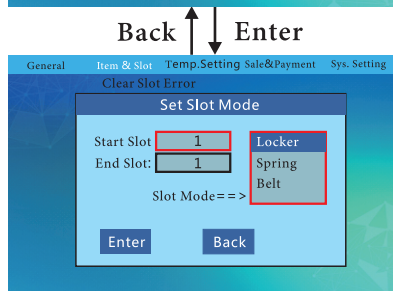
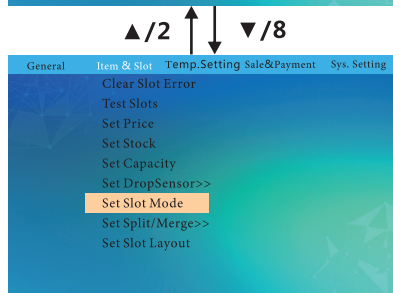

Press the digital keyboard to input the initial cargo lane number and ending cargo lane number to be set, and set the driving mode of the selected cargo lane. Press "Enter" to save the setting.

# MENU SETUP FLOWCHART: MERGE SLOT

## MERGE SLOT

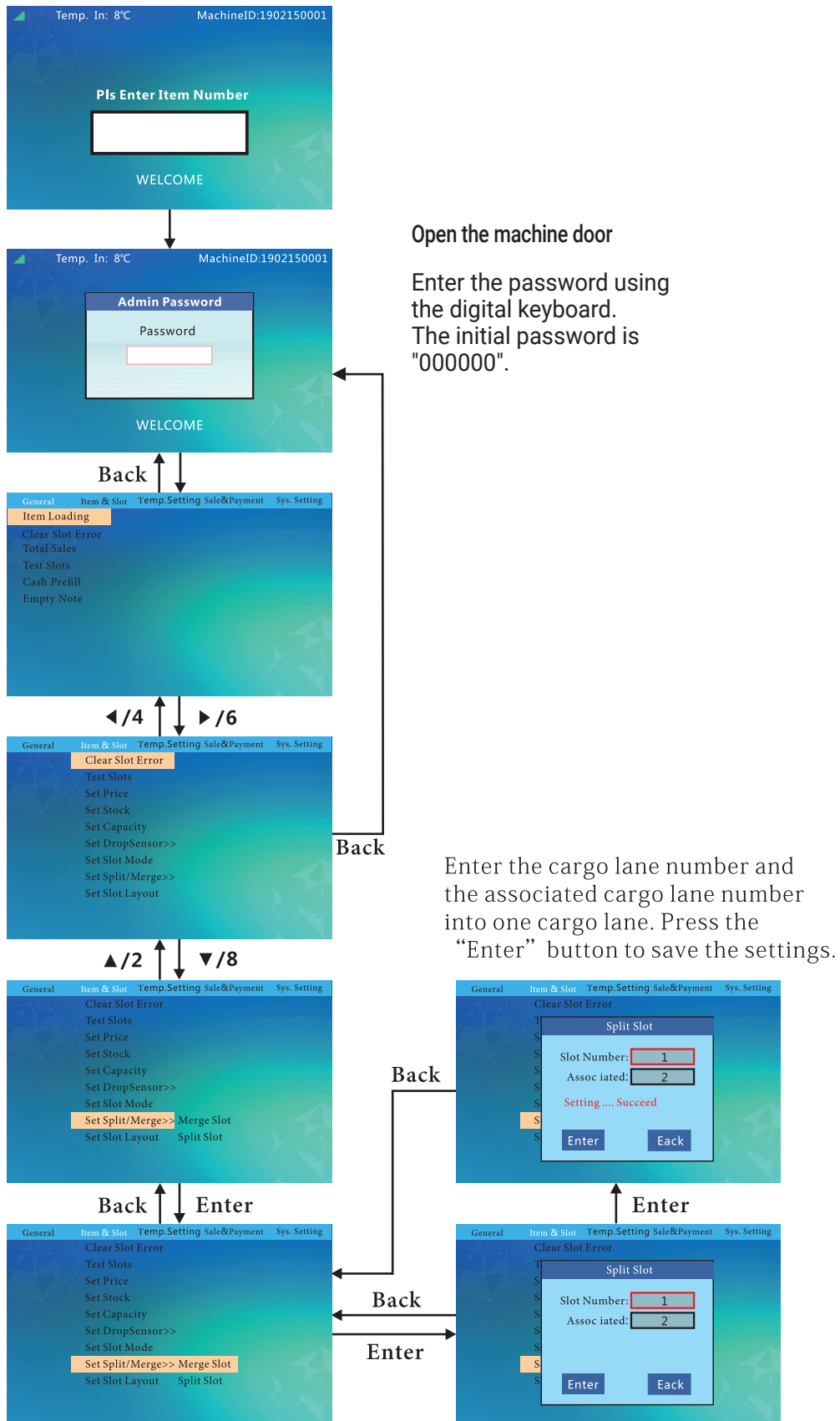

# MENU SETUP FLOWCHART: SPLIT SLOT

## SPLIT SLOT

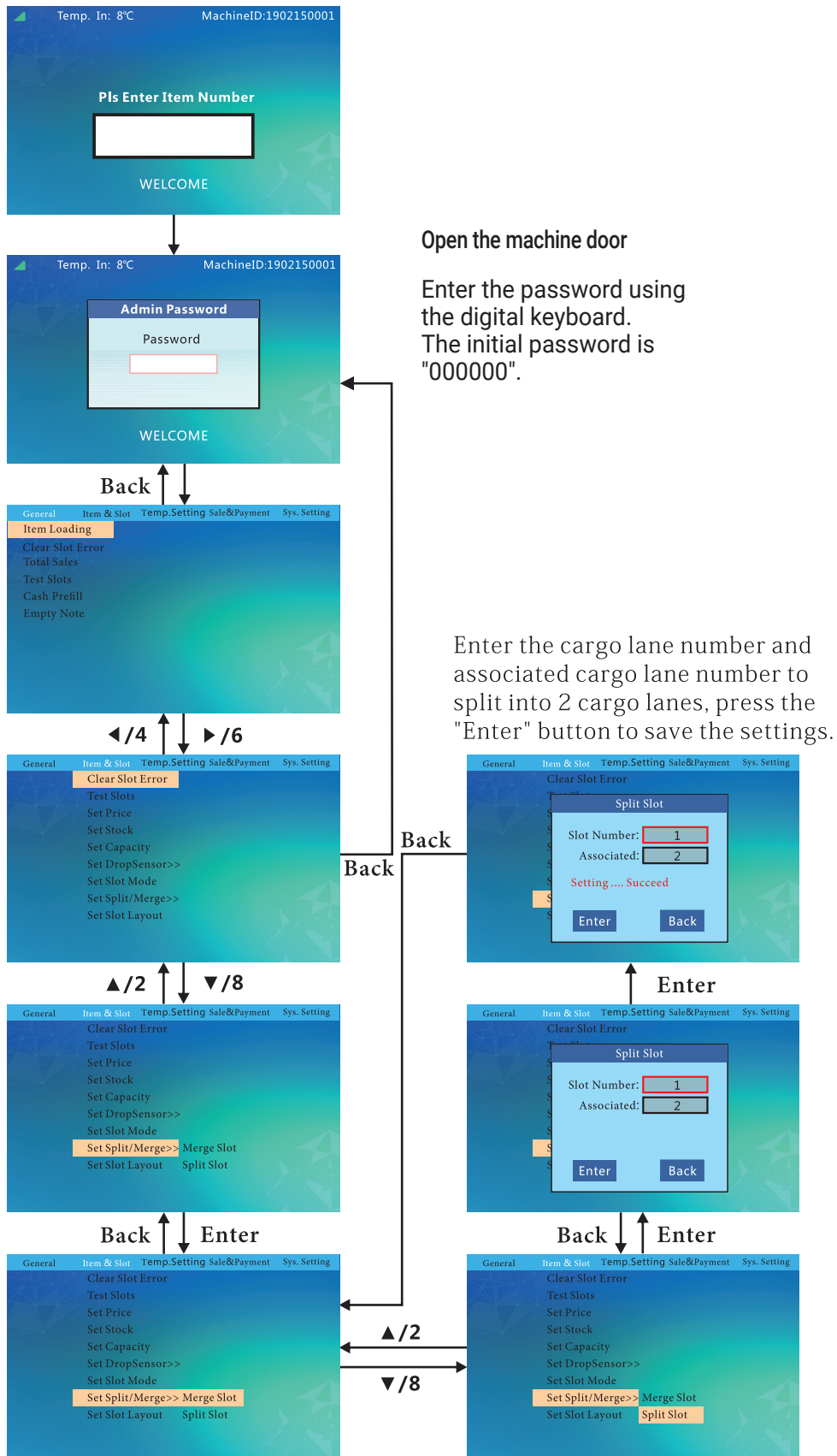

# MENU SETUP FLOWCHART: SET SLOT LAYOUT

## SET SLOT LAYOUT

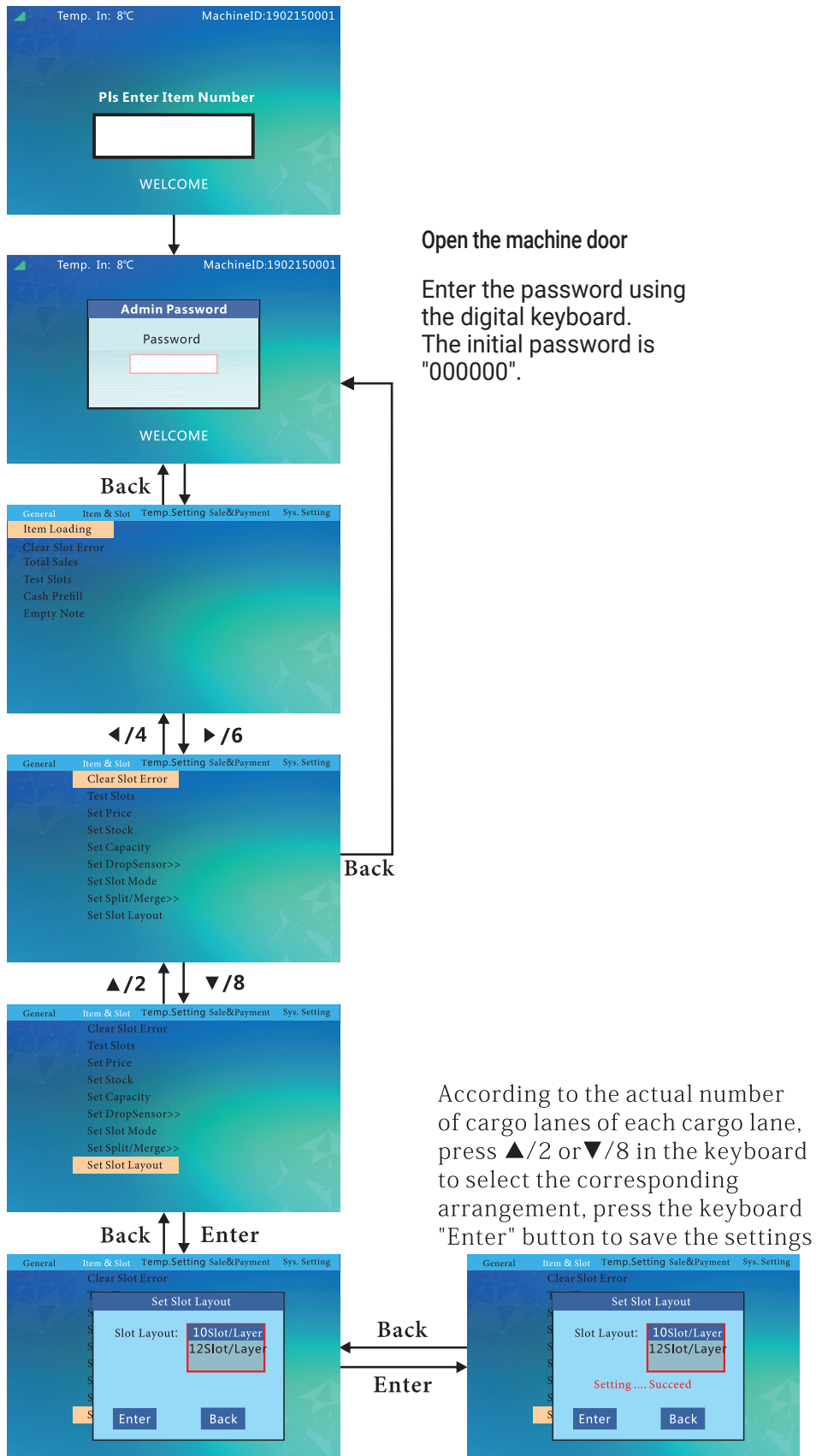

# MENU SETUP FLOWCHART: SET TEMPERATURE MODE / TARGET

## SET TEMPERATURE MODE

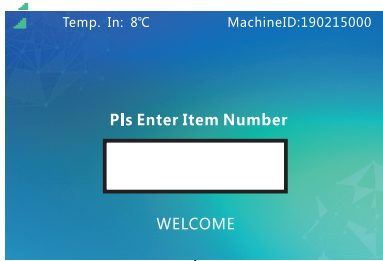

Open the machine door

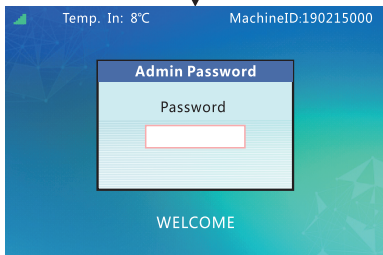

Enter the password using the digital keyboard. The initial password is "000000".

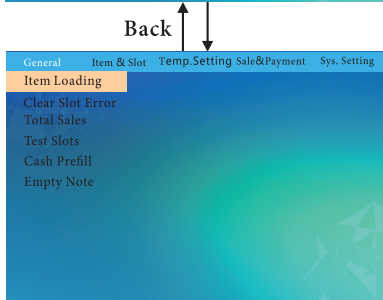

Back

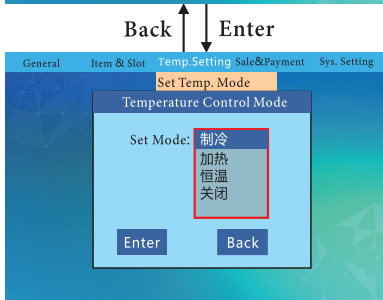

Select the Temperature Mode:

- Refrigeration Mode
- Non-Refrigeration Mode
- Constant Temperature Mode
- Turned Off

After selecting the desired Temp. Mode, Press Enter to confirm.

## SET TARGET TEMPERATURE

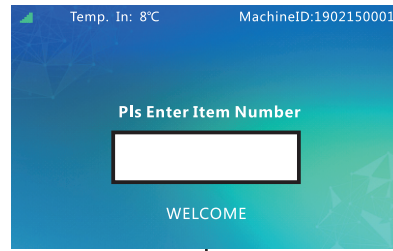

Open the machine door

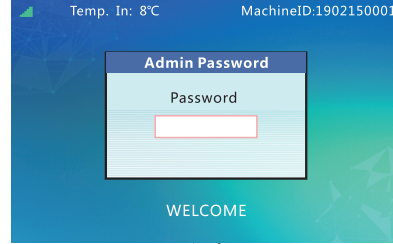

Enter the password using the digital keyboard. The initial password is "000000".

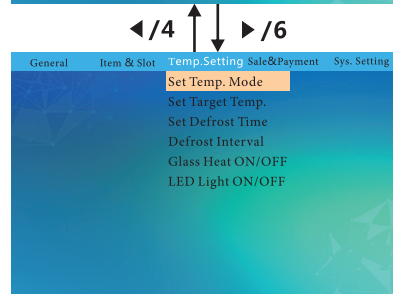
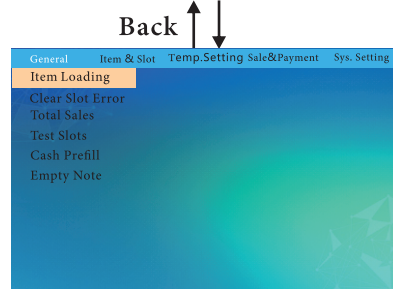

Back

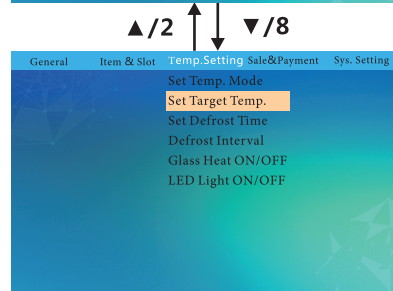

According to the actual needs of the machine, press UP/2 or DOWN/8 on the keyboard to select the corresponding temperature control mode. Once selected, press the "Enter" key to save your settings.

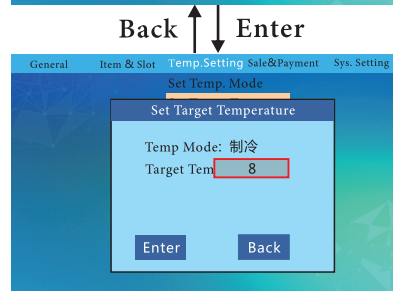

Note: When the constant temperature mode is selected, the machine will automatically switch the temperature control mode. This automatic switch occurs when the machine detects a difference of 6 degrees between the ambient temperature and the set temperature.

# MENU SETUP FLOWCHART: SET DEFROST TIME/INTERVAL & SET GLASS HEAT

## SET DEFROST TIME/DEFROST INTERVAL

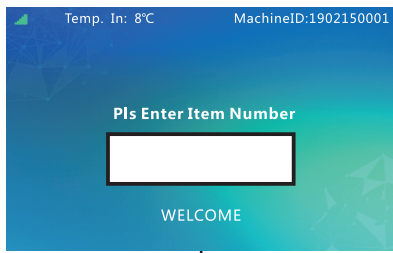

Open the machine door

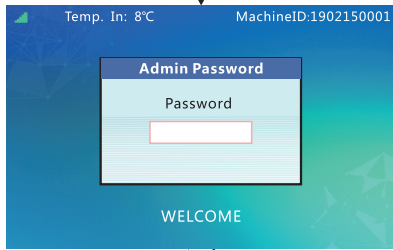

Enter the password using the digital keyboard. The initial password is "000000".

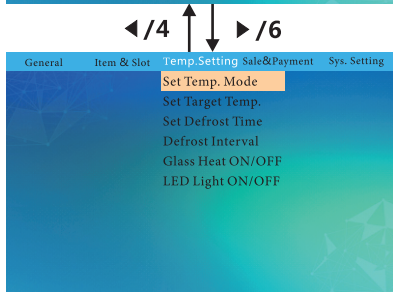
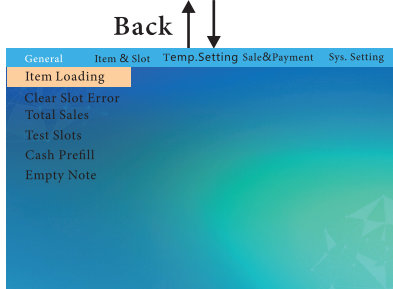

Back

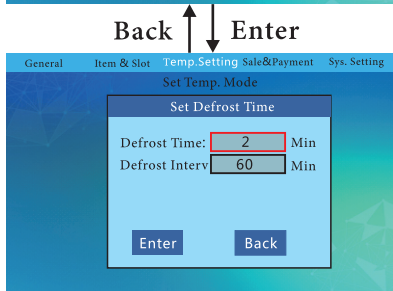
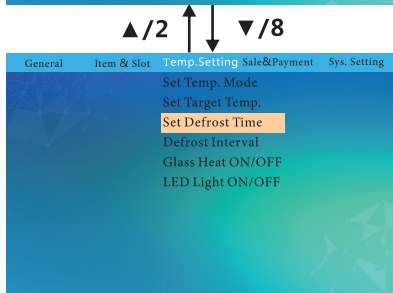

Set the defrosting time and downtime defrosting cycle (defrosting time interval), press the "Enter" button to save the settings.

## SET GLASS HEAT ON/OFF

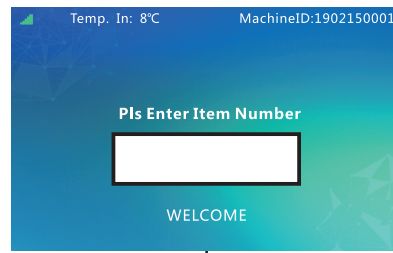

Open the machine door

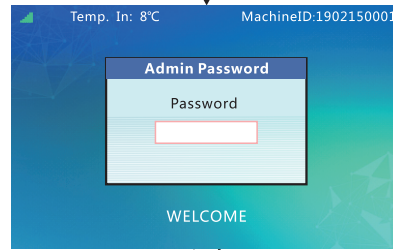

Enter the password using the digital keyboard. The initial password is "000000".

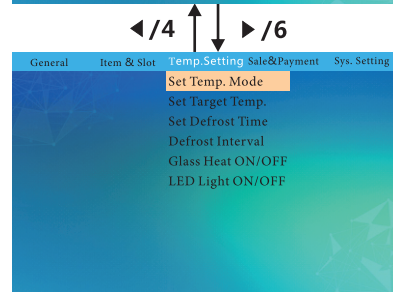
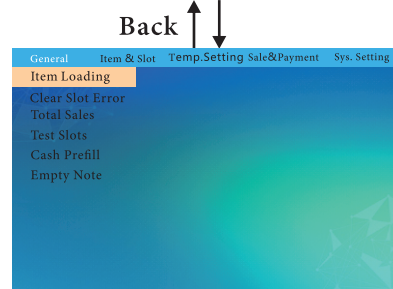

Back

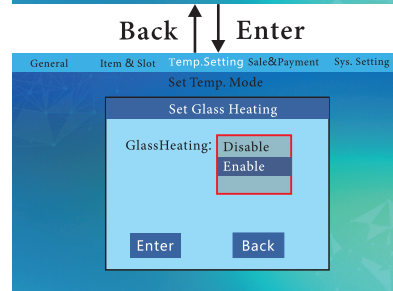
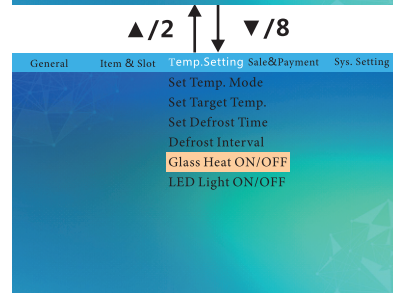

Press ▲ 2 / ▼ 8 in the keyboard to select Disable or Enable, select whether the glass heating is on, press the "Enter" button to save the settings.

# MENU SETUP FLOWCHART: SET LED LIGHT & SALES PER SLOT

## SET LED LIGHT ON/OFF

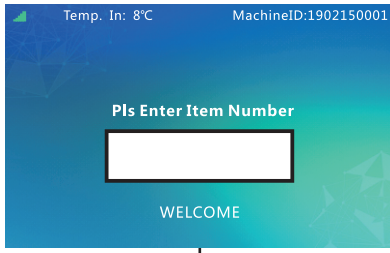

Open the machine door

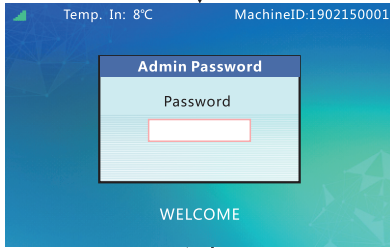

Enter the password using the digital keyboard. The initial password is "000000".

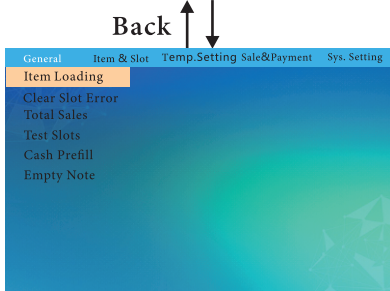

Back

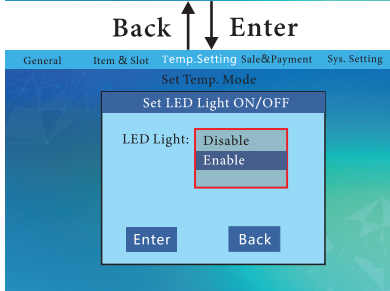
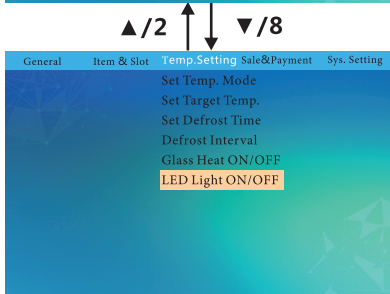

Press  $\blacktriangle/2$  /  $\blacktriangledown/8$  in the keyboard to select Disable or Enable, select whether the glass heating is on, press the "Enter" button to save the settings.

## SALES PER SLOT

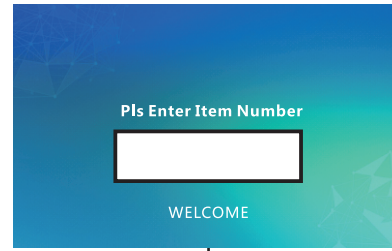

Open the machine door

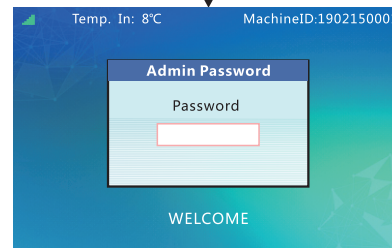

Enter the password using the digital keyboard. The initial password is "000000".

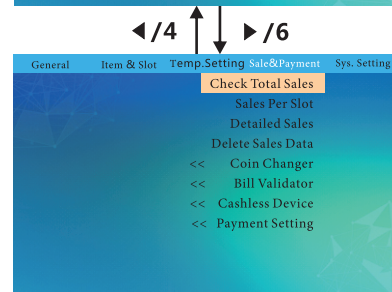
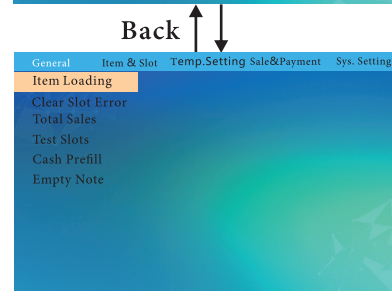

Back

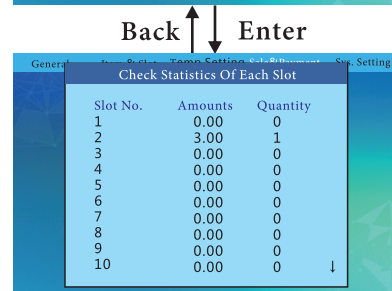
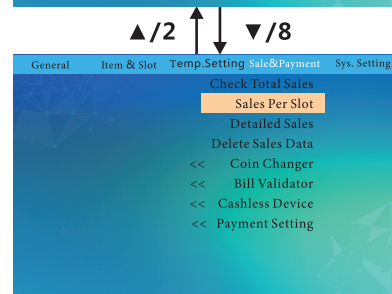

Press  $\blacktriangle/2$  /  $\blacktriangledown/8$  in the keyboard to see more cargo lanes



# MENU SETUP FLOWCHART: CHECK STATISTICS OF EACH PAY TYPE

## CHECK STATISTICS OF EACH PAY TYPE

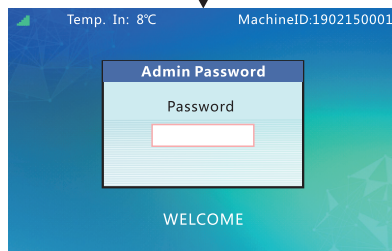

Open the machine door

Enter the password using the digital keyboard. The initial password is "000000".

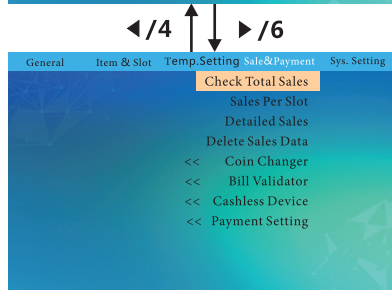
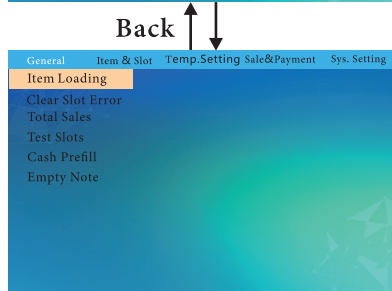

Back

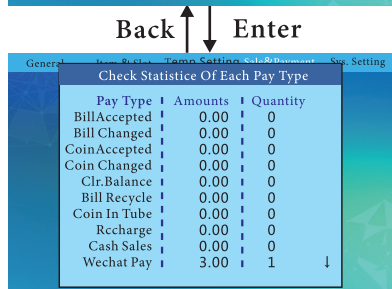
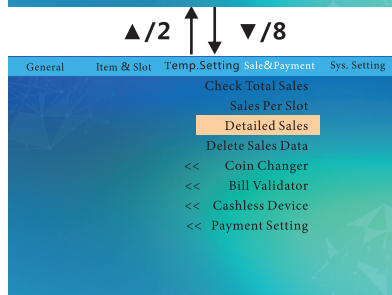



# MENU SETUP FLOWCHART: SET COIN CHANGE

## SET COIN CHANGE ON/OFF

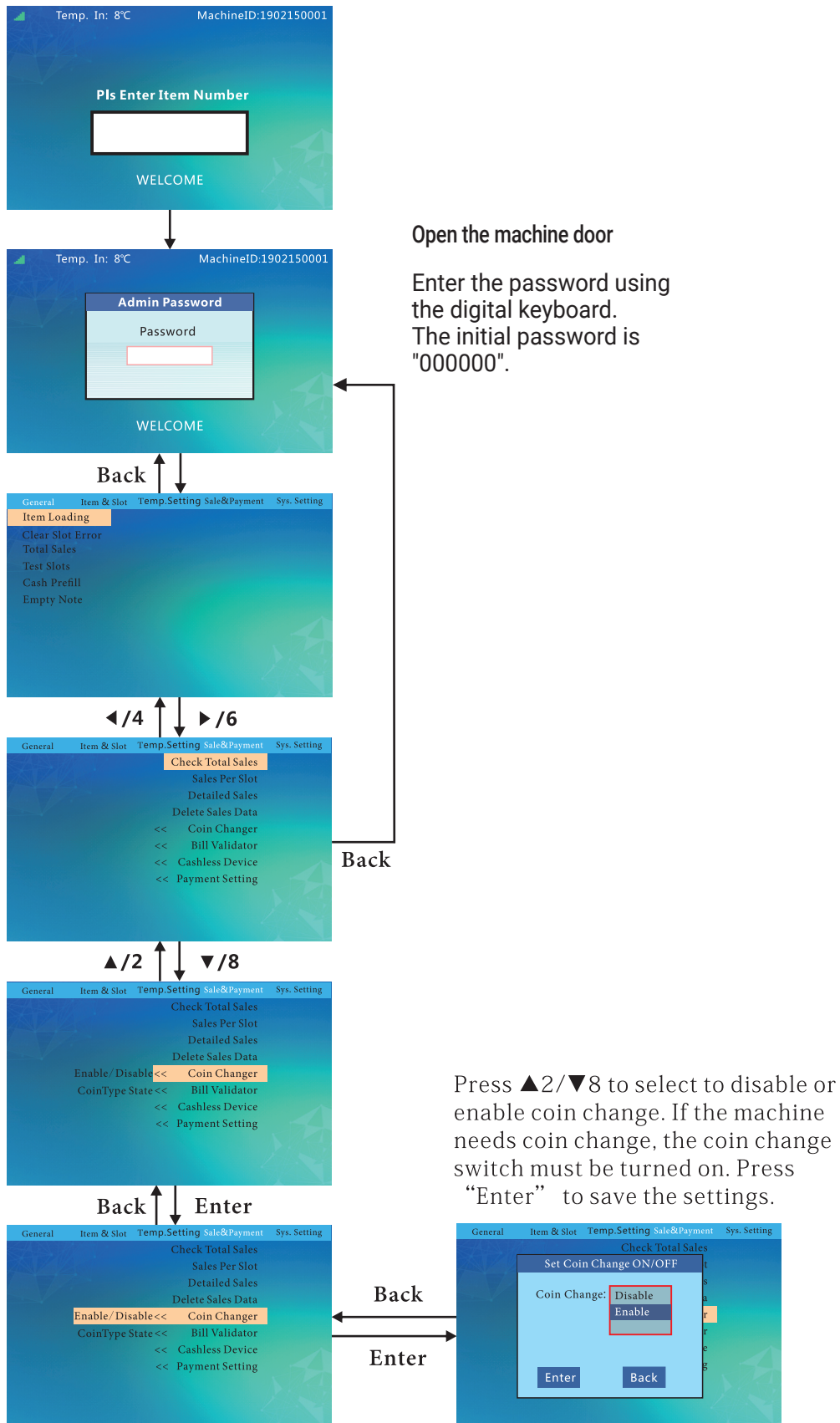

# MENU SETUP FLOWCHART: ENABLE COIN DENOMINATIONS

## ENABLE COIN DENOMINATIONS

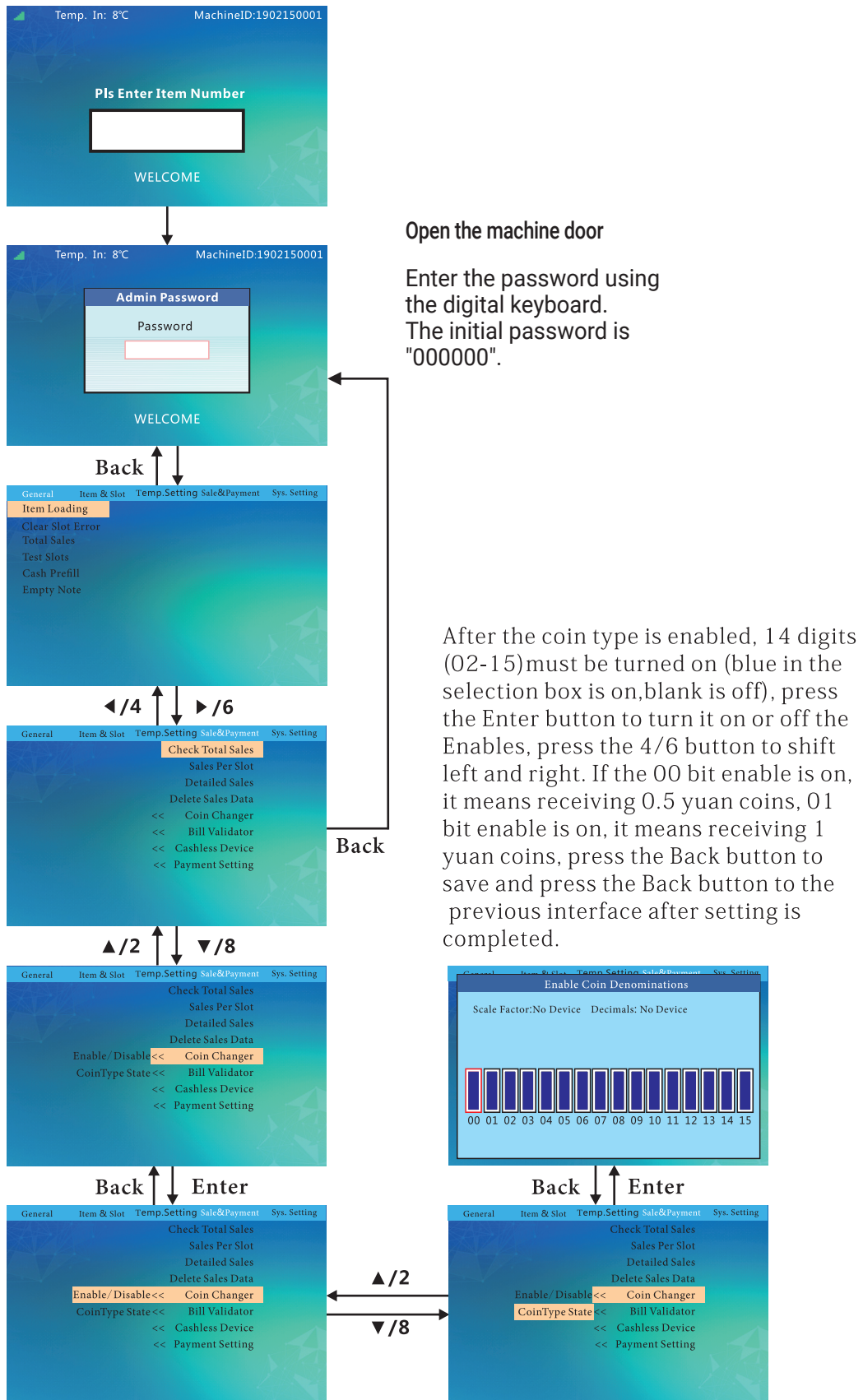

# MENU SETUP FLOWCHART: SET BILL ESCROW ON/OFF

## SET BILL ESCROW ON/OFF

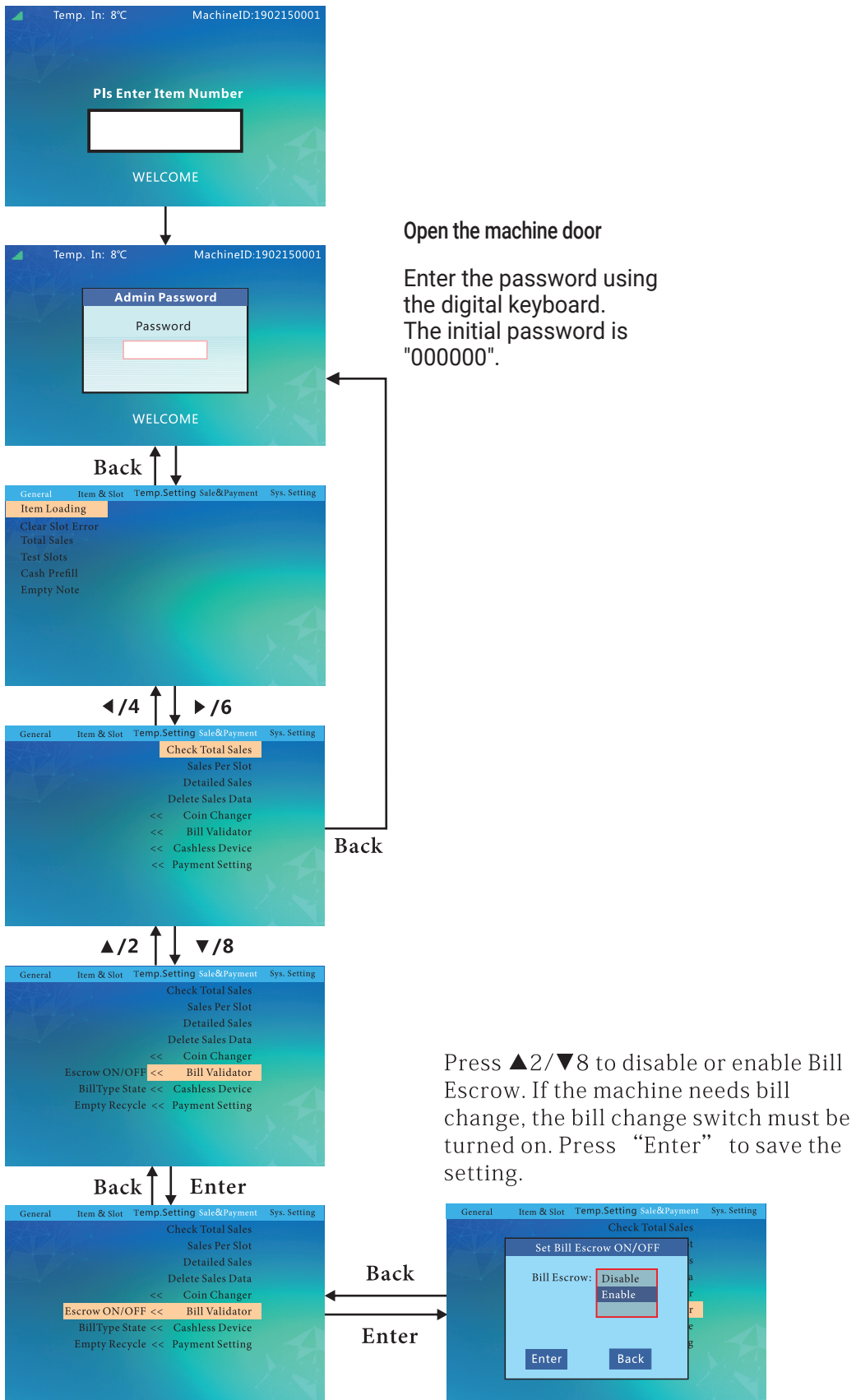

# MENU SETUP FLOWCHART: SET COIN CHANGE

## ENABLE BILL DENOMINATIONS

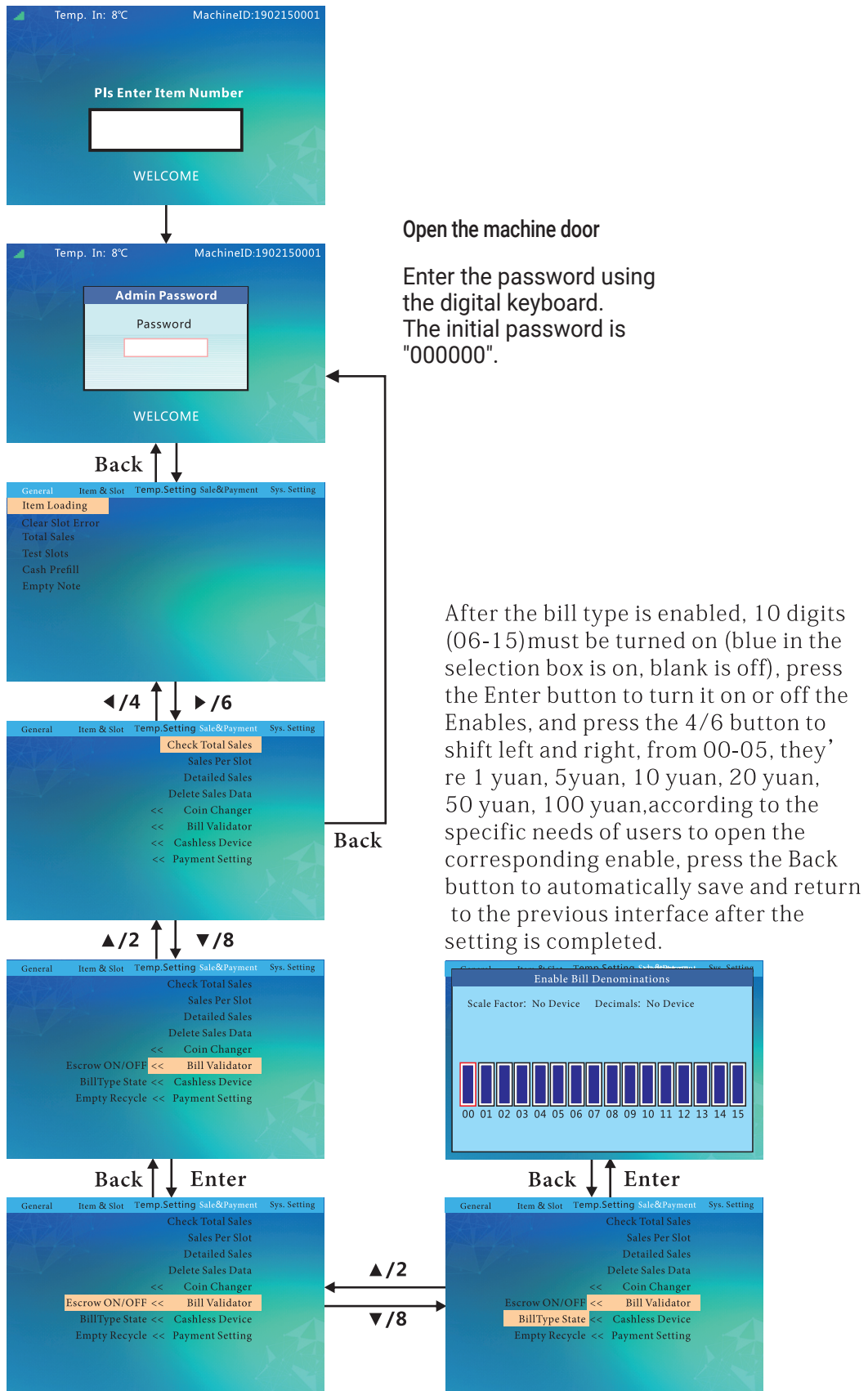

# MENU SETUP FLOWCHART: EMPTY BILL RECYCLE

## EMPTY BILL RECYCLE

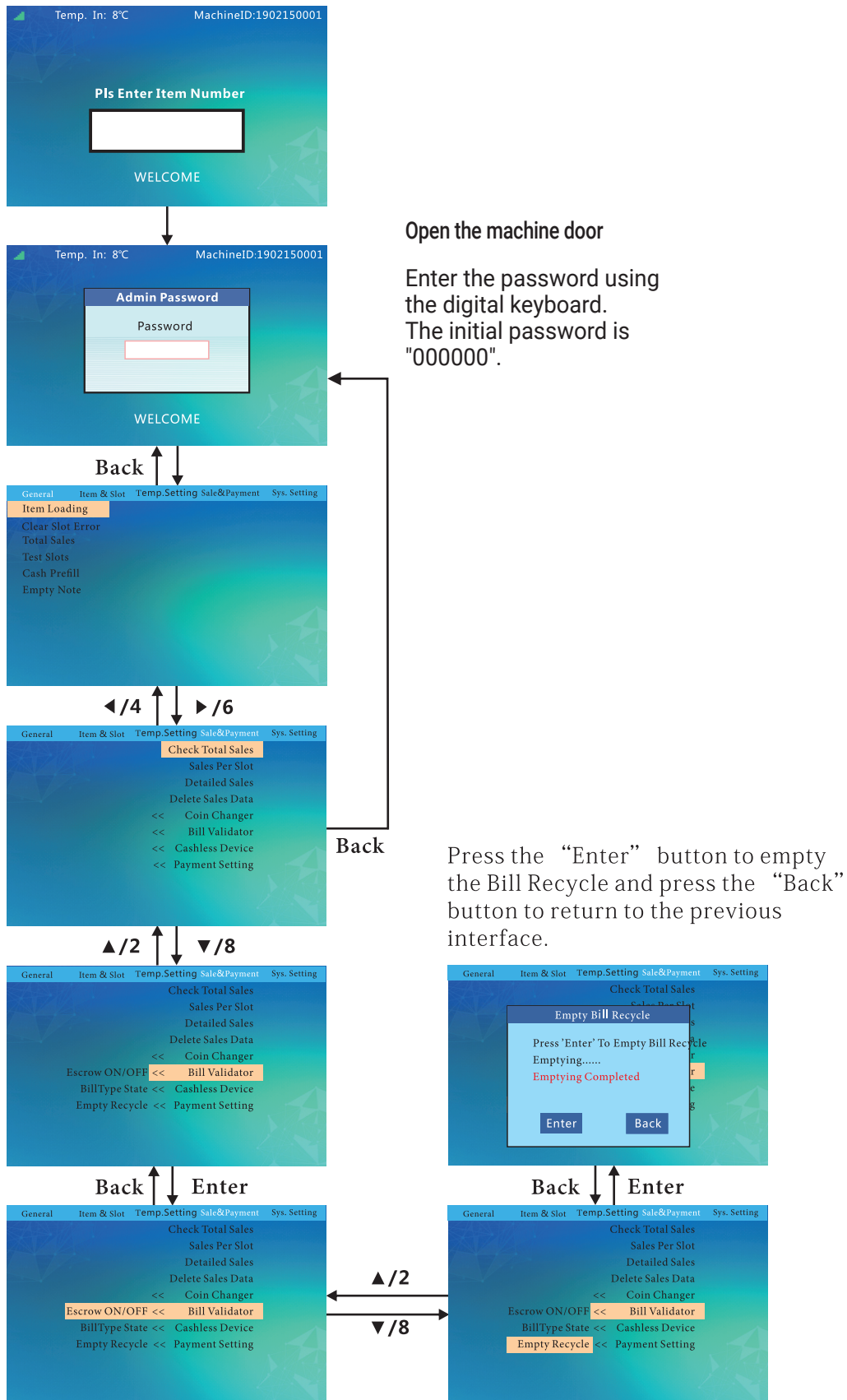

# MENU SETUP FLOWCHART: SET IC CARD READER

## SET IC CARD READER

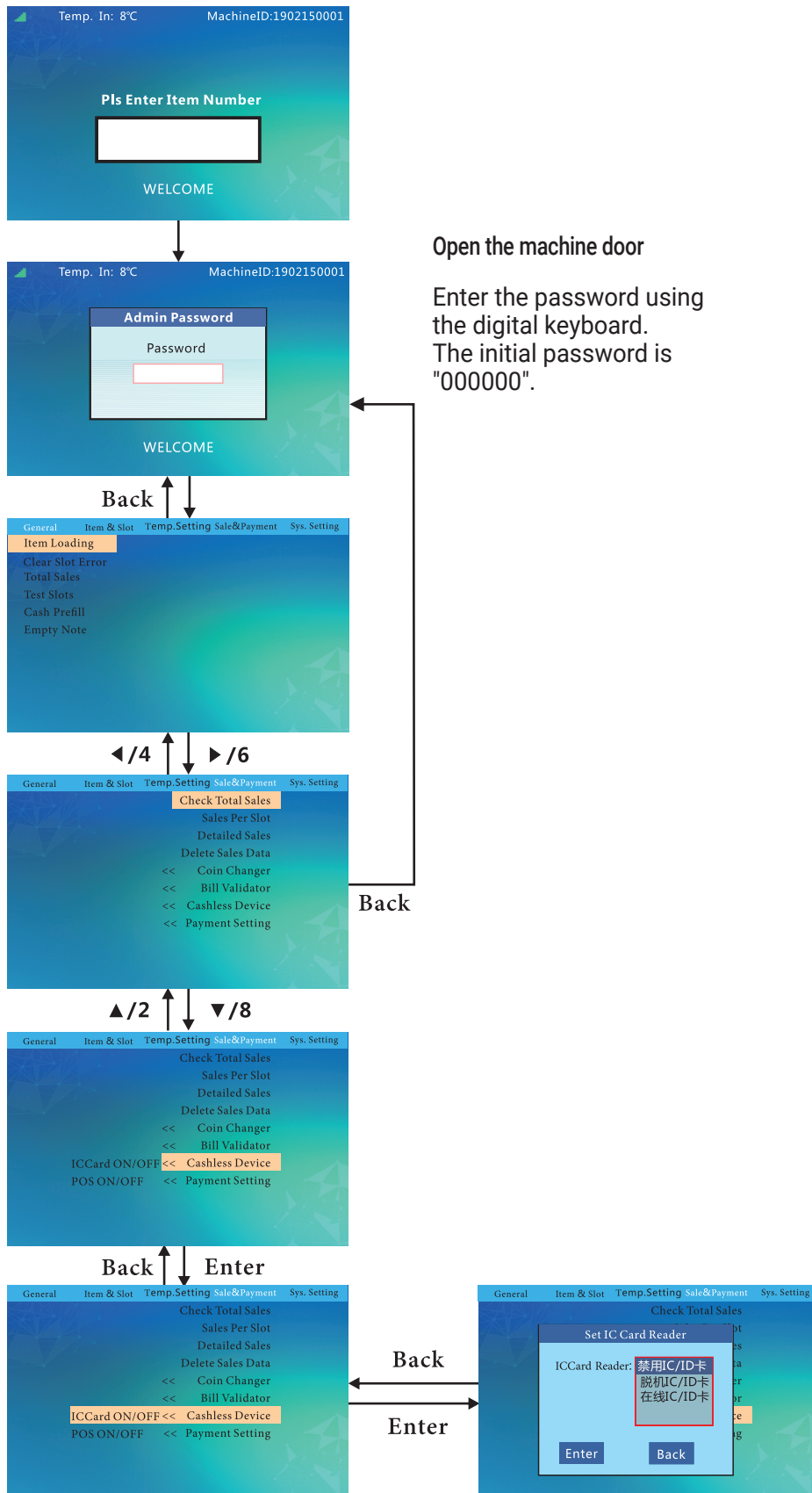



# MENU SETUP FLOWCHART: SET POS DEVICE

## SET POS DEVICE ON/OFF

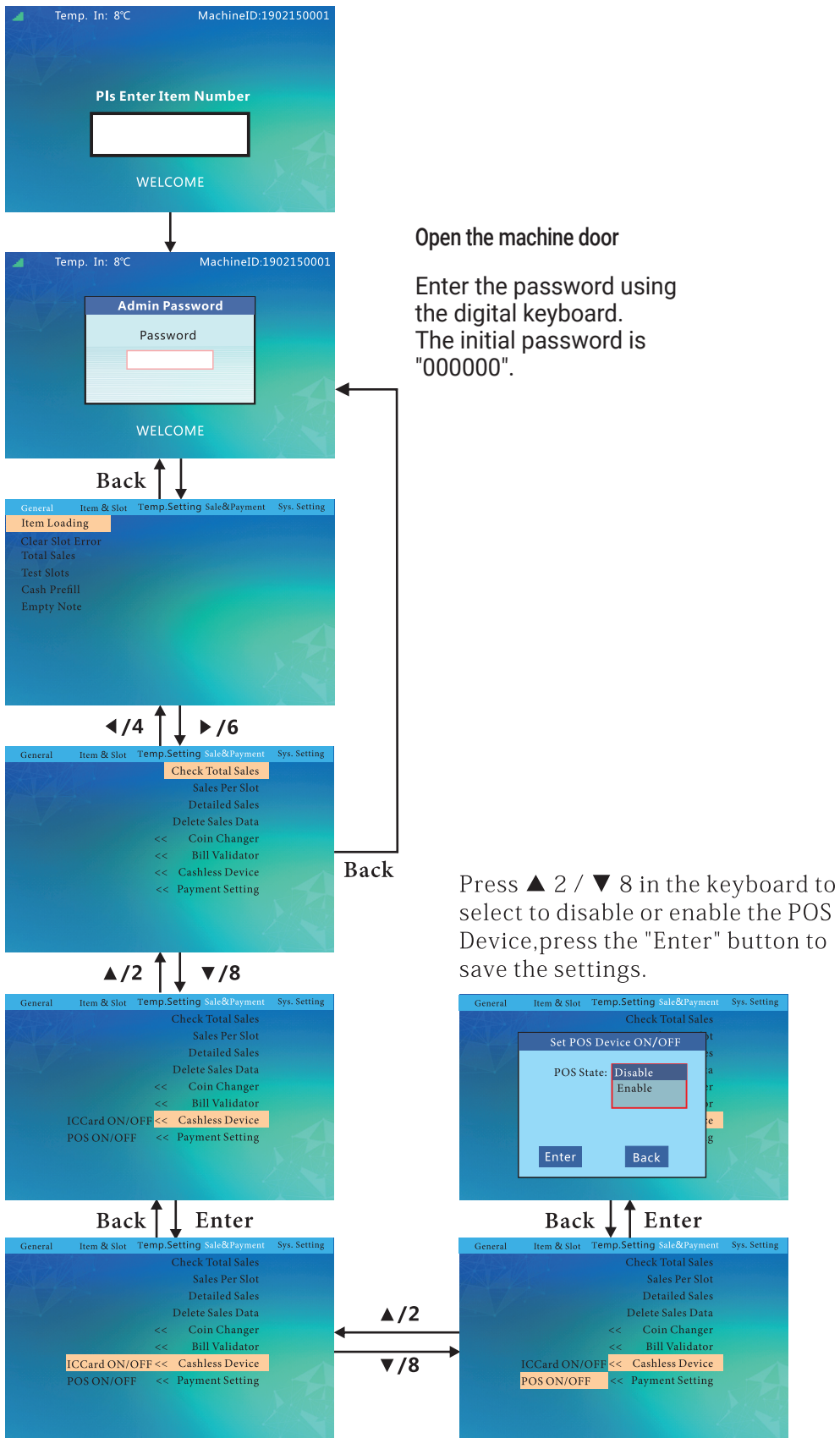

# MENU SETUP FLOWCHART: SET MAX. CREDIT

## SET MAX. CREDIT

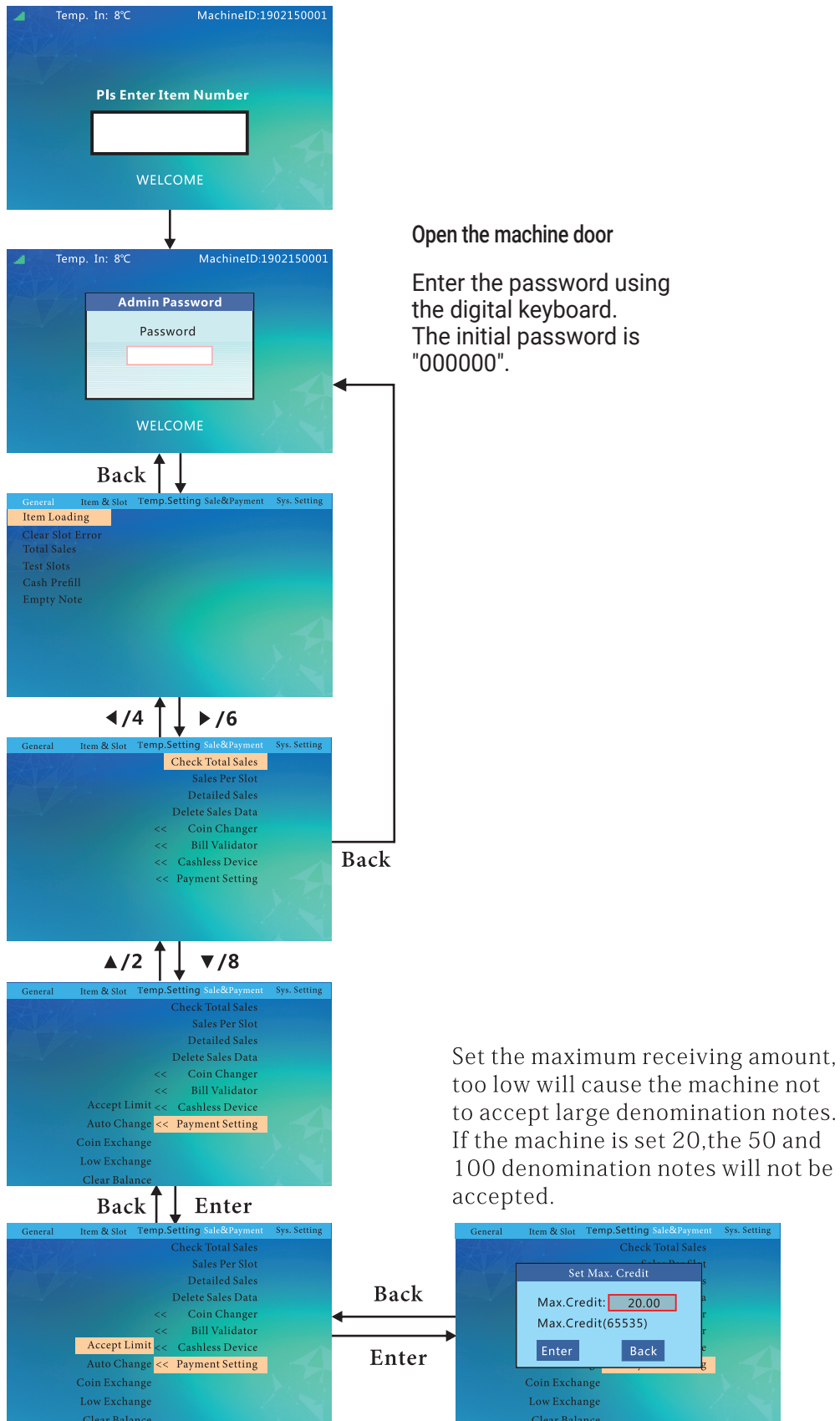

# MENU SETUP FLOWCHART: SET AUTO CHANGE DISPENSING

## SET AUTO CHANGE DISPENSING

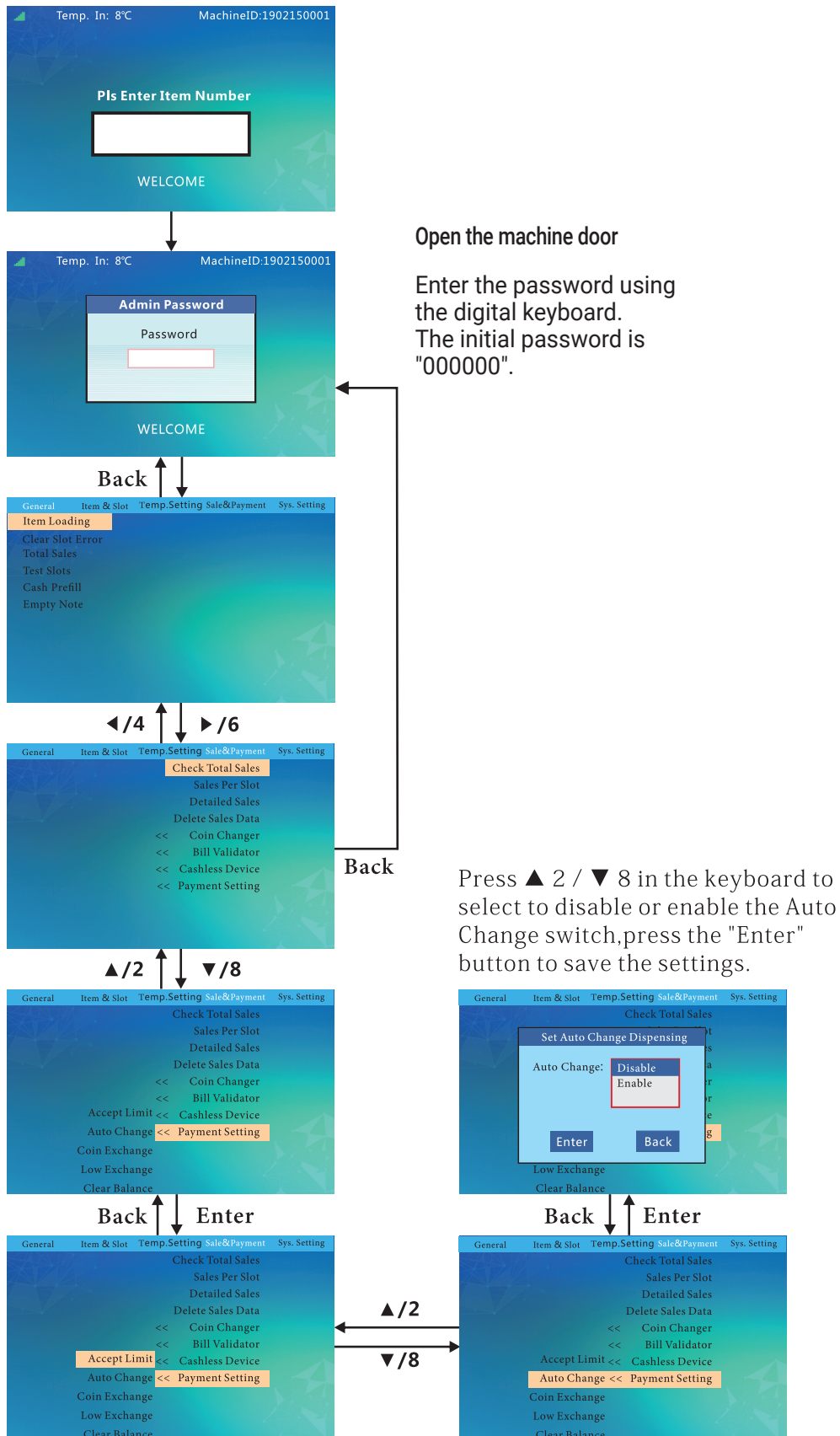

Open the machine door

Enter the password using the digital keyboard. The initial password is "000000".

Press ▲ 2 / ▼ 8 in the keyboard to select to disable or enable the Auto Change switch, press the "Enter" button to save the settings.

# MENU SETUP FLOWCHART: SET COIN EXCHANGE WITHOUT SALE

## SET COIN EXCHANGE WITHOUT SALE

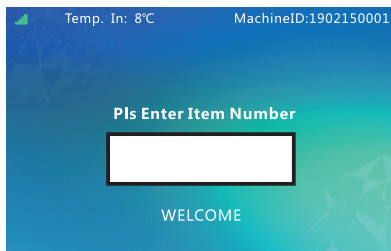

Open the machine door

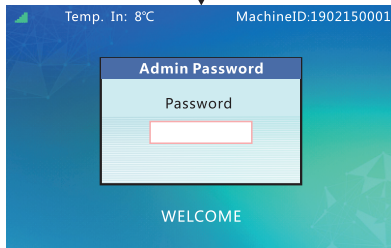

Enter the password using the digital keyboard. The initial password is "000000".

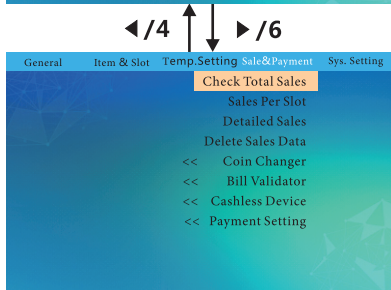
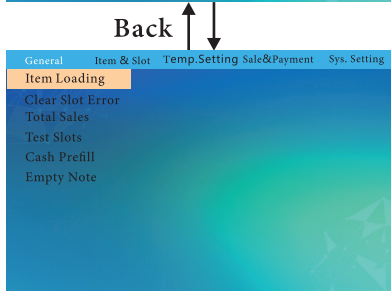

Press ▲ 2 / ▼ 8 in the keyboard to select to disable or enable the Coin Exchange Without Sale switch, press the "Enter" button to save the settings.

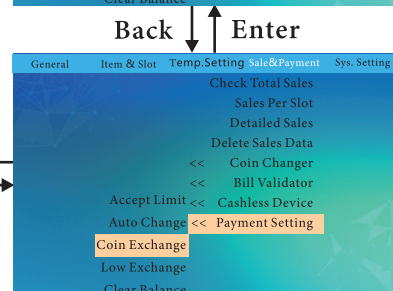
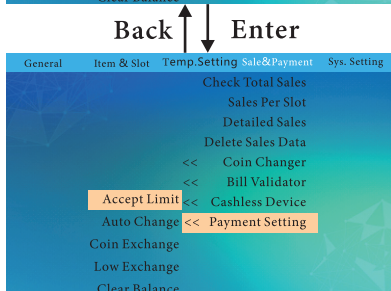
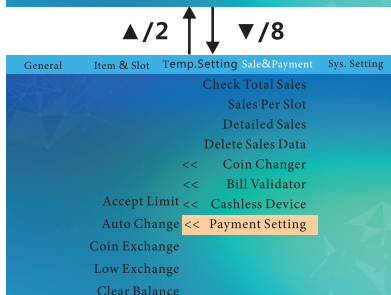

# MENU SETUP FLOWCHART: SET LOW CHANGE

## SET LOW CHANGE

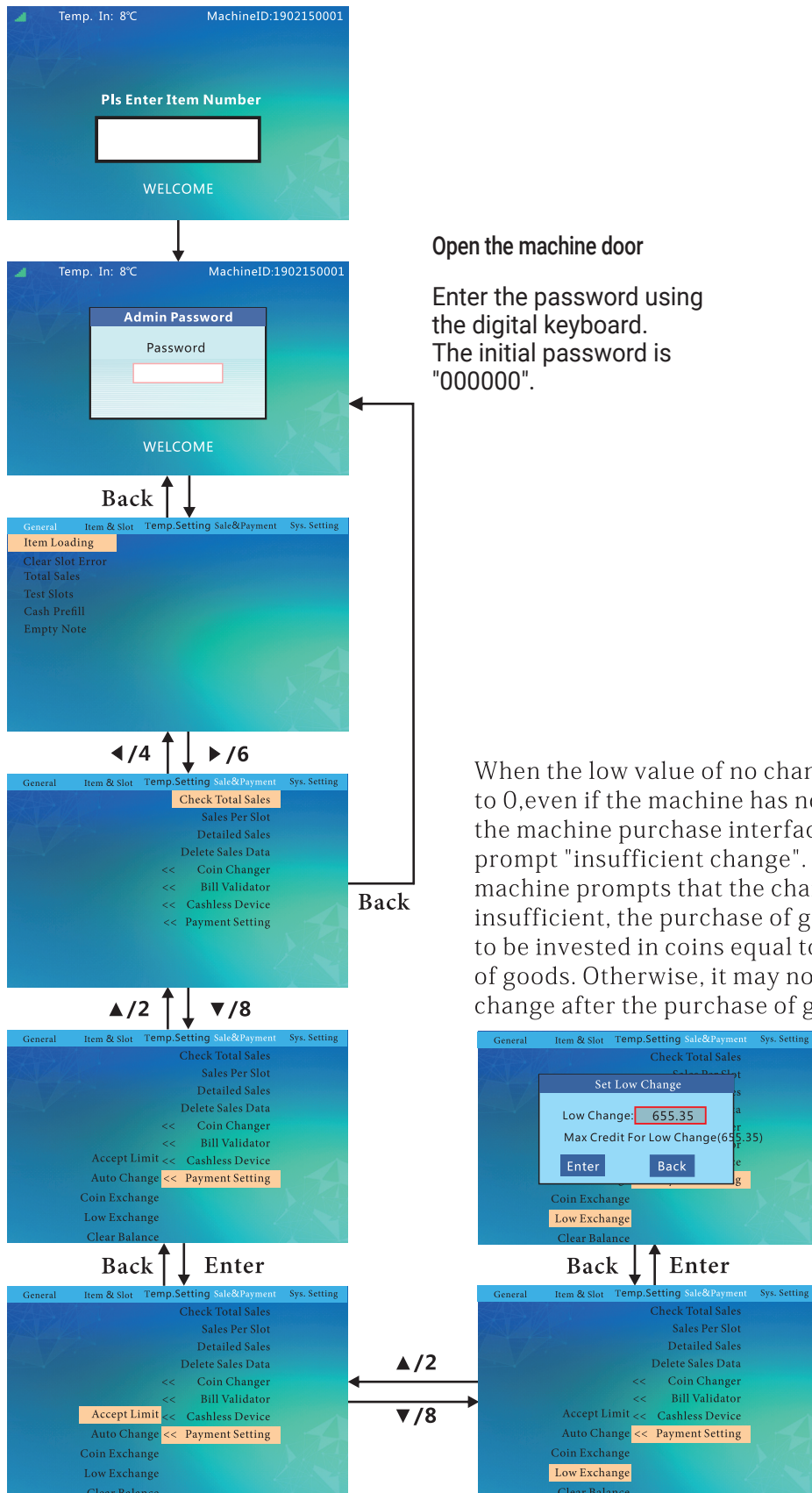

Open the machine door

Enter the password using the digital keyboard. The initial password is "000000".

When the low value of no change is set to 0, even if the machine has no change, the machine purchase interface will not prompt "insufficient change". When the machine prompts that the change is insufficient, the purchase of goods needs to be invested in coins equal to the price of goods. Otherwise, it may not give the change after the purchase of goods.

# MENU SETUP FLOWCHART: AUTO CLEAR BALANCE SET UPON TIMEOUT

## AUTO CLEAR BALANCE SET UPON TIMEOUT

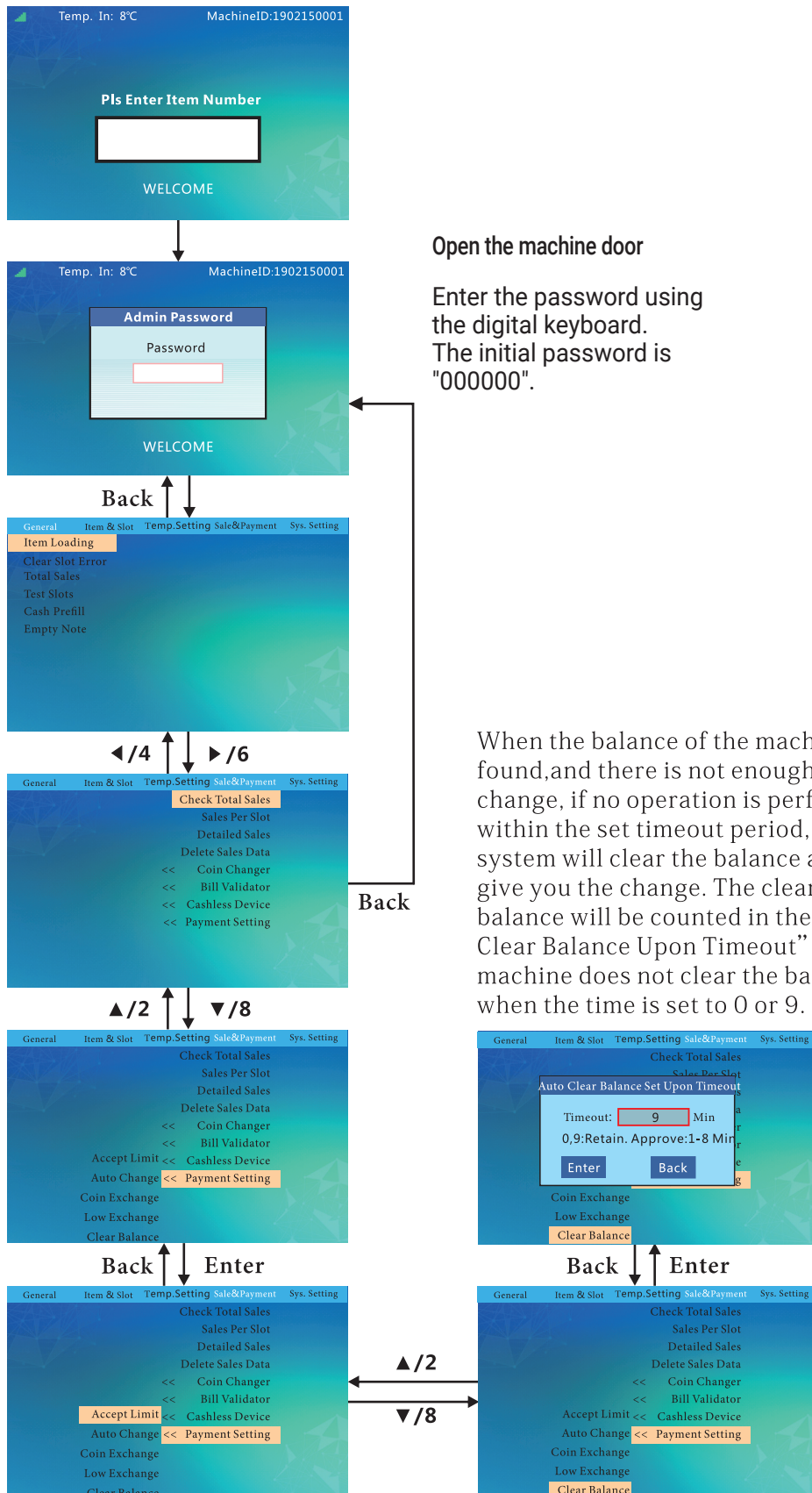

Open the machine door

Enter the password using the digital keyboard. The initial password is "000000".

When the balance of the machine is not found, and there is not enough for change, if no operation is performed within the set timeout period, the system will clear the balance and not give you the change. The cleared balance will be counted in the "Auto Clear Balance Upon Timeout". The machine does not clear the balance when the time is set to 0 or 9.

# MENU SETUP FLOWCHART: SET MULTIPLE VEND ON/OFF

## SET MULTIPLE VEND ON/OFF

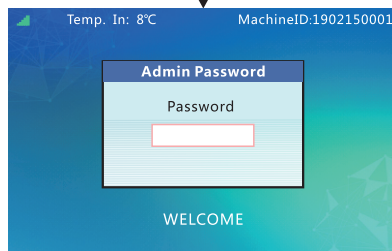
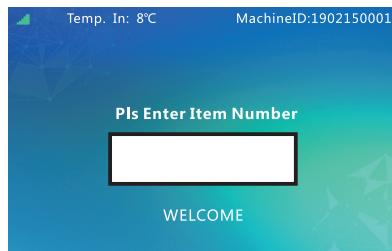

Open the machine door

Enter the password using the digital keyboard. The initial password is "000000".

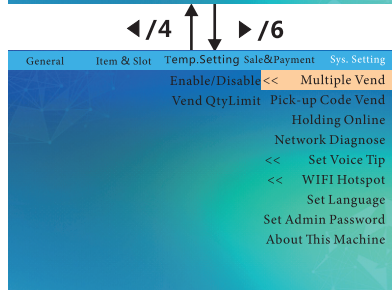
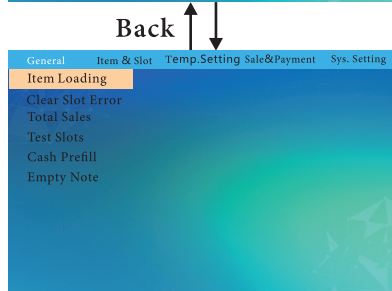

Back

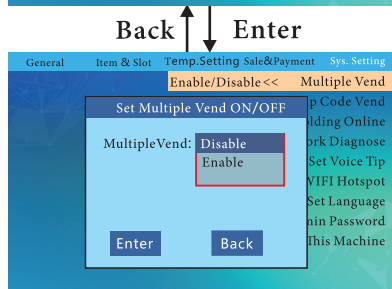

Press ▲ 2 / ▼ 8 in the keyboard to select to disable or enable the shopping cart, press the "Enter" button to save the settings.

# MENU SETUP FLOWCHART: SET MULTIPLE VEND QTY LIMIT

## SET MULTIPLE VEND QTY LIMIT

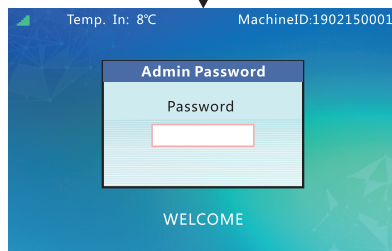
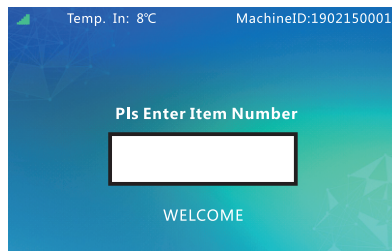

Open the machine door

Enter the password using the digital keyboard. The initial password is "000000".

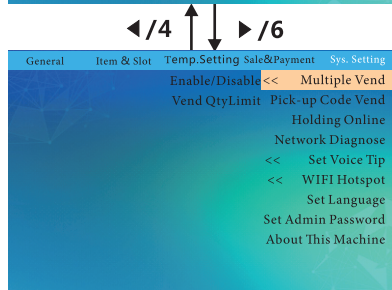
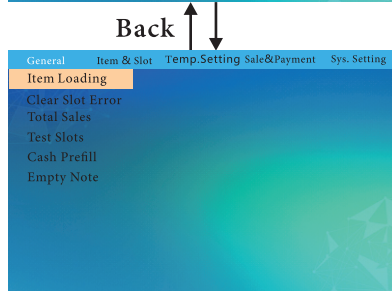

Back



The shopping cart switch must be enabled before setting the number of shopping carts. The maximum number of shopping carts can be set to 5. After the setting is completed, press the "Enter" button to save the settings.

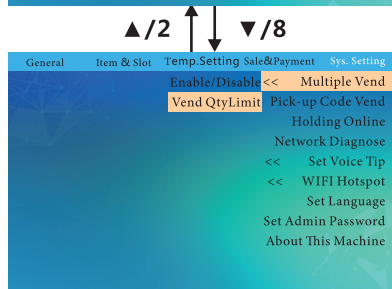

Back

Enter

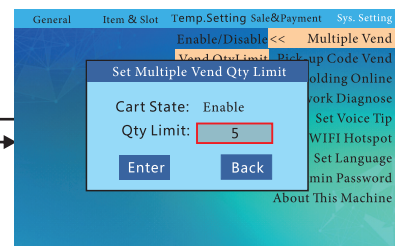



# MENU SETUP FLOWCHART: SET PICKUP CODE

## SET PICKUP CODE ON/OFF

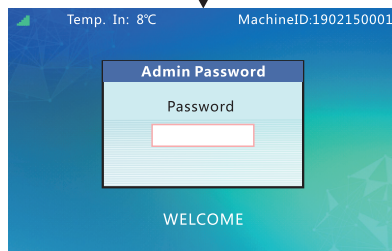

Open the machine door

Enter the password using the digital keyboard. The initial password is "000000".

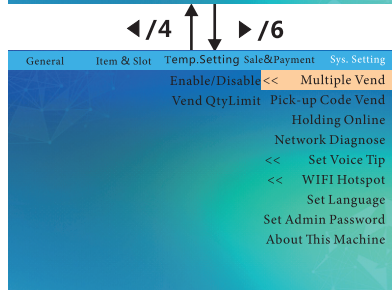
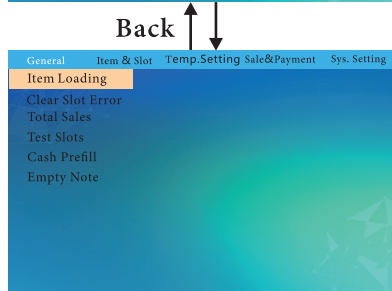

Back

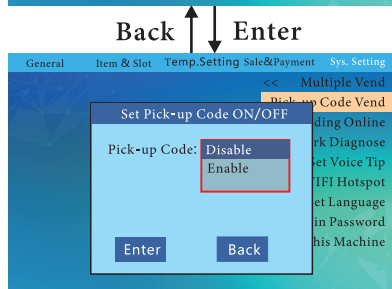
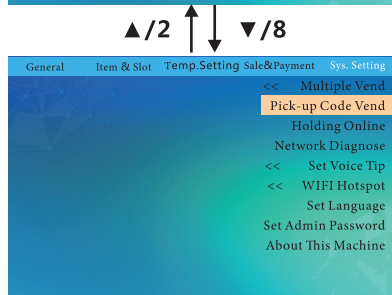

Press ▲ 2 / ▼ 8 in the keyboard to select to disable or enable the pick-up code switch, press the "Enter" button to save the settings.

# MENU SETUP FLOWCHART: INQUIRY SERVER FREQUENCY

## INQUIRY SERVER FREQUENCY

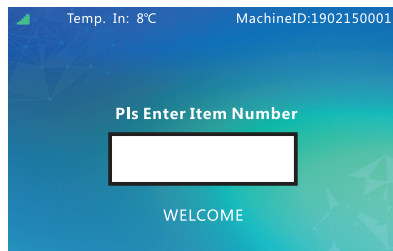

The heartbeat interval is a mechanism to keep online, set to 20 second. The machine shall send an instruction to the server every 20 seconds to synchronize the server online status. The longer the heartbeat interval is set, the more the machine saves traffic, but the longer the state synchronization interval is, the shorter the heartbeat interval is, the real-time update of the machine's status is, but the more traffic is consumed. It is recommended that the heartbeat interval be set a little shorter where the network signal is poor.

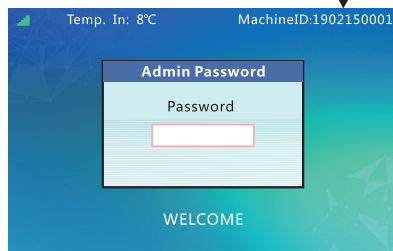

Open the machine door

Enter the password using the digital keyboard. The initial password is "000000".

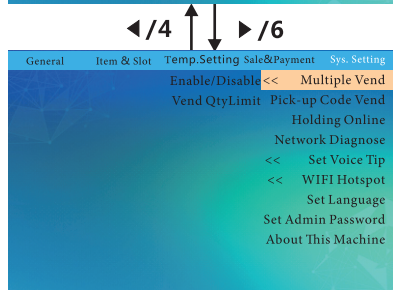
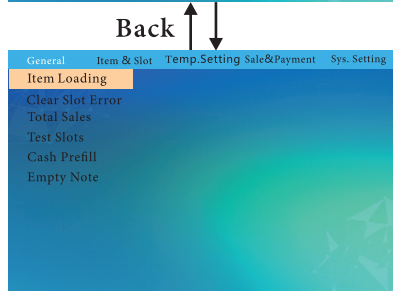

Back

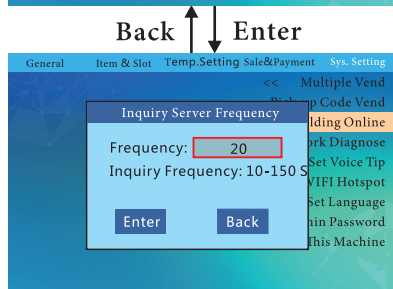
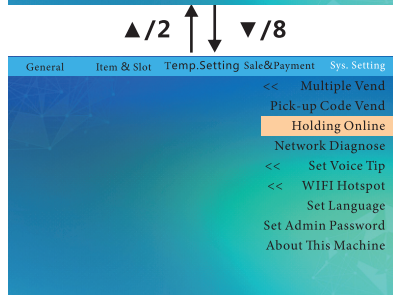

# MENU SETUP FLOWCHART: NETWORK DIAGNOSE

## NETWORK DIAGNOSE

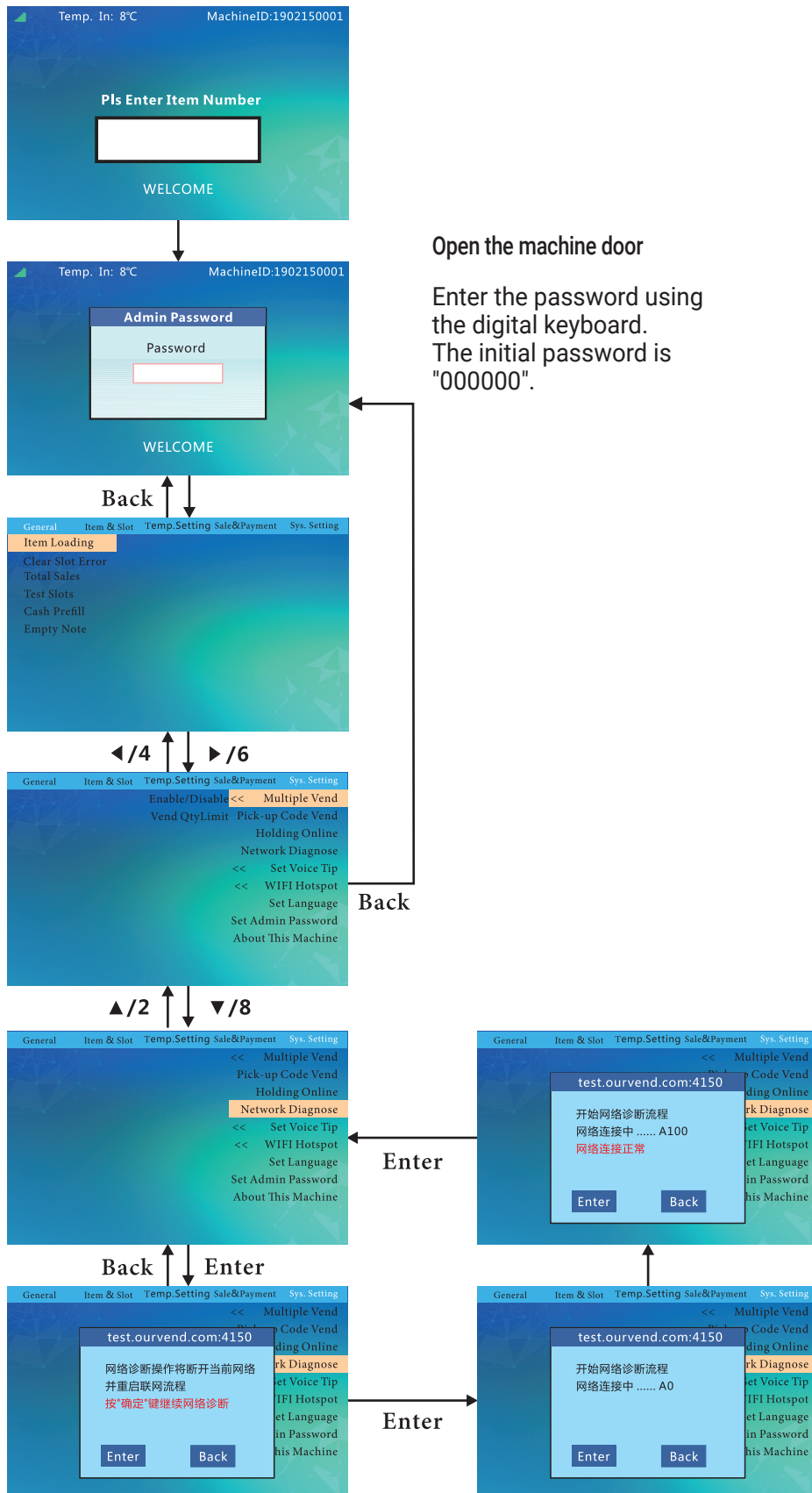

# MENU SETUP FLOWCHART: SET AUDIO GUIDANCE

## SET AUDIO GUIDANCE ON/OFF

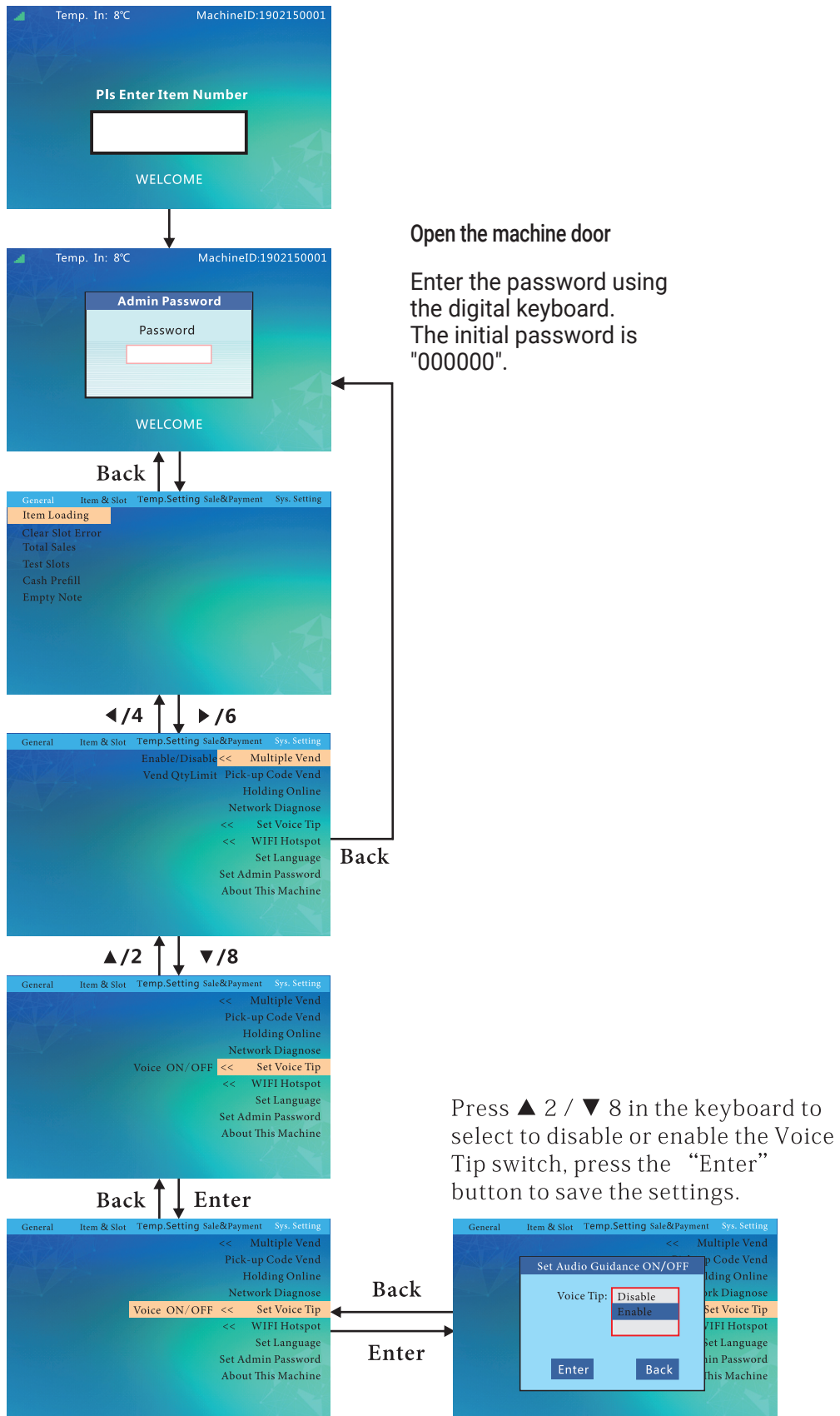

# MENU SETUP FLOWCHART: SET WIFI HOTSPOT

## SET WIFI HOTSPOT ON/OFF

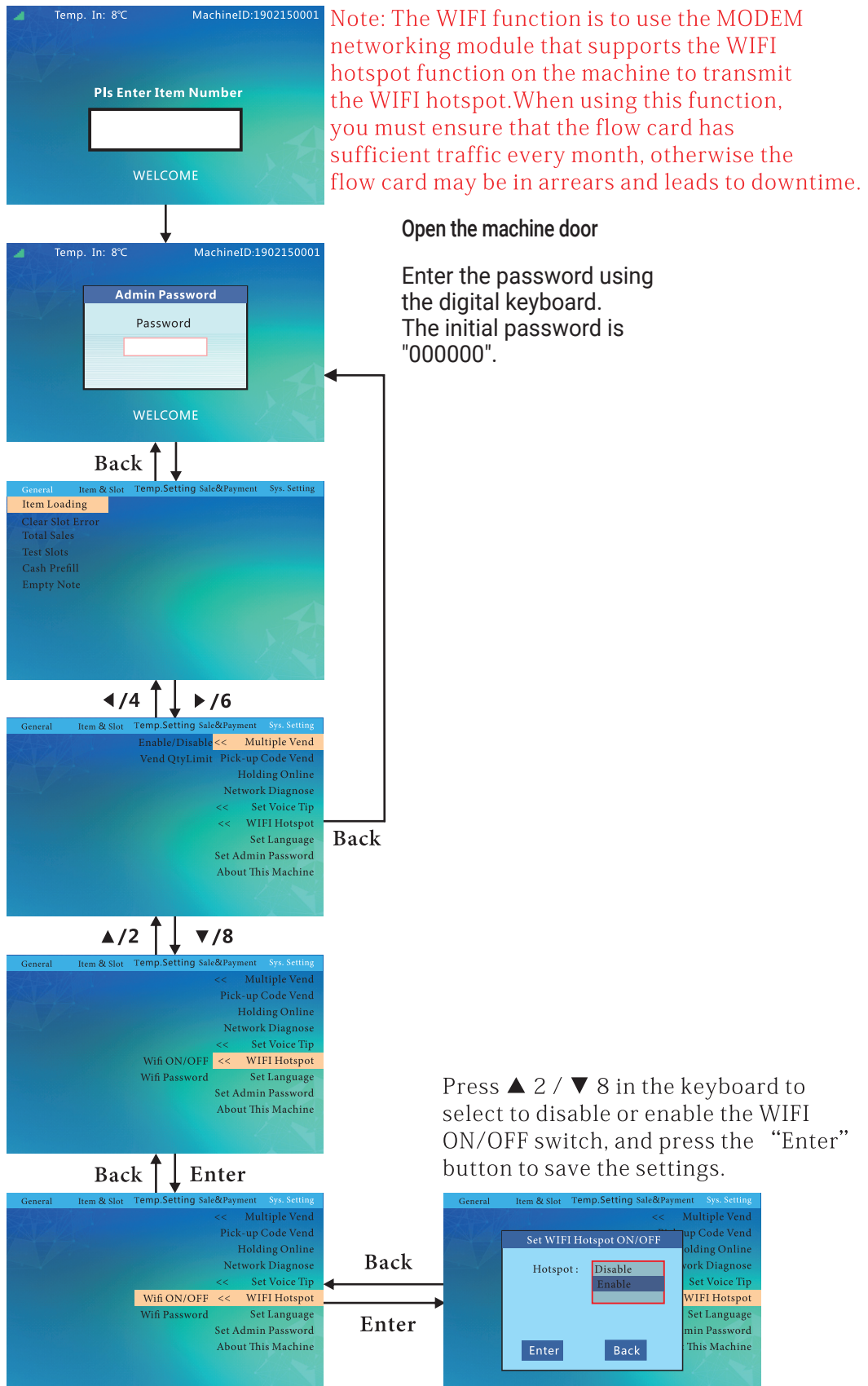

# MENU SETUP FLOWCHART: RESET MODEM WIFI HOTSPOT PASSWORD

## RESET MODEM WIFI HOTSPOT PASSWORD

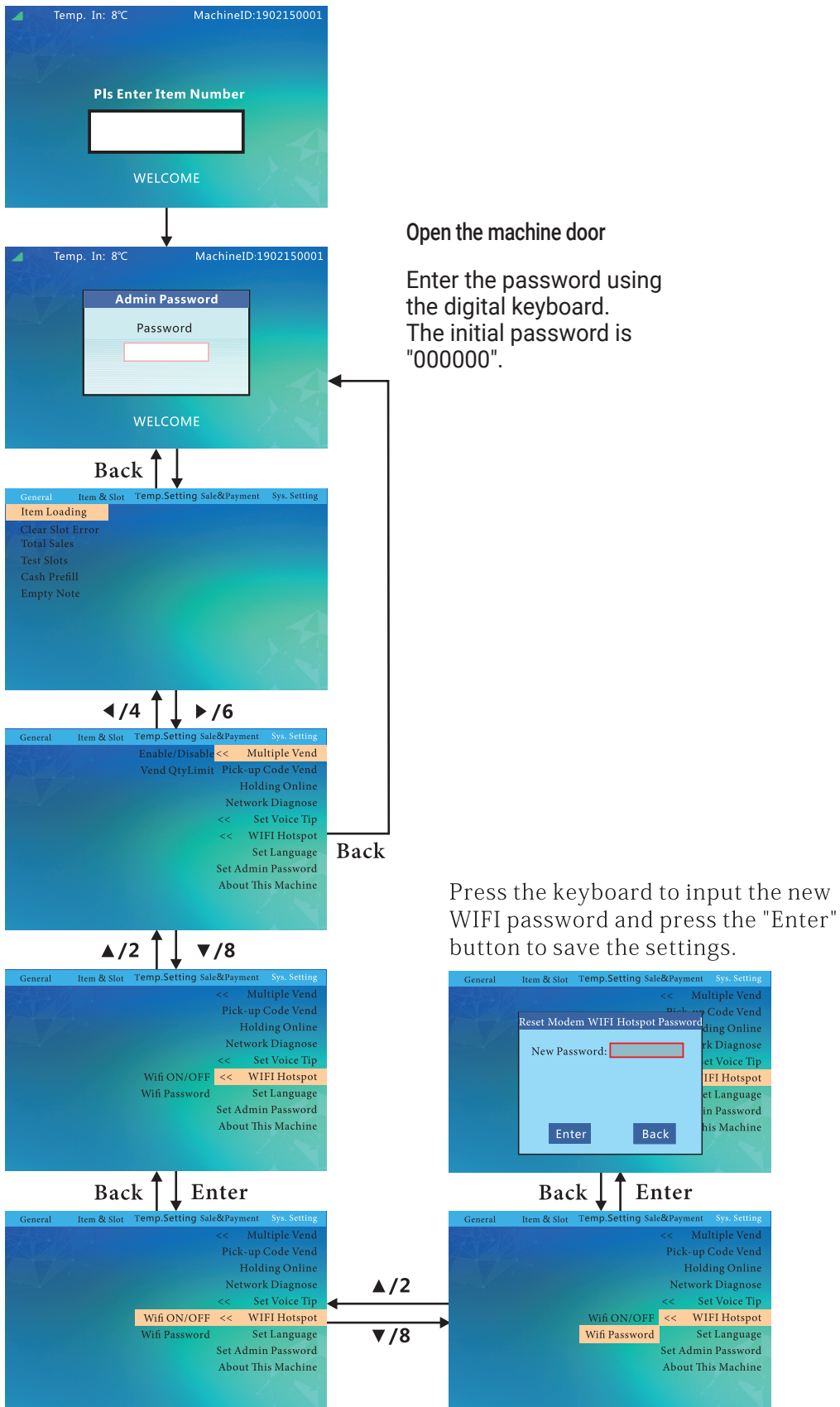

# MENU SETUP FLOWCHART: SET DISPLAY LANGUAGE

## SET DISPLAY LANGUAGE

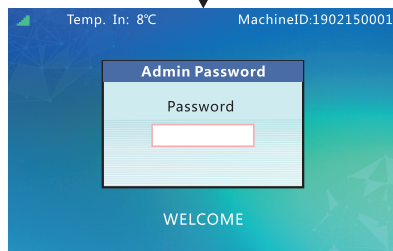
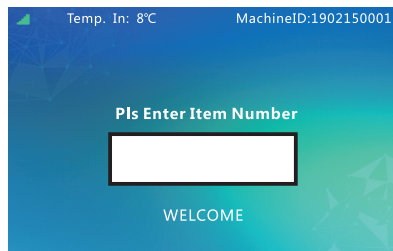

Open the machine door

Enter the password using the digital keyboard. The initial password is "000000".

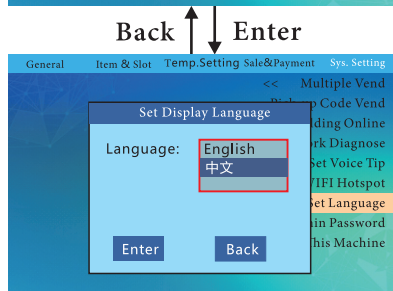
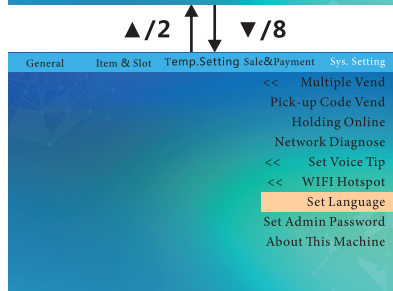
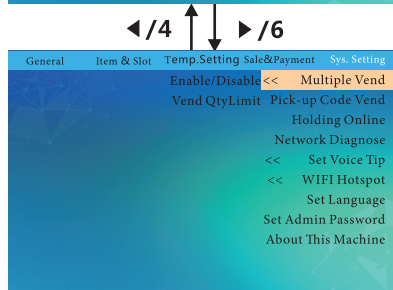
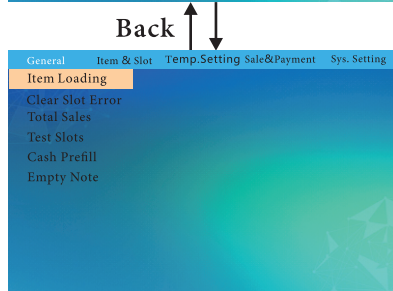

Press ▲ 2 / ▼ 8 in the keyboard to select the language you want to set (currently only supports Chinese and English), press the "OK" button to save the settings.

# MENU SETUP FLOWCHART: RESET ADMIN PASSWORD

## RESET ADMIN PASSWORD

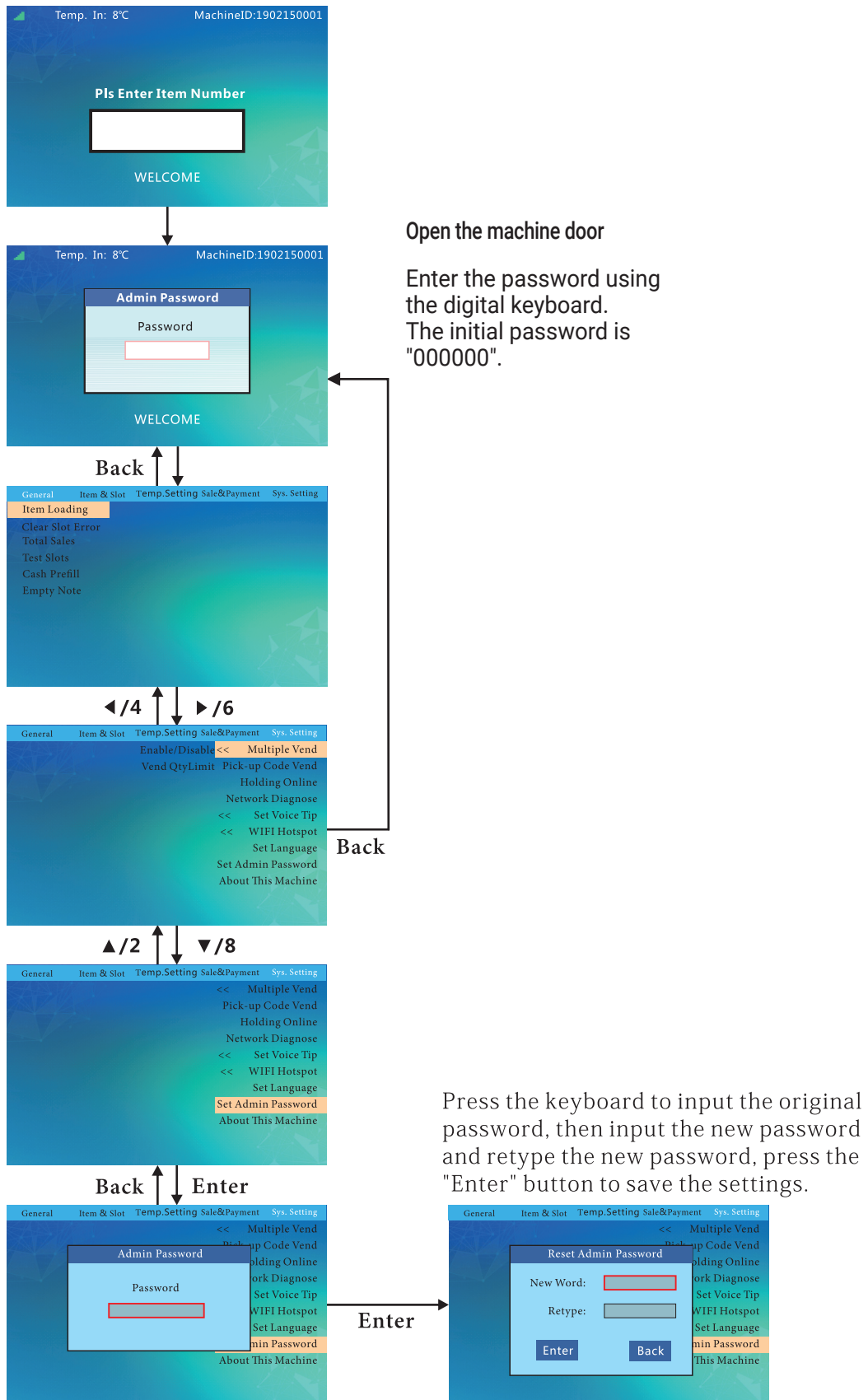



# MENU SETUP FLOWCHART: ABOUT THE MACHINE

## ABOUT THE MACHINE

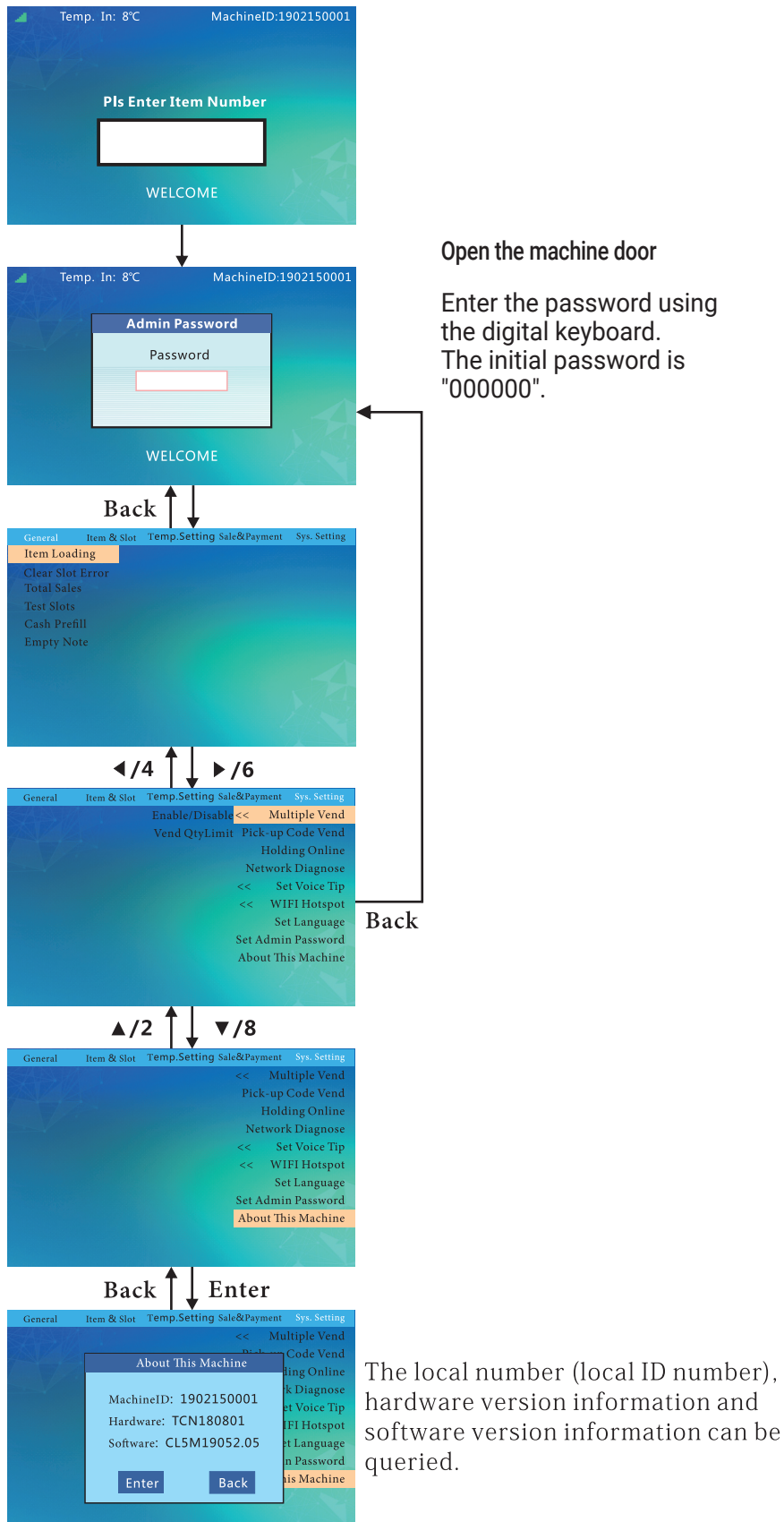

# TROUBLESHOOTING

Fault phenomenon	Possible causes	Approach
The machine has no power.	The power switch is not turned on	Turn on the machine power switch
	The insurance tube burned out	Check the machine to make sure the machine is not short-circuited and replace the insurance tube of same specifications
	The leakage protection switch is OFF	Check the machine to ensure that no leakage occurs and turn on the leakage protection switch
	The power plug wire is damaged	Look for professionals to replace power plugs
	220V power is not connected	Check power supply lines to make 220V power supply normally connected
Not connected to the Internet	No Signal	1. Power off and restart the machine
		2. Check if the antenna connection is installed correctly and the antenna extension cable is intact.
		3. Confirm that whether the antenna is placed on top of the machine.
		4. Replace the flow card of different operators (not support the TELECOM for the time being)
		5. Change the position of the machine (maybe no network signal in that area)
Excessive traffic or downtime of card	Recharge the flow card	
Flow card locked	Contact the background to unlock, the flow card can only be bound to the specified machine, otherwise the card may be locked	
Lighting strip does not work	Lighting strip not turned on	Turn on the lighting strip
	Loose contact of lighting strip	Check the sockets of the lighting strip and re-plug the sockets
	The light strip is damaged	Contact with after-sales, change the lighting strip
Unable to choose cargo lane	Cargo lane failure not cleared up	Clear up cargo lane failures
Delivery failure	The cloud background is inconsistent with the product code set in the machine.	Match the cloud background and the machine's product encoding settings or enable cloud synchronization
	Product size does not match the cargo lane	Replacement of goods matching the cargo lane or adjustment of the cargo lane to the appropriate size of the goods
	Cargo lane capacity setting error	Clear the cargo lane failures and reset the correct cargo lane capacity
The machine does not refrigerate	Refrigeration not turned on	Turn on the refrigeration (see the page of "SetTemperature Control Mode" in the Manual for details)
	Long-term use of the machine may lead to	Contact with after-sales, add refrigerant
Failure to reach the preset temperature	Too much dust in condenser	Clean the condenser with a non-metallic brush (pay attention to regular maintenance and cleaning)
	Not enough time to cool the goods	Pre-cooling goods in advance when they are popular
	High ambient temperature due to direct sunlight or other heat sources around the machine	Changing the placement environment of the machine
	Poor ventilation of the machine	Guarantee the clearance of 20 cm or above from the rear and left and right sides of the machine, and ensure the good ventilation of the machine.

# TROUBLESHOOTING

Fault phenomenon	Possible causes	Approach
Not accept coins	The power supply of the coin system is abnormal	1. Check whether the MDB line is in good contact; 2. Check whether there is DC24V access to coin changer and bill validator.
	Software disabled	1. The enables of coin type is not on, turn on the corresponding enables; 2. The enables of bill type is not on, turn on the corresponding nables;
	Be subjected to high requency interference	Remove high frequency interference (e.g. antenna, etc.).
	Installation of coin system is abnormal	1. The coin changer is not hanging correctly, reinstall the coin changer;
		2. The coin return button of the coin changer can not be pressed,which leads to no recovery. Correct the coin return press plate to ensure that the coin return button can recover normally.
	Dirty coin passage	Clean the passage of the coin system.
	No coin recycle can be etected	If the trouble can not be eliminated by reinstall the coin recycle,please return the machine to the factory for repair.
	Do not accept large nomination notes	1. Set the limit value of put-in amount too low, reset the limit of putin amount;
2. Set the acceptable coin value is too high, the user may empty the coin hange area after purchasing the goods, sulting in the followup users can not get the change.		
Failure of bill jammed	Clear up the jammed bill.	
No change	Abnormal power supply	1. Check whether the MDB line is in good contact;
		2. Check whether the coin system has DC24V access.
	Software disabled	1. The coin change switch is not turned on.
		2. Bill temporary storage switch is not on.
	There's no money in the coin recycle	Prefill coins.
	No change due to the low exchange setting is wrong	When the value of put-in bill is too large, the setting of no change low value limit is too low, it is necessary to reset no change low value limit and supplement coins in the coin recycle.
	No change for bills	Empty the bill change area and refill the coins.
The coin changer has a problem of bill jam (the indicator light on the coin returning slot flashes)	1. Check whether coins are erected in the coin recycle, and if they are erected, reload the coins.	
	2. Check whether the surface of the coin is deformed or foreign body, change the coins or remove foreign body;	
	3. Check whether the coin recycle is detached. If it is detached, please reinstall the coin recycle.	
	4. Check that whether the coin return claw is damaged or not. If it is damaged, please return to the factory for repair.	
	5. The base of the coin changer is not in place. Re-install the coin changer base.	

# CLEANING INSPECTION TIME AND CONTENT

Content		Cycle	Cleaning inspection time		
			When replenishing goods	Once a month	Once every six months
Cleaning	Vending machine exterior		○		
	Pickup slot		○		
	Cargo lane			○	
	Evaporator			○	
	Condenser			○	
	Metal keyboard		○		
	Delivery device			○	
	Panel		○		
Inspection	Leakage protection			○	
	LED Light			○	
	Set installation status				○

## Cleaning of vending machines

1. When the machine is dusty, wipe it with a dry cloth.
2. If the dirt is serious, wipe it with cloth dampened with water or diluted neutral detergent solution.
3. Do not use organic solvent or acid or alkaline liquid to clean, otherwise the panel may be cracked.
4. When removing the dirt from the vending machine, do not use chemical solvents such as paint solvents and banana water to avoid accidents.
5. The evaporator and condenser should be cleaned regularly with water every month. If necessary, rinse with water (refer to sticker of “Refrigerator Cleaning Guide” on the fuselage for details).
6. Open the machine door, undo the power plug, remove the bezel or the cargo bucket, and clean the dust with a non-metallic brush along the gap of the radiator.

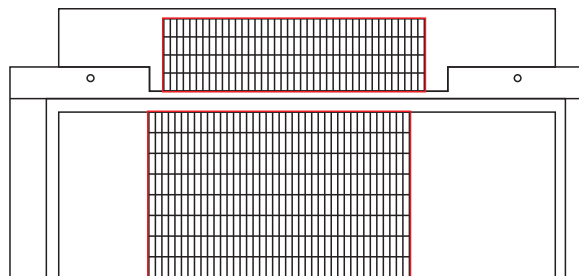

Cleaning area of refrigeration system

## Test Leakage Protection Switch

1. Press the test switch of the power plug. When the power indicator is off and the machine is powered off, it must be tested once a month.
2. If it is normal after the test, press the plug switch to turn on the power after 3 minutes.

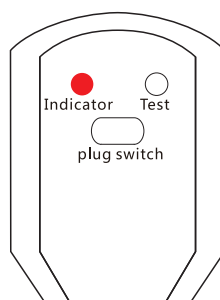

# REFRIGERATION SYSTEM CLEANING & D-TYPE REFRIGERATOR CLEANING

## REFRIGERATION SYSTEM CLEANING

1. Turn off the power switch



2. Undo the power supply plug



3. Rotate the sealing cover clockwise. When the sealing cover can no longer be rotated, the sealing cover can be removed outward.

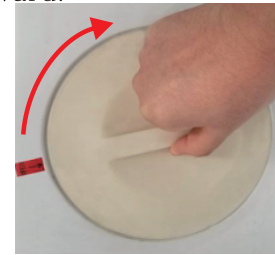

4. Clean up the dust from top to bottom with a soft brush (not a metal brush) along the gap of radiator.

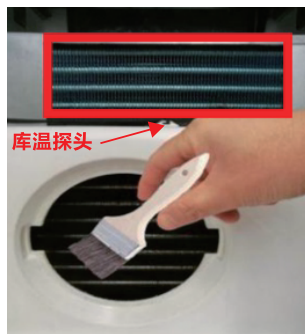

5. After cleaning, fasten both sides of the sealing cover to the notch, rotate half circle counterclockwise and fix the sealing cover.

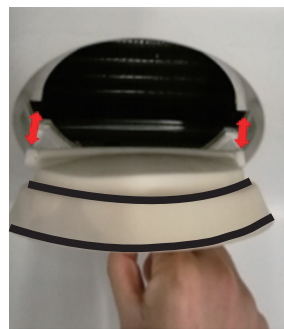

## D-TYPE REFRIGERATOR CLEANING

1. Turn off the power switch



2. Undo the power supply plug, and open the machine door



3. Turn off the fixing screw counterclockwise with the large flat screwdriver



4. Remove baffle and insulating tin foil

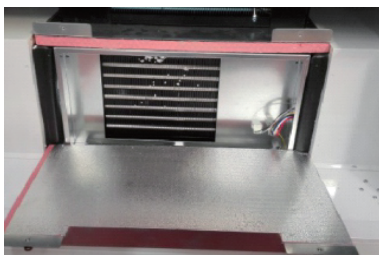

5. Clean up the dust with a nonmetallic soft brush the gap of the radiator.

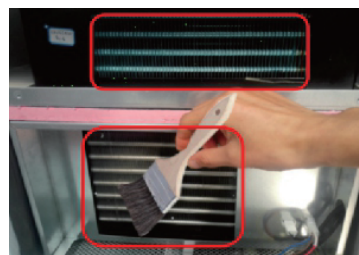

6. After cleaning is completed, close the baffle and tighten it with screws.



Note: When cleaning evaporator, please pay attention to not let the temperature probe touch the radiator and inner metal part of the evaporator. It should be fixed on the water-containing plate to avoid affecting the cold storage temperature.

# MERGED CARGO LANE OPERATION & ADJUSTMENT OF LAYER HEIGHT

## MERGED CARGO LANE OPERATION

1. Cut the tie-up cable, pull out the tray and disconnect the terminal behind the tray.



2. Unscrew the spring on the right side of the cargo lane to be merged, disassemble the middle baffle screw of the cargo lane to be merged (the plastic baffle can be pushed directly inward and removed) and remove the baffle. Note: the baffle fixed by rivets does not support the merged cargo lane.

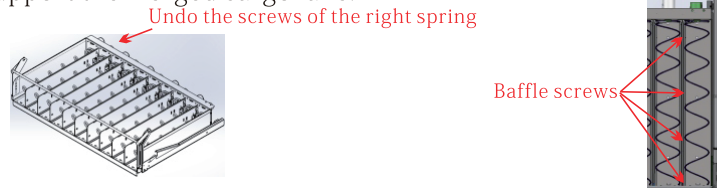

3. Disassemble the right spring and replace it with the right-handed spring. Remove the price tag of the right cargo lane and use the price tag of the left lane (for example, after the merger of 141 lane and 142 lane, the merged lane is 141).

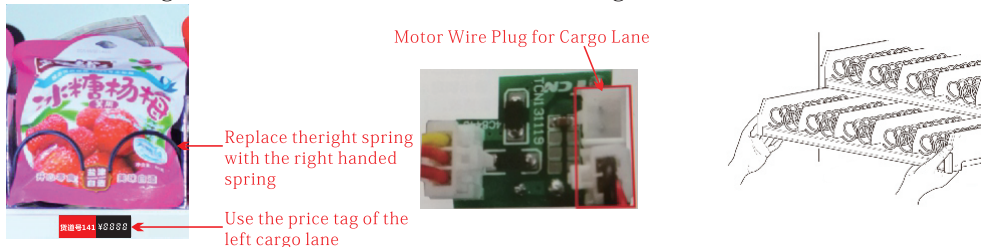

4. Pull out the plug of the motor wire on the right side of the cargo lane and insert it into another jack. Connect the merged tray to the terminal, arrange and bind the wiring harness and push it into the main cabinet. At the same time, set the corresponding lane into the merged lane in the software menu.

## ADJUSTMENT OF LAYER HEIGHT

1. Cut the tie-up cable, pull out the tray and disconnect the terminal behind the tray.



2. Use screwdriver to loosen and remove the screws of the cargo lane slide rail. Adjust the slide rail to the appropriate height and fix it with screws (Note: the height of the slide rail on both sides must be the same).

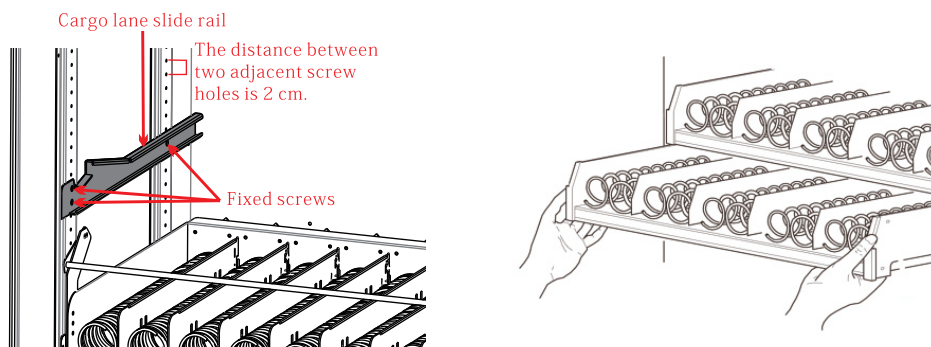

3. Connect the tray terminals, tidy up and bind the lane wiring harness, and push the lane into the main cabinet.

# ACCESSORIES INSTALLATION INSTRUCTIONS

## Installation Of Blocking Device

Installation of the blocking device is to prevent higher products from dumping forward, and the upper end of item is against the glass when delivery, which causes the spring to be unable to push the goods out of the lane.

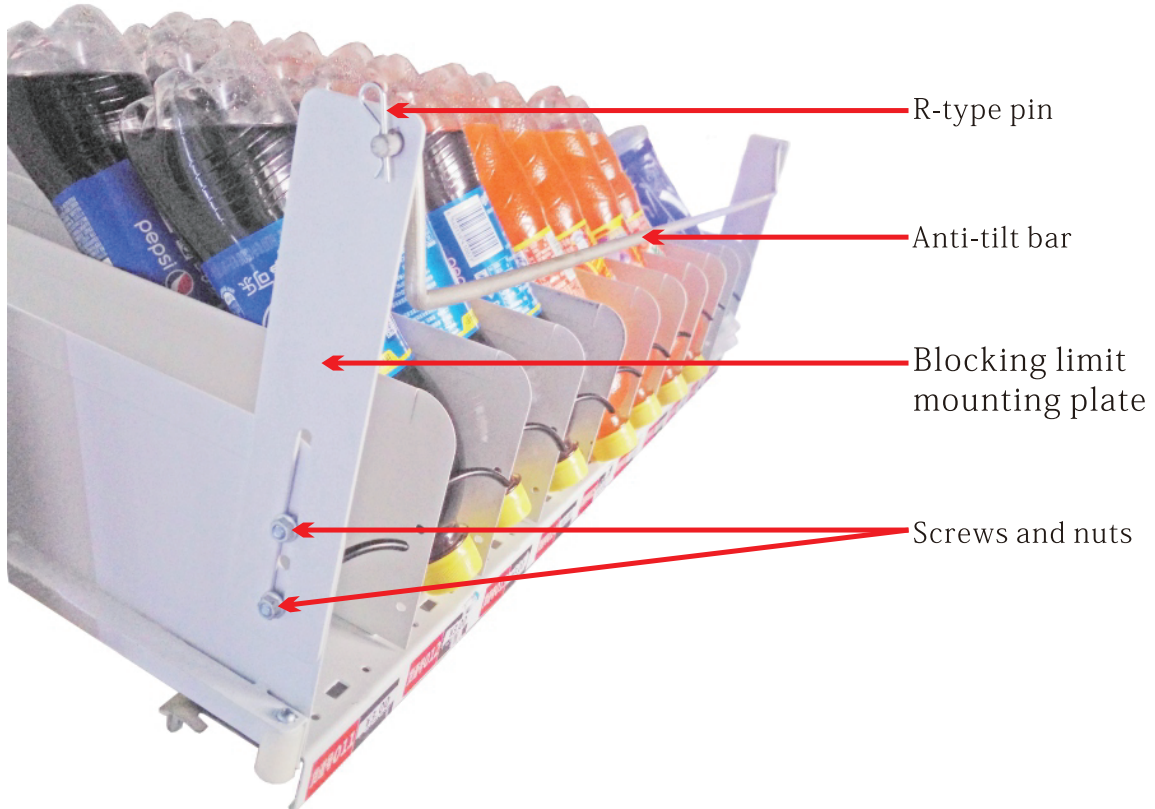

## Installation Of Spring Front End

The front end of the spring is used for some cargo lanes placing thinner goods when the goods can not be pushed out at one time.

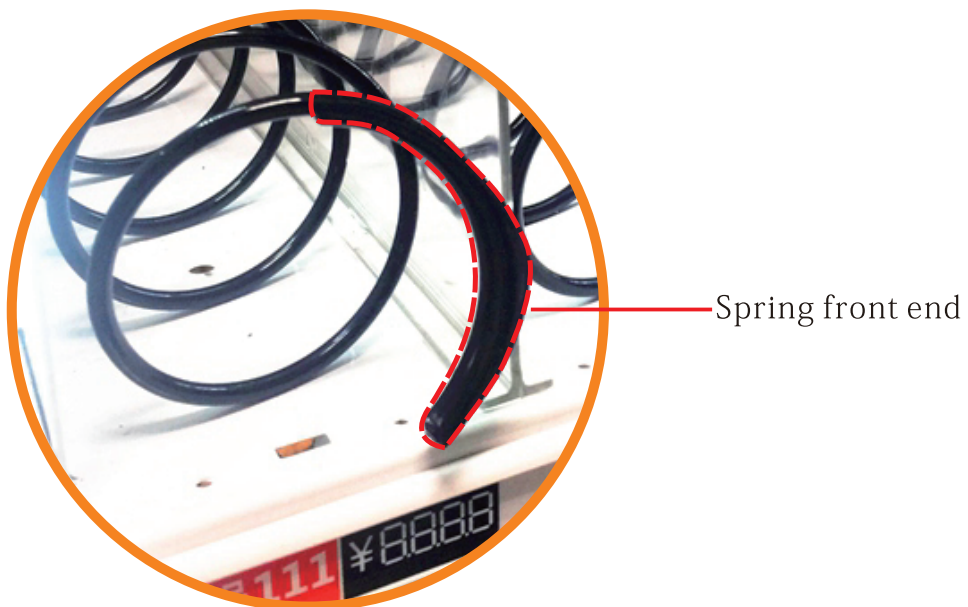



# WARRANTY

## LIMITED WARRANTY

---

LIMITED WARRANTY KOOLMORE SUPPLY, INC. warrants to the original consumer or purchaser this KOOLMORE product is free from defects in material or workmanship for a period of One (1) year from the date of purchase. If any such defect is discovered within the warranty period, KOOLMORE SUPPLY, INC., at its discretion, will repair or replace the product at no cost or pay for replacement parts and repair labor to correct defects in materials or workmanship that existed when this major appliance was purchased or that are the result of normal usage when this major appliance is installed, operated and maintained according to instructions attached to or furnished with the product, At its sole discretion. Koolmore Supply Inc may determine to replace the product. In the event of product replacement, your appliance will be warranted for the remaining term of the original unit's warranty period.

This limited warranty is good only to the original purchaser of the product and effective only when used in the United States.

This limited warranty is effective from the date of original consumer purchase. Proof of original purchase date is required to obtain service under this limited warranty.

YOU'RE SOLE AND EXCLUSIVE REMEDY UNDER THIS LIMITED WARRANTY SHALL BE PRODUCT REPAIR AS PROVIDED HEREIN.

Service must be provided by a Koolmore designated service company.

For warranty or repair service: Email us at [support@koolmore.com](mailto:support@koolmore.com) include your name, address, phone number, warranty repair request, and a copy of your proof of purchase receipt.

You can also visit us at [koolmore.com](http://koolmore.com) and use the contact us page.

KOOLMORE customer service will contact you and arrange prompt service for your appliance.

Thank you for choosing KOOLMORE.

## THIS LIMITED WARRANTY DOES NOT APPLY TO

---

- 1.Failure of product to perform during power failures and interruptions or inadequate electrical service
- 2.Damage caused by transportation or handling.
- 3.Damage caused to the product by accident, vermin, lightning winds, fire, floods, or acts of God.
- 4.Damage resulting from accident, alteration, misuse, abuse, or improper installation, repair, or maintenance. Improper use includes using an external device that alters or converts the voltage or frequency of electricity
- 5.Any unauthorized product modification, repair by unauthorized repair center, or use of non-approved replacement parts.
- 6.Abnormal cleaning and maintenance as described in the user's manual.
- 7.Use of accessories or components that are not compatible with this product.

The cost of repair or replacement under these excluded circumstances shall be borne by the consumer.



