



USER MANUAL

REFRIGERATOR

KoolMore French Door Refrigerator

Models: RERFDSS-22C

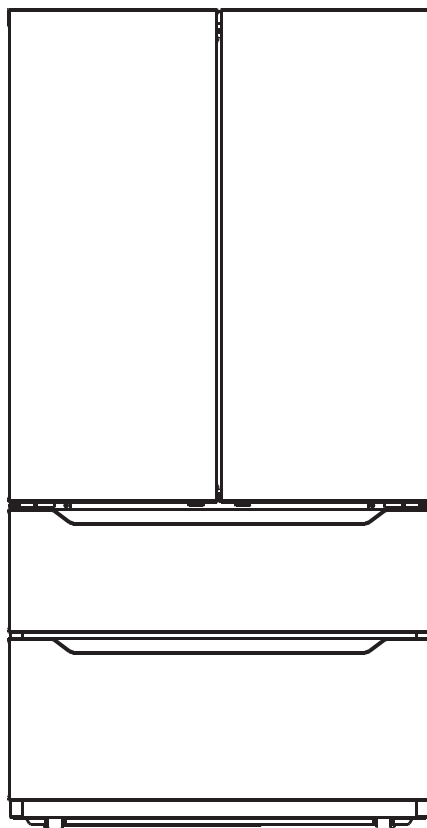

Before using, please read the operating instructions carefully to ensure proper application and achieve satisfactory results.

For any service-related issues, please contact us:



718-576-6342



support@koolmore.com

Stay informed with the latest information for your KoolMore Appliance.

Scan the QR code above to access the most recent user manual on our website, which is constantly being updated and improved.

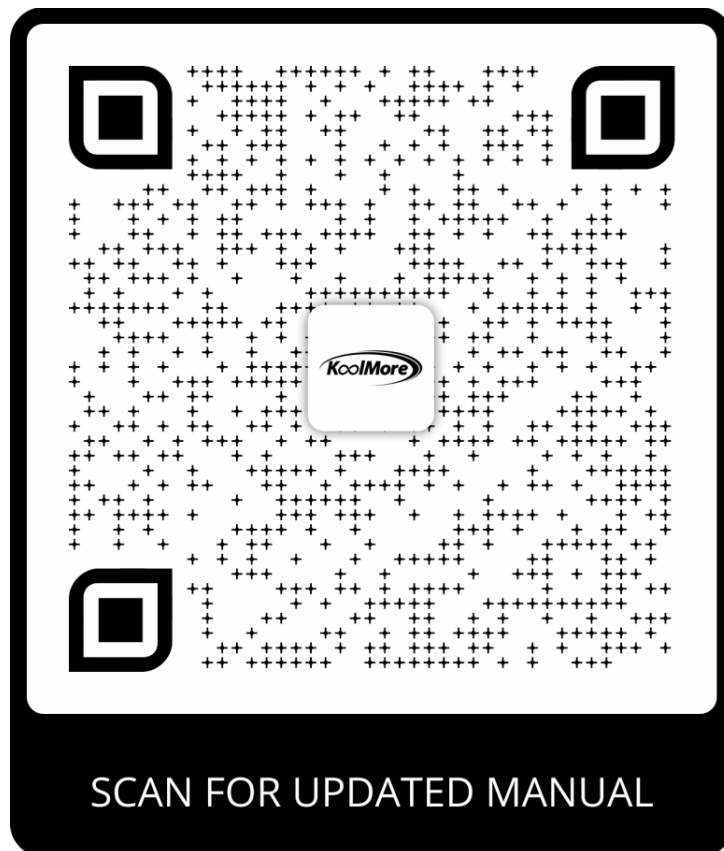

If you need any assistance or have questions, our customer support team is here to help.

P- 718-576-6342 E- Support@koolmore.com

Please write down the model number and serial number below for future reference. Both numbers are located on the rating label on the back of your unit or inside of the unit and are needed to obtain warranty service. You may also want to staple your receipt to this manual as it is the proof of your purchase and may also be needed for service under warranty.

Model Number: _____

Serial Number: _____

Date of Purchase: _____

To better serve you, please do the following before contacting customer service:

If you received a damaged product, immediately contact the retailer or dealer that sold you the product.

Read and follow this instruction manual carefully to help you install, use, and maintain your unit.

Refer to the Troubleshooting section of this manual as it will help you diagnose and solve many common issues.

Safety

Safety	4
Set Up	7
Product Overview	9
Installation	10
Operation	15
Maintenance	18
Troubleshooting	20
Warranty	21

Safety

Intended Use

Before switching on the appliance for the first time, read the following safety information!

This appliance is intended to be used in household and similar applications such as:

- Staff kitchen areas in shops, offices, and other working environments;
- Farmhouses;
- By clients in hotels, motels, and other residential-type environments;
- Bed and breakfast type environments;
- Catering and similar non-retail applications.

If the appliance is used commercially or for purposes other than cooling food, please note that the manufacturer cannot accept any liability for any damage. Modifications or alterations to the unit are not permitted for safety reasons.

Read these operating instructions carefully and attentively before using/ commissioning the unit and keep them in the immediate vicinity of the installation site or unit for later use!



WARNING

Risk of fire / Flammable material

DANGER Risk of fire or explosion. Flammable refrigerant used. Do not use mechanical devices to defrost the refrigerator. Do not puncture refrigerant tubing.

DANGER Risk of fire or explosion. Flammable refrigerant used. To be repaired only by trained service personnel. Use only manufacturer authorized service parts. Any repair equipment used must be designed for flammable refrigerants. Follow all manufacturer repair instructions. Do not puncture refrigerant tubing.



CAUTION

CAUTION! Risk of fire or explosion. Dispose of refrigerator properly in accordance with the applicable federal or local regulations. Flammable refrigerant used.

CAUTION! Risk of fire or explosion due to puncture of refrigerant tubing. Follow handling instructions carefully. Flammable refrigerant used.



WARNING

General safety

Install in accordance with the manufacturer's instructions.

This product should not be recessed or built-in an enclosed cabinet. It is designed for freestanding installation only.

WARNING

- Keep ventilation openings, in the product, clear of obstruction.
- Do not install near any heat sources, such as radiators, heat registers, stoves, or other cooking appliances or in direct sunlight.
- Do not store or use gasoline or any flammable liquids inside or in the vicinity of this refrigerator.
- Do not store explosive substances such as aerosol cans with a flammable propellant in this appliance.
- Do not use electrical appliances inside the food storage compartments of the appliance, unless they are of the type recommended by the manufacturer.
- Do not use mechanical devices or other means to accelerate the defrosting process, other than those recommended by the manufacturer.
- This appliance is not intended for use by persons (including children) with reduced physical, sensory or mental capabilities, or lack of experience and knowledge, unless they have been given supervision or instruction concerning use of the appliance by a person responsible for their safety.

WARNING

Electrical safety

Incorrect electrical installation or excessive mains voltage can lead to electric shocks!

- Only connect your fridge-freezer to a properly installed earthed socket if the mains voltage of the socket corresponds to the specification on the rating label.
- Please use a dedicated power outlet. Do not share power outlet with other electrical appliances. Do not use an extension cord, power-strip, ungrounded (two-pin) adapters or similar devices.
- Make sure that all electrical cables outside the appliance are protected from damage (e.g., by animals or sharp edges).
- Do not locate multiple portable socket outlets or portable power supplies at the rear of the appliance.
- Improper power supply may result in fire or electric shocks.
- Avoid electrical overload. Disconnect the main plug from the main socket before carrying out care, maintenance and repair work on the unit.
- Switch off the unit and disconnect the mains plug from the mains socket when you are not using the unit.
- Do not pull the power cord to disconnect from the outlet. Please firmly grasp the plug and pull it out from the socket directly.
- Ensure the plug is firmly seated in the power outlet to ensure a proper connection. Loose fitting or improperly seated plugs pose a fire hazard.
- In the event of a gas leak, first close the gas valve, then open the doors and windows to provide proper ventilation. Do not disconnect the power cord from the outlet at this time to avoid an electric spark potentially igniting the flammable gas.
- If the supply cord is damaged, it must be replaced by the manufacturer, its service agent or similarly qualified persons in order to avoid a hazard.
- When positioning the appliance, ensure the supply cord is not trapped or damaged.
- If the products are equipped with LEDs, do not remove the lighting cover and LED yourself. Any replacement or maintenance of the LED lamps is intended to be made by the manufacturer, its service agent or similar qualified person.
- This product is not recommended for use with sockets or main switch with the AFCI/GFCI function, otherwise it may cause false tripping.
- The product does not pose a safety risk when tripped, but if tripping persists, it is recommended to

replace the socket or main switch without AFCI/GFCI function.



WARNING

Child safety

- Children should be supervised to ensure that they do not play with the appliance.
- Destroy carton, plastic bags, and any exterior wrapping material immediately after the product is unpacked.
- Children should never use these items to play. Cartons covered with rugs, bedspreads, plastic sheets or stretch wrap may become airtight chambers, and can quickly cause suffocation.
- Remove all staples from the carton. Staples can cause severe cuts and destroy finishes if they come in contact with other appliances or furniture.

Risk of child entrapment. Before you throw away your old refrigerator or freezer:

1. Take off the doors.
2. Leave the shelves in place so that children may not easily climb inside.



CAUTION

Risk of injury and damage!

Never put frozen food in your mouth immediately after taking it out of the freezer.

Avoid prolonged skin contact with frozen food, ice and the pipes in the freezer compartment.

Do not store explosive substances such as aerosol cans with a flammable propellant in this appliance. Also do not place flammable products near the appliance.

Do not store beer, drinks or other liquids in bottles or tightly closed containers in the freezer compartment!



WARNING

State of California Proposition 65 Warnings:

This product can expose you to chemicals including lead, which is known to the State of California to cause cancer, and bisphenol A (BPA) and lead which are known to the State of California to cause birth defects or other reproductive harm. For more information go to www.P65Warnings.ca.gov.



CAUTION

To avoid contamination of food, please respect the following instructions:

- Opening the door for long periods can cause a significant increase of the temperature in the compartments of the appliance.
- Clean regularly surfaces that can come in contact with food and accessible drainage systems.*
- Clean water tanks if they have not been used for 48h; flush the water system connected to a water supply if water has not been drawn for 5 days.



WARNING

Fill with potable water only.



WARNING

Connect to potable water supply only. (Suitable for ice making machine)

ATTENTION! This feature varies depending on the model purchased. Please confirm whether it is applicable according to your product.

Set Up

Before The First Use

The packaging must be undamaged. Check the device for transport damage. Do not connect a damaged device under any circumstances. In case of damage, please contact the supplier.

Remove transport cover

The unit and parts of the interior are protected for transport. You can remove all adhesive tapes on the right and left side of the device door as well as any adhesive residues with cleaning solvent. Remove all adhesive tapes and packaging parts from the interior of the device as well.



CAUTION

Risk of damage!

Set up device

- The ambient temperature affects the power consumption and proper functioning of the device. Therefore, the device should be placed in a well-ventilated and dry room with an ambient temperature corresponding to the climate class for which the device is designed.
- Do not place the device outdoors (e.g., balcony, terrace, garden shed, etc.).
- Do not use sharp knives or pointed objects when opening the device.

Please observe the notes when setting up: "Tips for energy saving".

Remove the device doors

If the unit does not fit through the entry doors or hallways, the unit doors can be unscrewed.

ATTENTION! The unscrewing of the unit doors may only be carried out by customer service.

Notes For Cleaning

- Disconnect the appliance from the power supply before cleaning.
- Dust behind the product and on the floor must be cleaned to improve the cooling effect and energy saving.
- Check the door gasket regularly to make sure there is no debris. Clean the door gasket with a soft cloth dampened with soapy water or diluted detergent.
- The interior of the product should be cleaned regularly to avoid odors. Please turn off the power before cleaning the interior, remove all foods, drinks, shelves, drawers, etc.
- Use a soft cloth or sponge to clean the inside of the product, with two tablespoons of baking soda and a quart of clean water. After cleaning, open the door and let it dry naturally before turning on the power.
- For areas that are difficult to clean inside the product (such as narrow places, gaps or corners), we recommend to wiping them regularly with a soft rag, soft brush, etc., and when necessary, with some tools (such as thin sticks) to ensure no contaminants or bacterial accumulation in these areas.
- Do not use soap, detergent, scrub powder, spray cleaner, etc., as these may cause odors inside the product or contaminate food.

- Clean the door tray, shelves and drawers with a soft cloth dampened with soapy water or diluted detergent. Dry with a soft cloth or dry naturally.
- Wipe the outer surface of the product with a soft cloth dampened with soapy water, detergent, etc., and then wipe dry.
- Do not use hard brushes, scouring pads, wire brushes, abrasives (such as steel wool, acid or alkaline items, which may damage the fridge surface and interior). Boiling water and organic solvents such as benzene may deform or damage plastic parts.
- Do not rinse directly with water or other liquids during cleaning to avoid short circuit or direct electrical insulation after immersion.

Product Overview

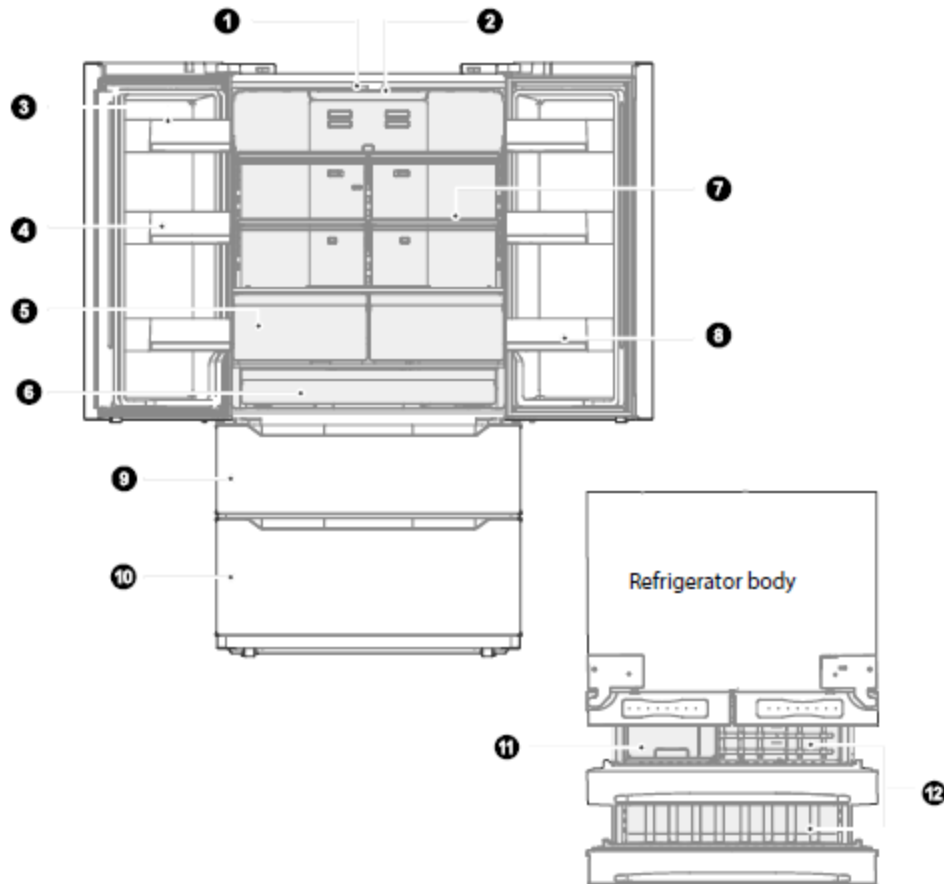

- 1. LED lighting
- 2. Control and display panel
- 3. Dairy bin
- 4. Door tray
- 5. Crisper drawer
- 6. Big drawer
- 7. Shelf

- 8. Door tray
- 9. Upper freezer drawer
- 10. Lower freezer drawer
- 11. Ice storage bin
- 12. Freezer drawer

ATTENTION

The picture above is only for reference. The actual configuration will depend on the physical product or statement by the distributor

Installation

Install Instruction

Finding a suitable location

- This refrigerator is designed to be free standing only, and should not be recessed or built-in.
- The refrigerator should be placed in a well-ventilated indoor place; the ground shall be flat and sturdy.
- Keep away from heat and avoid direct sunlight. Do not place the refrigerator in moist or watery places to prevent rust or reduction of insulating effect.

Dimensions and Clearances

Too small of a distance from adjacent items may result in the degradation of freezing capability and increased electricity costs. The refrigerator on both sides should be placed against the wall with a free distance more than 4.0 inches, and the refrigerator back against the wall distance not more than 3.0 inches.

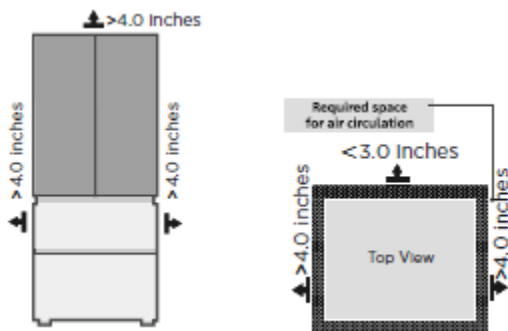

Providing a proper power supply

Check your local power source. This refrigerator requires an AC115 V, 60 Hz power supply. Use a receptacle that accepts the grounding prong. The power cord is equipped with a 3-prong (grounding) plug which mates with a standard 3-prong (grounding) wall outlet to minimize the possibility of electric shock hazard from this refrigerator.

CAUTION

The refrigerator should always be plugged into its own individual electrical outlet which has a voltage rating that matches the rating plate. Never unplug your refrigerator by pulling on the power cord. Always grip the plug firmly and pull straight out from the outlet.

Start to use

- The refrigerator shall stay for half an hour before connecting power when it is firstly started.
- The refrigerator shall run 2 to 3 hours before loading fresh or frozen foods; the refrigerator shall run for more than 4 hours in summer in advance considering that the ambient temperature is high.

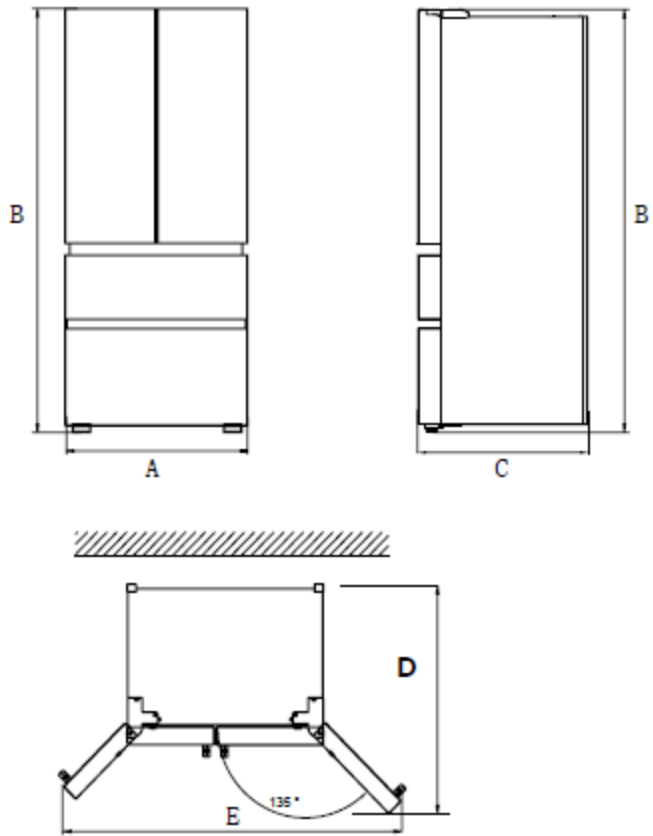

Width	Overall Height	Depth	Depth Doors Open 15°	Width Doors Open 15°
A	B	C	D	E
35.8	69.9	29	41.2	63

Installing the Waterline

Waterline installation kits are available as an additional accessory from your dealer or at a local hardware store.

1. First, shut off the main water supply line and turn the icemaker off.
2. Locate the nearest cold water supply valve.
3. After connecting the water supply to the water valve, turn your main water supply back on and flush several gallons of water to clear the water supply line.

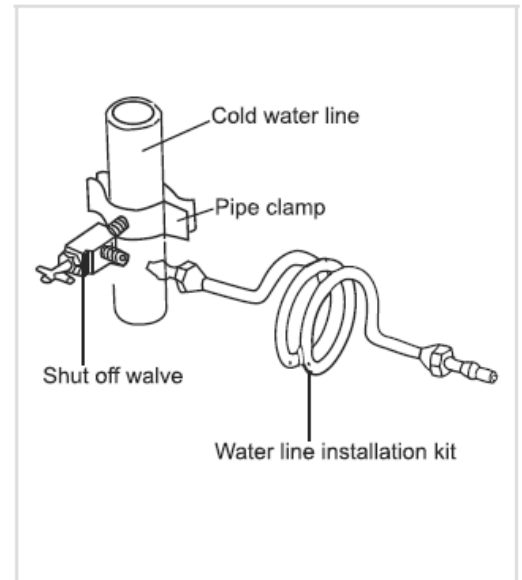

Connecting the Water Line to The Refrigerator

There are several items that you need to purchase to complete this connection. You will find these items sold as a kit at your local hardware store.

1. First, water tubes (supplied) insert into corresponding hole of water connector (supplied).
2. Second, water line installation kit (not included) inserts into another hole of water connector (supplied).
3. Turn water valve on and check for any leakage.

Connecting the Water Line to A Drinkable Water Source

If your water line is not drinkable, please add an external water filter.

If you must repair or disassemble the water line, cut off the plastic tubing to make sure you get a snug, leak-free connection.

ATTENTION

The minimum inlet water pressure: 276kPa. The maximum inlet water pressure: 689kPa. **WARNING:** Connect to potable water supply only. New hose sets supplied with the appliance are to be used and the old hose set should not be reused.

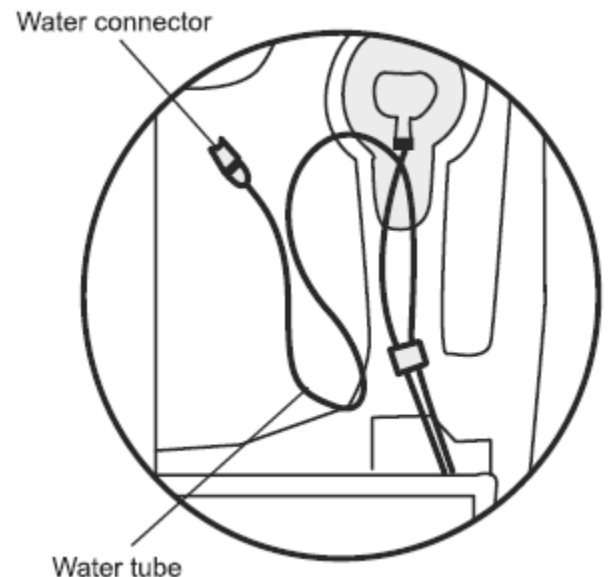

Leveling feet

To avoid vibration, the unit must be leveled. If required, adjust the leveling screws to compensate for the uneven floor. The front should be slightly higher than the rear to aid in door closing. Leveling screws can be turned easily by tipping the cabinet slightly. Turn the leveling screws counterclockwise to raise the unit, clockwise to lower it.

Leveling doors

Tools You Need:

- Pliers

1. Raise the lower door up to the level of the higher door.
2. Insert the supplied fastener-ring by using plier in the gap between the hinge-grommet and the lower hinge. The number of fastener-rings you will need to insert depends on the gap.

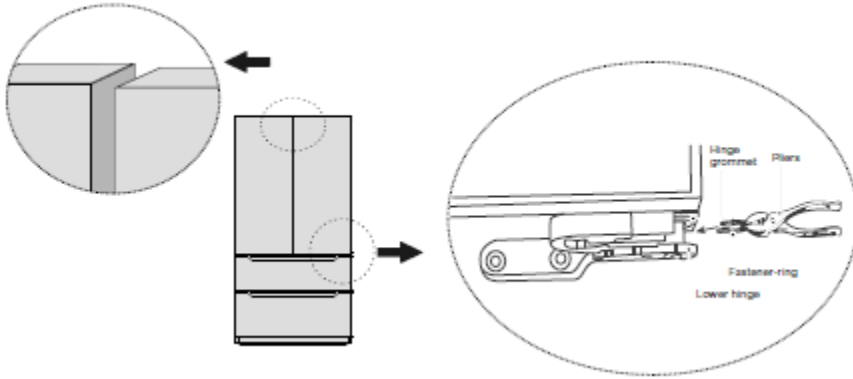

Moving the appliance

1. Remove all food from inside the appliance.
2. Pull the power plug out. Insert and fix it into the power plug hook at the rear or on top of the appliance.
3. Tape parts such as shelves and the door handle to prevent from falling off while moving the appliance.
4. Move the appliance with more than two people carefully. When transporting the appliance over a long distance, keep the appliance upright.
5. After installing the appliance, connect the power plug into a socket outlet to switch on the appliance.

Changing the light

Any replacement or maintenance of the LED lamps is intended to be made by the manufacturer, its service agent or similar qualified person.

Connecting the appliance

After installing the appliance, connect the power plug into a socket outlet.

ATTENTION

After connecting the power supply cord (or plug) to the outlet, wait 2 or 3 hours before you put food into the appliance. If you add food before the appliance has cooled completely, your food may spoil.

Precautions before operation:

Before making changes, the refrigerator must be disconnected from power.
Precautions should be taken to prevent any personal injury.

Tips for energy saving

- Do not place the appliance near cookers, radiators or other heat sources. If the ambient temperature is high, the compressor will run more frequently and for longer, resulting in increased energy

consumption.

- Ensure that there is sufficient ventilation at the base of the appliance, on the sides of the appliance and at the back of the appliance. Never cover ventilation openings.
- Please also observe the spacing dimensions in the chapter "Installation".
- The arrangement of drawers, shelves and racks as shown in the illustration offers the most efficient use of energy and should therefore be retained as far as possible. All drawers and shelves should remain in the appliance to keep the temperature stable and save energy.
- To obtain a larger storage space (e.g. for large refrigerated/frozen goods), the middle drawers can be removed. The top and bottom drawers and shelves should be removed last if necessary.
- An evenly filled refrigerator/freezer compartment contributes to optimal energy use. Therefore, avoid empty or half empty compartments.
- Always allow warm food to cool down before placing it in the refrigerator/freezer. Food that has already cooled down increases energy efficiency.
- Allow frozen food to defrost in the refrigerator. The coldness of the frozen food decreases the energy efficiency.
- Open the door as briefly as necessary to minimize cold loss. Opening the door briefly and closing it properly reduces energy consumption.
- The door seals of your appliance must be perfectly intact so that the doors close properly and energy consumption is not increased unnecessarily.

Operation



Number	Button Name
1	Ice-making button
2	Super cool button
3	Temperature adjusting button of refrigerator room
4	Temperature adjusting button of freezer room
5	Super freeze button
6	Lock/unlock button

Display

1. When the refrigerator is plugged-in and powered, the display screen will totally display for 3 seconds, followed by a ringing bell sound, then the display screen enters the normal display of operation. (If power-on for first time, the default set temperature of the refrigerator room and the freezer room is 41°F / 0°F).
2. It will display the set temperature of both refrigerator and freezer rooms when there is no fault.
3. Under normal circumstances, the display light will go out after 30 seconds in lock state; button operation on display panel would wake up the display screen; if the opening door action wakes up the display screen, the display light would go out immediately when the door is closed; when the "fault code visible" type of fault occurs, the display screen lights up, and will go out after 30 seconds.

ATTENTION

The actual control panel may differ from model to model.

Lock/Unlock

1. In the unlock state, press and hold the lock/unlock button for 3 seconds to enter the lock state, and the buzzer sound rings.
2. In the lock state, press and hold the lock button for 3 seconds to enter the unlock state and the buzzer sound rings.
3. It will enter the lock state if there is no opening door action or any buttons operation within 30 seconds.
4. The alarm sound can be stopped by pressing any one button in lock state, but all other button operations need to be performed in unlock state. If you operate in the lock state, an error beep will be given.

Refrigerator temperature setting

Click the temperature adjusting button of refrigerator room to change the set temperature of refrigerator room. Each time click the button, the set temperature will drop 1°F, when the set temperature reaches 24°F, click the button again, the set temperature will switch to 44°F. The temperature setting will take effect after the display panel is locked.

Freezer temperature setting

Click the temperature adjusting button of freezer room to change the set temperature of freezer room. Each time click the button, the set temperature will drop 1°F, when the set temperature reaches -7°F, click the button again, the set temperature will switch to 7°F. The temperature setting will take effect after the display panel is locked.

Switching between Fahrenheit and Celsius

By pressing “FRIDGE” and “FREEZER” for 3 seconds, Fahrenheit and Celsius conversion can be achieved, and the corresponding icon “°C” and “°F” will be on. This setting takes effect after the display panel is locked.

Mode setting

Press the “SUPER COOL” button to start the super cool function. The refrigerator room is set at 34°F automatically, and the “SUPER” icon shines. When exit the super cool mode, the set temperature of refrigerator room will go back to the set temperature before super cool mode.

Press the “SUPER FRZ” button to start the super freeze function. The freezer room is set at -7°F automatically, and the “SUPER FRZ” icon shines. When exit the super freeze mode, the set temperature of freezer room will go back to the set temperature before super freeze mode.

Press the “ICE MAKER” button, the ice-making function could be switched between on/off. When the “” icon is on, it indicates that the ice-making function is activated.

Fault indication

When the following tips appear on the display screen, it indicates a problem with the refrigerator. Although the refrigerator can still provide cool/freeze functions, the user in the following fault case cannot ensure the normal use of refrigerator.

Fault Code	Fault Description
E1	Temperature sensor failure of refrigerator room
E2	Temperature sensor failure of freezer room
E5	Defrost sensor error
E6	Communication error
E7	Ambient temperature sensor error
EH	Humidity sensor error
EO	Ice maker error
EP	Ice maker sensor fault
EE	Failure of separating ice

ATTENTION

The SUPER FREEZING function is designed to maintain the nutritional value of the food in the freezer by freezing the food in the shortest time. If a large amount of food is frozen at one time, this function can be used. At this time, the freezing speed of freezer compartment is increased, which can quickly freeze the food, effectively lock the nutrition of the food, and facilitate storage.

Tips on storing food

Freezer compartment

- The freezer is designated for the storage of food frozen at very low temperature, long-term storage of frozen food, to produce ice.
- Only use the shelves in the door of the freezer to store frozen food, not for storing hot food designated for freezing.
- Do not put fresh and frozen food next to each other. The frozen food may thaw.
- When freezing fresh food (such as meat, fish or chopped meat), cut them into parts that can be used at the same time.
- Storing frozen food: instructions are usually stated on the packages, which must be followed. If there is no information on the packaging, food should not be stored for longer than three months from the date of purchase.
- When purchasing frozen food, make sure that it is frozen at a suitable temperature and that the packaging is not damaged.
- Frozen food should be kept in suitable packages to retain the quality and should be returned to the freezer compartment as soon as possible.
- If a package of frozen food shows moisture or abnormal bulging, it is probable that it was stored at the wrong temperature and the content is spoiled.
- The storage period for frozen food depends on the room temperature, the thermostat setting, the frequency of opening the door of the freezer, the type of food and the time of transporting the product from the shop to the household. Always follow the instructions printed on the packaging and never exceed the maximum storage time stated on the package.

Cooling compartment

- To reduce moisture and subsequent ice build-up, never put liquid into the refrigerator in unsealed containers. Frost tends to concentrate in the coolest parts of the evaporator. Storing uncovered liquids results in a more frequent need for defrosting.
- Never put warm foods in the refrigerator. Food should first cool down at room temperature and then be placed to ensure adequate air circulation in the refrigerator.
- Foods or food containers should not touch the back wall of the refrigerator because they could freeze to the wall. Do not keep regularly opening the door of the refrigerator.
- Meat and clean fish (packed in a package or plastic foil) can be placed in the refrigerator, which can be used in 1-2 days.
- Fruit and vegetables without packaging can be placed in the part designated for fresh fruit and vegetables.

Recommended Temperature

The optimal temperature setting for food storage:

Fridge: 39 °F (4°C) , Freezer: 0 °F (-18°C)

ATTENTION

The optimal temperature setting of each compartment depends on the ambient temperature. Optimal temperature is based on the ambient temperature of 75 °F (25°C).

Maintenance

Defrosting

The refrigerator is made based on the air-cooling principle and thus has an automatic defrosting function. Frost formed due to change of season or temperature may also be manually removed by disconnection of the appliance from power supply or by wiping with a dry towel.

Cleaning of door tray

According to the direction arrow in the figure below, use both hands to squeeze the tray, and push it upward, then you can take it out.

After removing and washing the tray, you can replace and adjust the height in accordance with your preference.

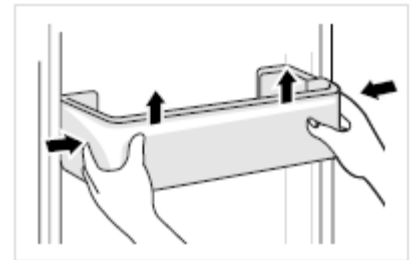

Cleaning of glass shelf

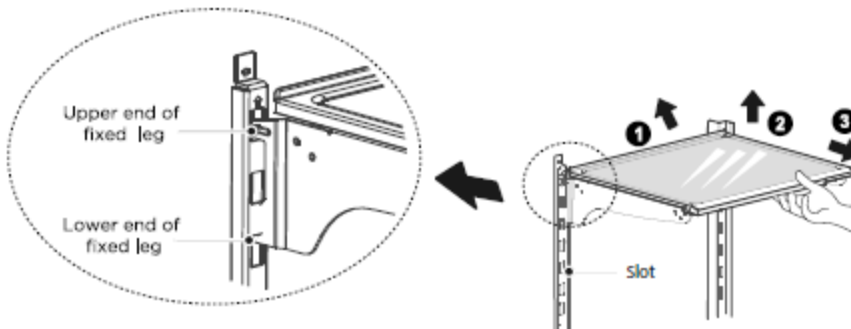

Please dismantle the cantilever shelf according to the arrows shown as above:

1. Please hold the front edge of the shelf and tilt the shelf inwards until the lower end of fixed leg is separated from the slot of supporting iron.
2. Uplift the whole shelf until it cannot rise anymore.
3. Take out the shelf horizontally.

During installation, put the upper end of the fixed leg into one of the upper slots on the supporting iron first and then put the lower end of the fixed leg into the third slot on the lower part of the supporting iron.

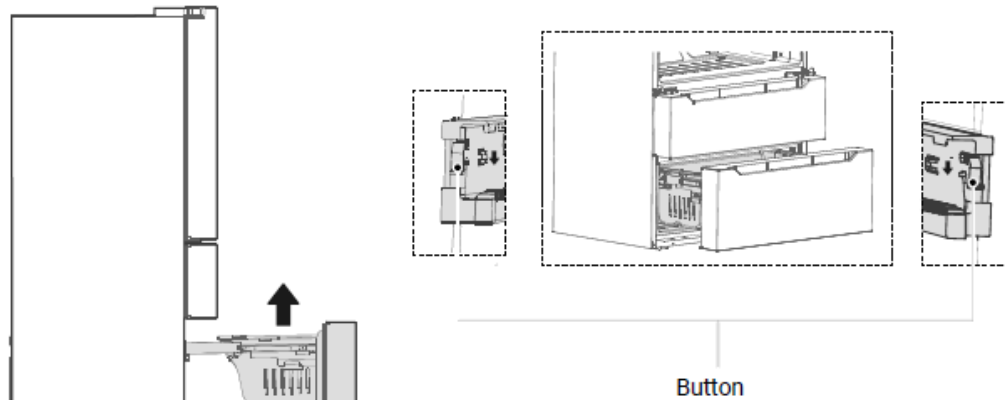

- Pull out the lower freezer drawer to the proper position.
- As shown in the illustration, press the buttons in both slots respectively (must press both sides at the same time), pull out the freezer drawer until it stops.
- Take out the lower drawer as directed by the arrows.
- After cleaning, replace the drawer to original position, then close the lower drawer.
- The button will lock the drawer automatically.

Note: Don't remove the lower freezer drawer if not necessary.

Stop Using

Power failure:

In case of power failure, even if it is in summer, food inside the appliance can be kept for several hours; during the power failure, the times of door opening shall be reduced, and no more fresh food shall be put into the appliance.

Extended Time Of No Use:

The appliance shall be unplugged and then cleaned; then the doors are left open to prevent odor.

Moving:

Before the refrigerator is moved, take all objects inside out, fix the glass partitions, vegetable holder, freezing chamber drawers and etc. with tape, and tighten the leveling feet; close the doors and seal them with tape. During moving, the appliance shall not be upside down, horizontally or be vibrated; the inclination during movement shall not be more than 45°.

Note:

The appliance shall run continuously once it is started. Generally, the operation of the appliance shall not be interrupted; otherwise the service life may be impaired. It is recommended to reduce the frequency of opening the door in case of power failure.

Troubleshooting

Problem	Possible reason
Failed operation	Check whether the appliance is connected to power or whether the plug is in well contact
	Check whether the voltage is too low
	Check whether there is a power failure or partial circuits have tripped
Odor	Odorous foods shall be tightly wrapped
	Check whether there is any rotten food
	Clean the inside of the refrigerator
Long-time operation of the compressor	Long operation of the refrigerator is normal in summer when the ambient temperature is high; it is not suggestible having too much food in the appliance at the same time
	Food shall get cool before being put into the appliance
Light fails to get illuminated	Check whether the refrigerator is connected to power supply and whether the illuminating light is damaged
	Have the light replaced by a specialist
The door cannot be properly closed	The door is stuck by food packages Too much food is placed
	The refrigerator is tilted.
Loud noises	Check whether the floor is level and whether the refrigerator is placed stably
	Check whether accessories are placed at proper locations
Door seal fails to be tight	Remove foreign matters on the door seal
	Heat the door seal and then cool it for restoration (or blow it with an electrical drier or use a hot towel for heating)
Water pan overflows	There is too much food in the chamber or food stored contains too much water, resulting in heavy defrosting
	The doors are not closed properly, resulting in frosting due to entry of air and increased water due to defrosting
Hot housing	Heat distortion of the built-in sensor due to the housing which is normal when housing becomes hot due to high ambient temperature, storage of too much food or shutdown of the compressor is shut down, provide sound ventilation to facilitate heat dissipation
Surface condensation	Condensation on the exterior surfaces and door seals of the refrigerator is normal when the ambient humidity is too high. Just wipe the condensate with a clean towel.
Abnormal noise	Buzz: The compressor may produce buzzes during operation, and the buzzes are loud particularly upon start or stop. This is normal.
	Creaks: Refrigerant flowing inside of the appliance may produce creak, which is normal.



WARRANTY

LIMITED WARRANTY

Koolmore Supply, Inc. extends a limited warranty to the original purchaser, guaranteeing that this Koolmore product is free from manufacturing defects in material or workmanship for one year from the date of purchase.

Should you discover any such defect within the warranty period, Koolmore Supply, Inc., reserves the right to repair or replace the product without charge, or to cover the cost of replacement parts and repair labor needed to correct defects present at the time of purchase or resulting from regular usage, when the appliance has been installed, operated, and maintained as per the instructions provided.

At its sole discretion, Koolmore Supply Inc. may decide to replace the product. In such an event, your replacement appliance will carry the warranty for the remaining term of the original unit's warranty period.

This warranty is valid exclusively to the original purchaser of the product and only applicable within the United States. The warranty commences from the date of original consumer purchase. Proof of the original purchase date will be required to obtain service under this warranty.

Under this limited warranty, your sole and exclusive remedy will be product repair, as outlined above. All services must be provided by a Koolmore-designated service company.

To claim warranty or request repair service:

Email support@koolmore.com. Please include your name, address, phone number, warranty repair request, and a copy of your proof of purchase receipt. Alternatively, visit koolmore.com and use the contact us page. A Koolmore customer service representative will promptly arrange service for your appliance.

We thank you for choosing Koolmore.

WARRANTY EXCLUSIONS

This limited warranty will not cover:

1. Failure of the product to perform during power failures or interruptions, or due to inadequate electrical service.
2. Damage incurred during transportation or handling.
3. Damage caused by accidents, vermin, lightning, winds, fire, floods, or acts of God.
4. Damage resulting from accidents, alterations, misuse, abuse, improper installation, repair, or maintenance. This includes using any external device that alters or converts the voltage or frequency of electricity.
5. Unauthorized product modifications, repairs by unauthorized centers, or use of non-approved replacement parts.
6. Abnormal cleaning and maintenance not aligned with the user's manual.
7. Use of incompatible accessories or components.
8. Any costs associated with repairs or replacements under these excluded circumstances shall be the responsibility of the consumer.

