



SPEC SHEET

KoolMore 24 in. Kitchen Wall Cabinet with Hinged Doors and 2 shelves in Stainless-Steel

Model: KM-WMC-1524-S

FEATURES

- Secure Locking Doors: Protects valuables in busy settings.
- Durable Construction: 20-gauge 304 stainless steel resists corrosion and wear.
- Slanted Roof: Reduces dust buildup and simplifies cleaning.
- Ample Storage: Two shelves, each holding 181.5 lbs., for versatile use.
- Wall Mounting: Space-saving design with secure bracket included.
- Smooth Hinged Doors: Easy, reliable access with secure closure.
- Ventilation Slits: Ensures airflow to prevent moisture buildup.
- Easy to Clean: Smooth stainless steel for quick sanitizing.
- Robust Brackets: Sturdy mounting for stability when loaded.
- NSF Certified & Warranty: Meets safety standards with a 1-year parts/labor warranty.



CLOSE UP IMAGES



TECHNICAL SPECS

Dimensions

Length	24
Width	15
Height	33
Depth Excluding Handles	13.56
Depth Including Handles	14.4
Depth Less Door	13.4
Depth With Door Open 90 Degrees	23.8

Features & Materials

Weightlbs	36.42
Hinge Location	Towards Top and Bottom
Number Of Shelves	2
Individual Shelf Capacity	181.5 lb
Exterior Material	Stainless-Steel 304
Gauge Of Stainless Steel	20
Mounting Bracket Type	Wall Mounted, Included
Door Style	Swing
Safety Lock	Yes
Vent Type	Slits in Cabinet
Color	Brushed Stainless-Steel
Certifications	NSF Certified for Sanitation

Plan View

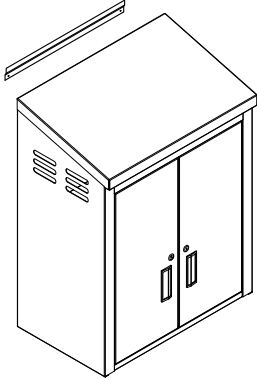
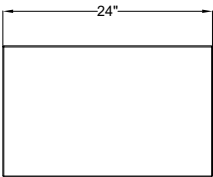
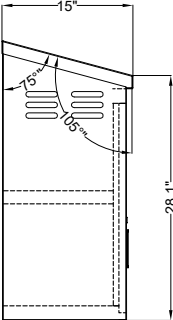
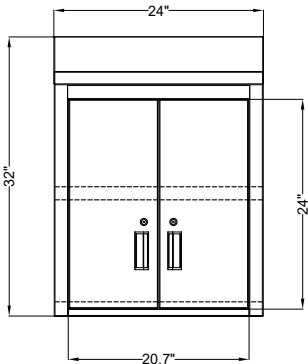

CERTIFICATIONS



706 Eastern Parkway STE 1G, Brooklyn NY 11213
718-576-6342
info@koolmore.com